

PROJECT FACT SHEET

Parker St - Fort St., Omaha NH-75-2(181); C.N. 22647

September 2022 Update

***Red Text Denotes Updated Information*

Identified as **Parker St - Fort St., Omaha**, the proposed project would improve approximately 2.47 miles of U.S. Highway 75, as well as repair and paint several structures located along US-75.

The proposed project would include structure numbers:

- S075 09137 - Hamilton St. Bridge over US-75
- S075 09169 - Parker St. Bridge over US-75
- S075 09202 - Lake St. Bridge over US-75
- S075 09233 - Binney St. Bridge over US-75
- S075 09255 - Bristol St. Bridge over US-75
- S075 09280 - Manderson-Pratt Pedestrian Bridge over US-75
- S075 09302 - Sprague St. Bridge over US-75
- S075 09327 - Ames Ave. Bridge over US-75
- S075 09341 - Westbound Storz to Southbound US-75 Ramp bridge over Northbound US-75
- S075 09354A - Westbound Storz to Southbound US-75 Ramp bridge over Sorensen Pkwy.

Construction on the roadway and structures listed above would not occur all at the same time and would be phased to avoid conflicts with designated detours.

The pedestrian detour for the Hamilton Street bridge closure was previously shown to utilize 25th Street, Parker Street and 30th Street; it would now utilize 24th Street, Cuming Street and 30th Street. An ADA accessible shuttle would also be available from 6:00 AM to 8:00 PM.

Pedestrian detours were previously shown at the Parker Street, Binney Street, Bristol Street and Sprague Street bridges. These detours are no longer needed as approach work would now occur in phases, allowing one sidewalk to remain open at all times.

The Lake Street and Ames Street bridge pedestrian detours would remain the same as previously shown, with work occurring in phases, allowing one sidewalk to remain open at all times.

Please see the following pages for new or updated closure/detour maps.

Additional information regarding the proposed project and all closure/detour maps will be made available on the NDOT website at ndot.info/22647.

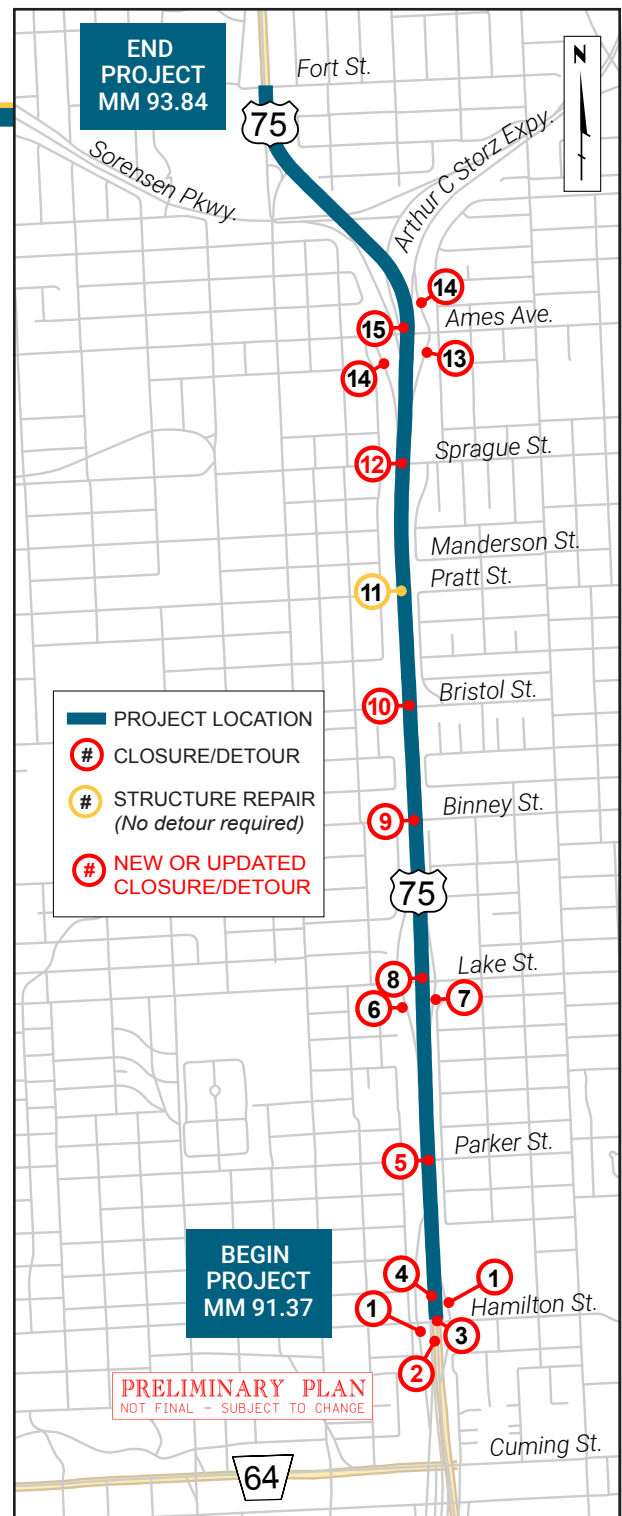

New or Updated Closure/Detour Maps

LEGEND

- DRIVING DETOUR
- - - PEDESTRIAN DETOUR
- XXXX CLOSURE

PRELIMINARY PLAN
NOT FINAL - SUBJECT TO CHANGE

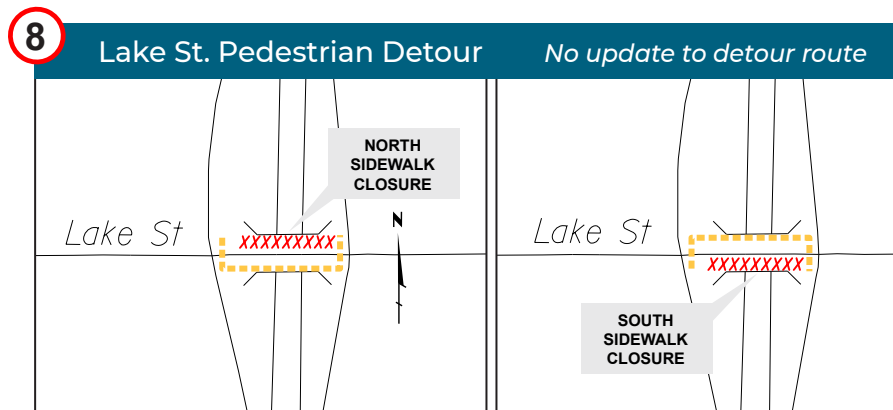
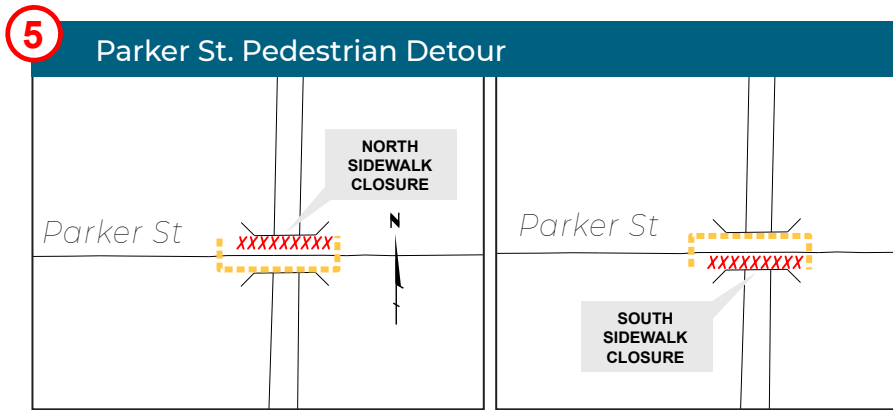
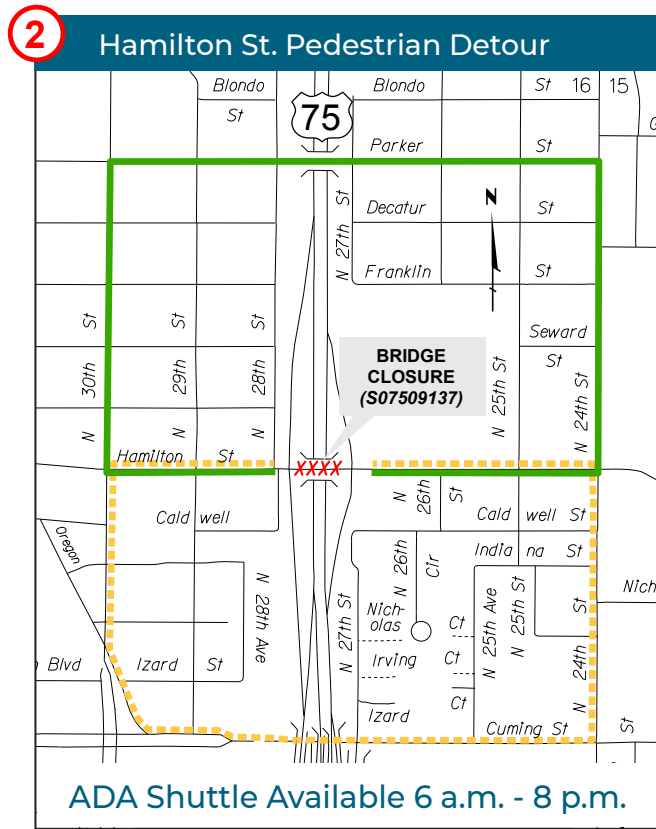

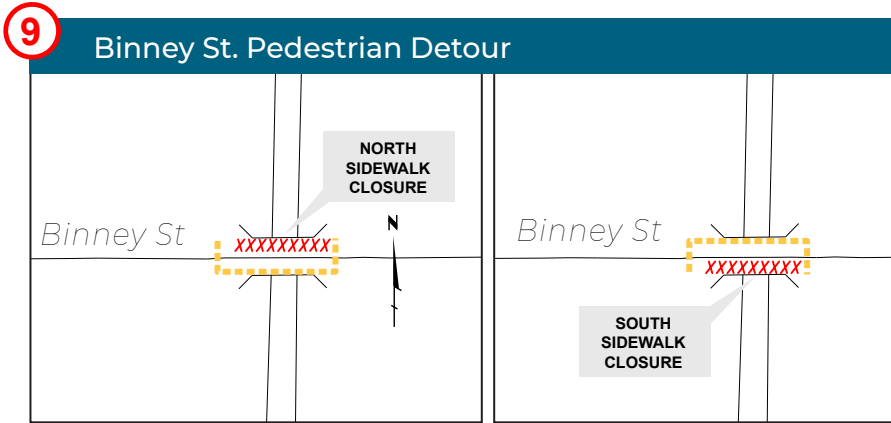

LEGEND

- DRIVING DETOUR
- - - PEDESTRIAN DETOUR
- XXXXXXXXXX CLOSURE

PRELIMINARY PLAN
NOT FINAL - SUBJECT TO CHANGE

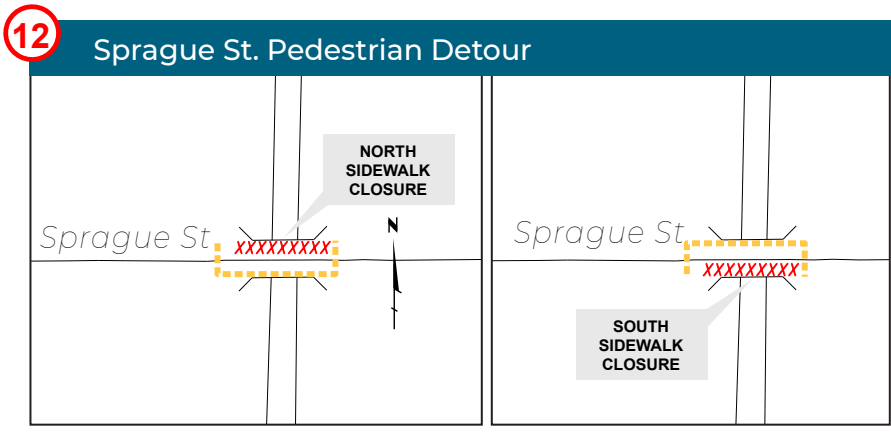
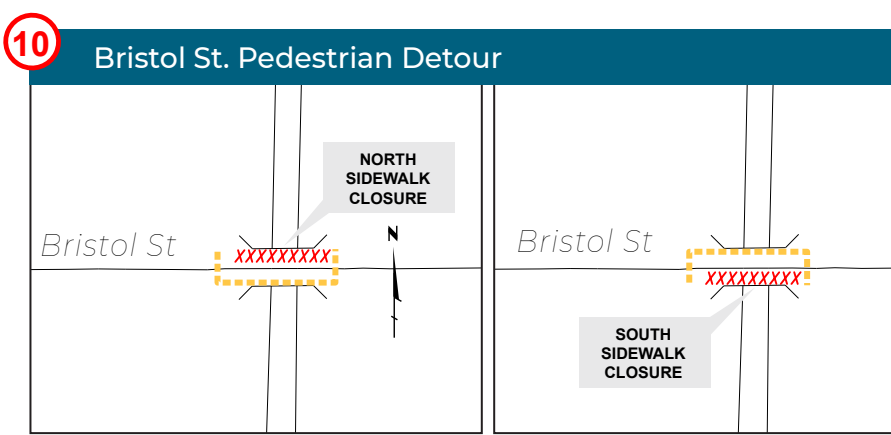

Send comments/questions to:
 Sarah Fisher
 NDOT Public Involvement
 sarah.fisher@nebraska.gov
 402-479-3832
 1500 Highway 2
 PO Box 94759
 Lincoln, NE 68509-4759

For more information:
 Tim Weander
 NDOT District 2 Engineer
 tim.weander@nebraska.gov
 402-595-2534
 4425 South 108th St.
 PO Box 45461
 Omaha, NE 68145-0461

