

NEBRASKA DEPARTMENT OF ROADS NOTICE OF HIGHWAY PUBLIC INFORMATION MEETING

Thur., July 18, 2013; 4:00 – 6:00 PM

Information Open House Public Meeting

NDOR District 2 Operation Ctr., 2nd Floor Conference Rm., 4425 South 108th St., Omaha, NE

S-80-9(1189) EB I-80: 126th St. to 96th St.; CN 22151

S-680-9(1190) NB I-680: N of Center thru Pacific; CN 22162

The Nebraska Department of Roads (NDOR) will hold a public information open house regarding two proposed lane expansion projects of Interstate 80 (I-80) and Interstate 680 (I-680) in the city of Omaha, Douglas County. The meeting will be held at the NDOR District Two Operations Center, Second Floor Conference Room, 4425 South 108th Street, Omaha, on Thursday, June 18, 2013, 4:00-6:00 P.M.

Identified as **EB I-80: 126th St. to 96th St.**, the proposed I-80 project would add an eastbound (EB) lane between 126th Street and 96th Street. The I-680 project, referred to as **NB I-680: N of Center thru Pacific**, would add a northbound (NB) lane between the Center Street and Pacific Street exits.

Construction could start as early as spring of 2014 and the project completed by the end of 2014. The proposed construction would be constructed "under traffic" by diverting interstate traffic toward the center lanes. Temporary delays or slowdowns in the construction area may occur. All exit ramps would be open during construction. Some on-loops and on-ramps in the project area would be closed for a set number of days to facilitate construction. Details will be available at the meeting.

The proposed projects would be built within the existing right-of-way (ROW) and require no new property. Minimal wetland impacts are anticipated. A noise study has been completed for the area and details will be available at the meeting.

The proposed I-80 project would add an auxiliary lane by allowing the 126th Street on-loop to connect to I-80 eastbound as the fourth lane. This auxiliary would be extended and would have to exit at the local access road to "L" Street. A third mainline lane would be added to I-80 eastbound beginning just south of "Q" Street and connecting to the third lane added by the existing eastbound "L" Street on-loop access to I-80. This access to I-80 mainline for "L" Street eastbound traffic would be closed. This EB on-loop traffic from "L" Street must use the new and expanded local access road constructed north of "L" Street. The current signing for access to I-680 NB and I-80 EB on "L" Street will remain as it is today.

The proposed I-680 project would eliminate the existing right lane drop just north of the West Center Road and extend this fourth (4th) lane under Pacific Street

Bridge until connecting to the fourth lane currently added by the Northbound on ramp from Pacific Street. This on-ramp from Pacific Street would be rebuilt and extended across the Big Pappio Creek Bridge before merging into the fourth NB I-680 lane. The on-ramp from Pacific to NB I-680 would be closed to allow for reconstruction.

The bike path under the Big Pappio Bridge would be closed during the construction of the pier footings. The Bike path would be kept open during the rest of the bridge work. The on-ramp northbound from West Center Road would be constructed to connect to I-680 as an auxiliary (5th) lane that must exit at Pacific Street maintaining a two-lane exit.

The public meeting is being held to provide information regarding the project, currently in the design phase, and receive input. All interested persons are invited to attend and present relevant comments and questions. Design information will be displayed and personnel from NDOR will be present to answer questions and receive comments. The information "open house" format allows the public to come at any time during the advertised hours, gather pertinent information about the project, speak one-on-one with project personnel, and leave as they wish.

NDOR will make every reasonable accommodation to provide an accessible meeting facility for all persons. Appropriate provisions for the hearing and visually challenged or persons with Limited English Proficiency (LEP) will be made if the Department is notified by July 8, 2013. Notification should be submitted to: Greg Weinert, Public Hearings Officer, Nebraska Department of Roads, P.O. Box 94759, Lincoln, NE 68509-4759; greg.weinert@nebraska.gov; voice telephone (402)479-4871, TDD telephone (402)479-3834, Fax (402)479-3989.

Information regarding the proposed project will be available following the meeting on the NDOR website, www.transportation.nebraska.gov/projects/; click on the "Omaha-I-80 EB-126th to 96th" or "Omaha-I-680 NB-N of Center through Pacific" link. For further details, contact Tim Weander, NDOR District 2 Engineer, (402)595-2534, tim.weander@nebraska.gov.

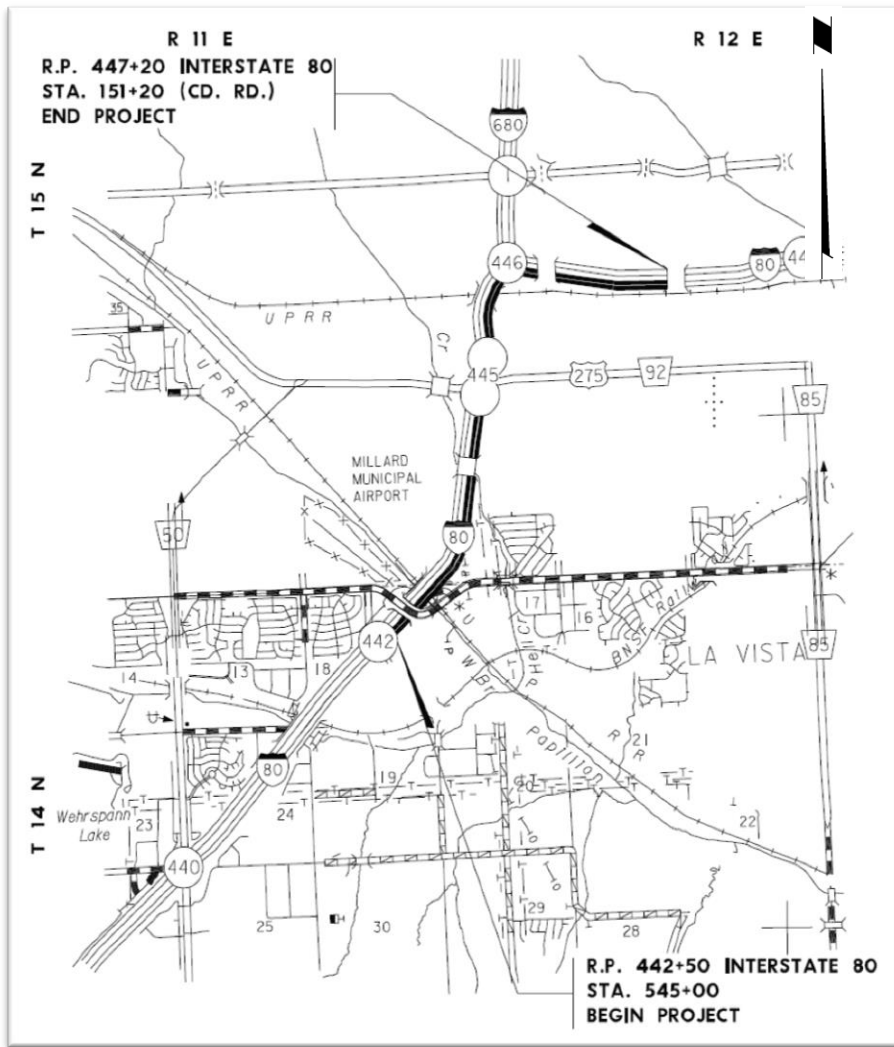

**S-80-9(1189); CN 22151
EB I-80:
126th St.
to 96th St.**

**S-680-9(1190); CN 22162
NB I-680:
N of Center
thru Pacific**

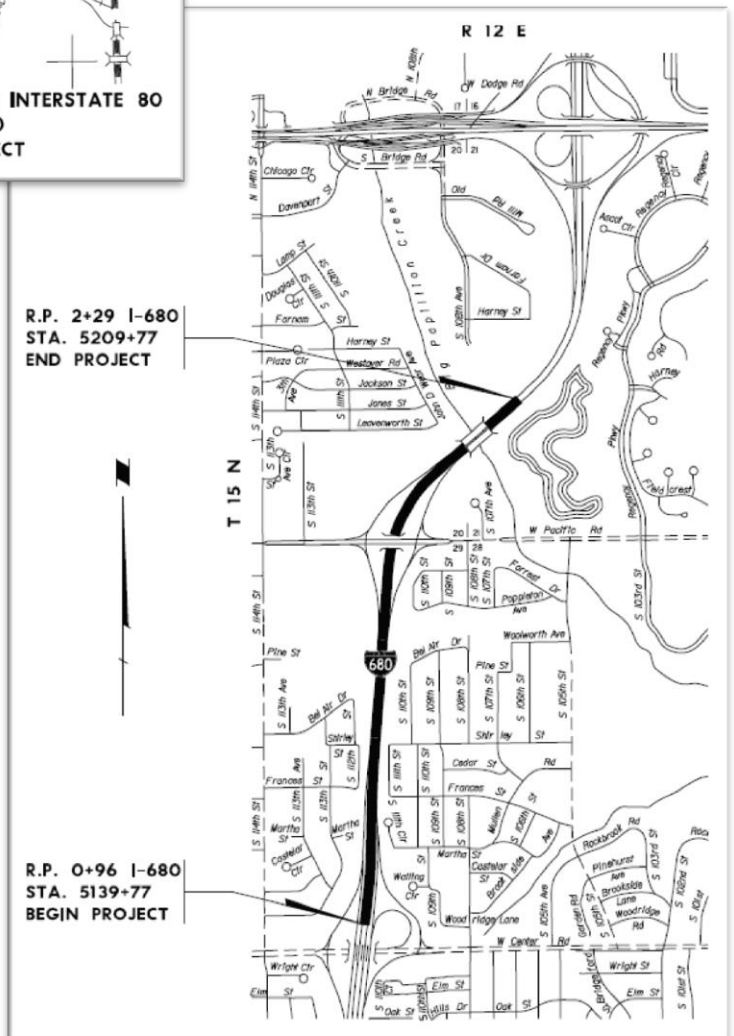

PRELIMINARY PLAN
NOT FINAL - SUBJECT TO CHANGE