

# NEBRASKA

Good Life. Great Journey.

DEPARTMENT OF TRANSPORTATION



June 23, 2022

Pete Ricketts, Governor

Ms. Andre Aman, State Airfield Manager  
Harvard State Airfield  
P.O. Box 82088  
Lincoln, NE 68501

Subject: Harvard State Airfield  
Harvard, Nebraska  
PCI Survey

Dear Ms. Aman:

On May 3<sup>rd</sup>, 2022, representatives from the Nebraska Department of Transportation Aeronautics Division (NDOT) visited your airport and conducted a survey of the operational area pavement.

Enclosed is a report containing information on the inspection results. The report is based on the inspector's brief observations, and should not be used as the basis of actual construction or repairs without the consultation and advice of a registered Professional Engineer.

The partial parallel taxiway's condition has worsened since 2019 and now scores as 'Very Poor;' similarly, the north connector's rating has fallen from Satisfactory to Fair. The apron's apparent improvement from Poor to Fair is more a reflection of the larger number of samples surveyed, and a recent sweeping of FOD, than a genuine improvement in condition.

The entire airport is to be rehabilitated by 2025 (except for the new hangar taxilanes, T3-1), starting with the partial parallel taxiway in 2024.

We encourage you to keep the pavement on a maintenance schedule to preserve the pavement for as many years as possible.

Please feel free to contact this office if you have any questions with regard to the enclosed report, or if you would like to request assistance for any future needs.

Sincerely,  
Nebraska Department of Transportation

**Dave Lehnert**  
Liaison Technician II  
Aeronautics Division  
Nebraska Department of Transportation  
OFFICE 402-471-7928

[dave.lehnert@nebraska.gov](mailto:dave.lehnert@nebraska.gov)

John R. Selmer, P.E., Director  
Cc: Tim Kujawa, Airport Manager

**MAILING ADDRESS**  
PO Box 94759  
Lincoln, NE 68509-4759

**PHYSICAL ADDRESS**  
1500 Highway 2  
Lincoln, NE 68502

**PHONE** 402-471-4567  
**EMAIL** [NDOT.ContactUs@nebraska.gov](mailto:NDOT.ContactUs@nebraska.gov)

[dot.nebraska.gov](http://dot.nebraska.gov)

**Aeronautics Division**  
3431 Aviation Road, Ste. 150  
Lincoln, NE 68524-1800  
**OFFICE** 402-471-2371  
**FAX** 402-471-2906

**Navigational Aids Office**  
Kearney Municipal Airport  
5065 Airport Road  
Kearney, NE 68847  
**OFFICE** 308-865-5696  
**FAX** 308-865-5697

Harvard State Airfield

## SUGGESTED MAINTENANCE, 2023-2025

The partial parallel taxiway is to be rehabilitated in 2024; remaining pavement (apron, connectors, runway) is scheduled for rehab in 2025. As these projects are completed, budget dedicated to pavement maintenance can drop. In the meantime, perform only emergency and stopgap pavement repairs.

The table below includes estimated costs for annual maintenance plus reserves for future projects.

(Concrete maintenance includes crack & joint sealing, patching, and panel replacement.)

(Asphalt maintenance includes crack sealing, patching, and full-depth repair.)

<i>Annual Maintenance / Future Projects</i>	Year	Est. Cost
Concrete, Asphalt pavement maintenance <b>as needed</b> / <i>Rehab N. Parallel Txwy, Apron &amp; Txwys, Rwy</i>	2023	\$280,400
Concrete, Asphalt pavement maintenance <b>as needed</b> / <i>Rehab Apron &amp; Taxiways, Runway</i>	2024	\$276,000
Concrete, Asphalt pavement maintenance <b>as needed</b> / <i>Rehab Apron &amp; Taxiways, Runway</i>	2025	\$259,600

Estimated three year total

\$816,000

(The above chart is offered only as a general guideline under ideal funding conditions; NDA understands local economies may not have the resources for the projected costs, and emphasizes the "**as needed**" nature of the suggested maintenance).

Please read carefully the "Pavement Maintenance Recommendations" of FAA Regional Paving Engineer, Doug Johnson, listed below;

It is the responsibility of the owners of the airport to:

Perform regular general maintenance activities and to immediately correct any situation that poses a safety hazard.

To prolong pavement life the following strategies should be implemented:

1. Conduct an aggressive campaign against weed growth. Vegetation growing in pavement cracks is very destructive and significantly increases the rate of pavement deterioration.
2. Implement a regular crack sealing and joint sealing program. Keeping water and debris out of the pavement system is a proven method for extending the life of the pavement system.
3. Closely monitor pavement loads. In addition to aircraft loads pay particular attention to: farming, construction, maintenance & snow removal and fueling equipment to make sure that they are only operating on pavements designed to accommodate these loads. Note this may require that you limit the size of snow removal equipment. Failure to restrict heavy loads to appropriate areas may result in the premature failure of airport pavements.
4. Maintain positive drainage away from pavements. Ensure that water can drain away from pavements and not held at the edge of pavements by allowing dirt to build up at the edge of pavements. Also make sure that edge drain outlets are clear and any drainage structures are clear.

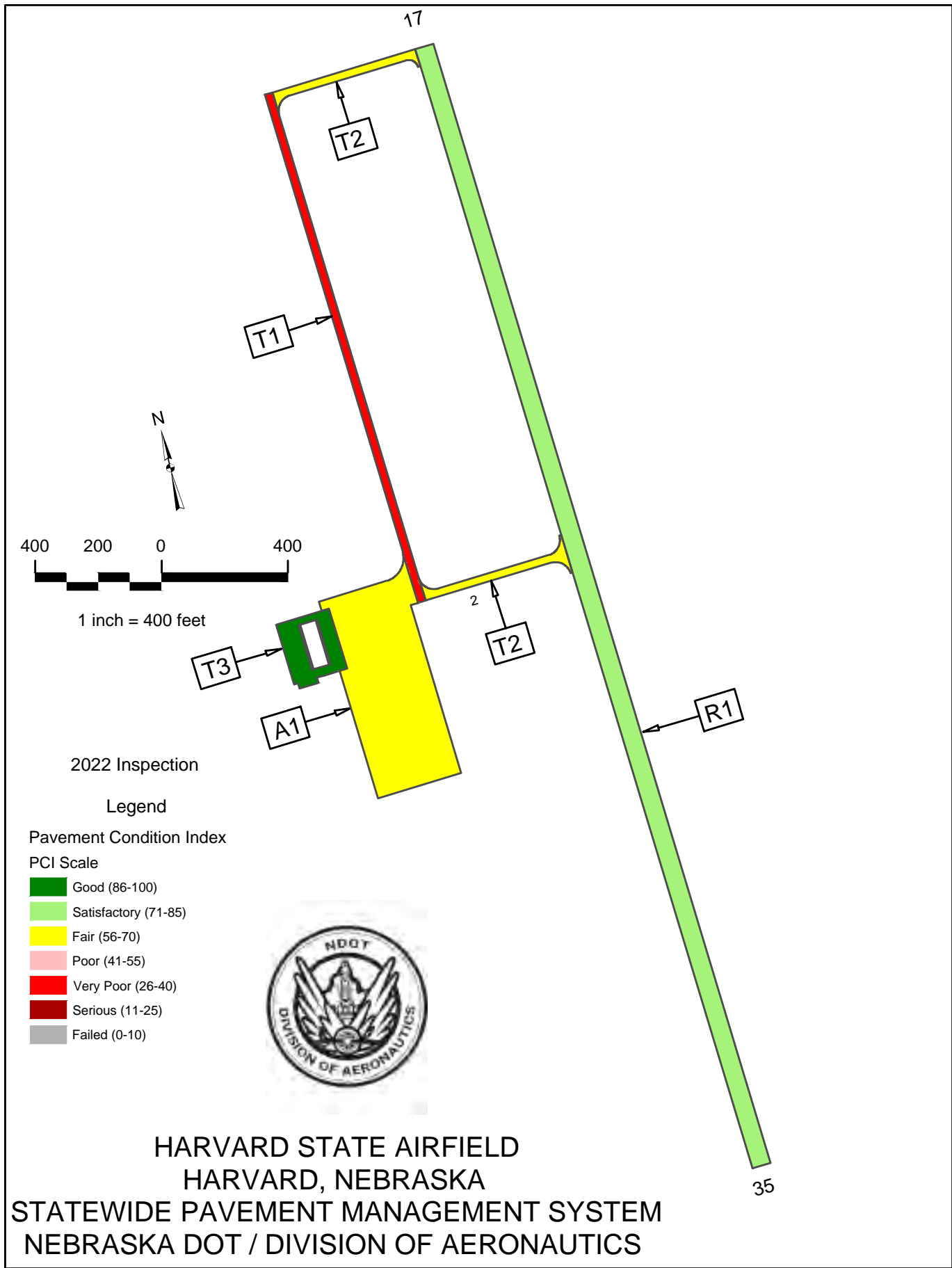

*Pavement Database: NDOT\_PAVER\_2021\_4\_1\_**NetworkId: 08K*

Branch ID	Section ID	Last Const. Date	Surface	Use	Rank	Lanes	True Area (SqFt)	Last Inspection Date	Age At Inspection	PCI
HVDA1	01	7/1/1942	PCC	APRON	P	0	174,840.00	5/3/2022	80	63
HVDR1	01	7/16/1999	APC	RUNWAY	P	0	222,000.00	5/3/2022	23	73
HVDT1	01	7/1/1942	PCC	TAXIWAY	S	0	42,000.00	5/3/2022	80	39
HVDT2	01	7/16/1999	AAC	TAXIWAY	S	0	12,748.00	5/3/2022	23	59
HVDT2	02	7/16/1999	AAC	TAXIWAY	P	0	14,150.00	5/3/2022	23	64
HVDT3	01	8/6/2021	PCC	TAXIWAY	S	0	26,759.00	5/3/2022	1	98

---

*Pavement Database: NDOT\_PAVER\_2021\_4\_1\_*

---

Age Category	Average Age at Inspection	Total Area (SqFt)	Number of Sections	Arithmetic Average PCI	Standard Deviation PCI	Weighted Average PCI
00-02	1	26,759.00	1	98.00	0.00	98.00
21-25	23	248,898.00	3	65.33	5.79	71.77
50+	80	216,840.00	2	51.00	12.00	58.35
ALL	38	492,497.00	6	66.00	17.63	67.29

## Re-Inspection Report

NDOT\_PAVER\_2021\_4\_1\_

Generated Date 6/15/2022

Page 1 of 16

**Network:** 08K **Name:** HARVARD

**Branch:** HVDA1 **Name:** APRON **Use:** APRON **Area:** 174,840 SqFt

**Section:** 01 of 1 **From:** APRON1 END **To:** TW1 **Last Const.:** 7/1/1942

**Surface:** PCC **Family:** NDA-PCC-APRON-C **Zone:** E **Category:** D **Rank:** P

**Area:** 174,840 SqFt **Length:** 650 Ft **Width:** 275 Ft

**Slabs:** 933 **Slab Length:** 15 Ft **Slab Width:** 13 Ft **Joint Length:** 25,127 Ft

**Shoulder:** **Street Type:** **Grade:** 0 **Lanes:** 0

**Section Comments:** 47 SUs

**Last Insp. Date:** 5/3/2022 **Total Samples:** 47 **Surveyed:** 32

**Conditions:** PCI: 63

**Inspection Comments:**

**Sample Number:** 001 **Type:** R **Area:** 20.00 Slabs **PCI:** 44

**Sample Comments:**

63	LINEAR CR	L	1.00	Slabs
63	LINEAR CR	L	1.00	Slabs
63	LINEAR CR	L	1.00	Slabs
63	LINEAR CR	M	1.00	Slabs
63	LINEAR CR	M	1.00	Slabs
63	LINEAR CR	M	1.00	Slabs
66	SMALL PATCH	M	1.00	Slabs
72	SHAT. SLAB	L	1.00	Slabs
72	SHAT. SLAB	L	1.00	Slabs
72	SHAT. SLAB	M	1.00	Slabs
75	CORNER SPALL	H	1.00	Slabs

**Sample Number:** 002 **Type:** R **Area:** 20.00 Slabs **PCI:** 87

**Sample Comments:**

63	LINEAR CR	L	1.00	Slabs
63	LINEAR CR	L	1.00	Slabs
65	JT SEAL DMG	M	20.00	Slabs

**Sample Number:** 004 **Type:** R **Area:** 12.00 Slabs **PCI:** 72

**Sample Comments:**

62	CORNER BREAK	L	1.00	Slabs
62	CORNER BREAK	M	1.00	Slabs
63	LINEAR CR	M	1.00	Slabs

**Sample Number:** 006 **Type:** R **Area:** 20.00 Slabs **PCI:** 67

**Sample Comments:**

63	LINEAR CR	L	1.00	Slabs
63	LINEAR CR	M	1.00	Slabs
66	SMALL PATCH	M	1.00	Slabs
74	JOINT SPALL	L	1.00	Slabs
74	JOINT SPALL	M	1.00	Slabs
75	CORNER SPALL	L	1.00	Slabs
75	CORNER SPALL	L	1.00	Slabs
75	CORNER SPALL	M	1.00	Slabs
75	CORNER SPALL	M	1.00	Slabs
75	CORNER SPALL	M	1.00	Slabs

**Sample Number:** 007 **Type:** R **Area:** 20.00 Slabs **PCI:** 91

**Sample Comments:**

65	JT SEAL DMG	L	20.00	Slabs
74	JOINT SPALL	L	1.00	Slabs
74	JOINT SPALL	L	1.00	Slabs
75	CORNER SPALL	M	1.00	Slabs

**Sample Number:** 009 **Type:** R **Area:** 20.00 Slabs **PCI:** 52

**Sample Comments:**

63	LINEAR CR	L	1.00	Slabs
63	LINEAR CR	M	1.00	Slabs
63	LINEAR CR	M	1.00	Slabs
63	LINEAR CR	M	1.00	Slabs
66	SMALL PATCH	L	1.00	Slabs
67	LARGE PATCH	L	1.00	Slabs
70	SCALING	L	1.00	Slabs
70	SCALING	L	1.00	Slabs
70	SCALING	L	1.00	Slabs
70	SCALING	L	1.00	Slabs
70	SCALING	L	1.00	Slabs
70	SCALING	L	1.00	Slabs
70	SCALING	L	1.00	Slabs
70	SCALING	L	1.00	Slabs
70	SCALING	L	1.00	Slabs
70	SCALING	L	1.00	Slabs
70	SCALING	M	1.00	Slabs
74	JOINT SPALL	M	1.00	Slabs
75	CORNER SPALL	M	1.00	Slabs

---

**Sample Number:** 011      **Type:** R      **Area:** 20.00 Slabs      **PCI:** 95

**Sample Comments:**

74	JOINT SPALL	L	1.00	Slabs
74	JOINT SPALL	L	1.00	Slabs
74	JOINT SPALL	L	1.00	Slabs

---

**Sample Number:** 012      **Type:** R      **Area:** 20.00 Slabs      **PCI:** 95

**Sample Comments:**

63	LINEAR CR	L	1.00	Slabs
----	-----------	---	------	-------

---

**Sample Number:** 014      **Type:** R      **Area:** 20.00 Slabs      **PCI:** 41

**Sample Comments:**

63	LINEAR CR	L	1.00	Slabs
63	LINEAR CR	L	1.00	Slabs
63	LINEAR CR	L	1.00	Slabs
63	LINEAR CR	M	1.00	Slabs
63	LINEAR CR	M	1.00	Slabs
63	LINEAR CR	H	1.00	Slabs
66	SMALL PATCH	L	1.00	Slabs
66	SMALL PATCH	L	1.00	Slabs
66	SMALL PATCH	L	1.00	Slabs
66	SMALL PATCH	L	1.00	Slabs
66	SMALL PATCH	M	1.00	Slabs
70	SCALING	L	1.00	Slabs
70	SCALING	L	1.00	Slabs
70	SCALING	L	1.00	Slabs
70	SCALING	L	1.00	Slabs
70	SCALING	L	1.00	Slabs
70	SCALING	L	1.00	Slabs
72	SHAT. SLAB	L	1.00	Slabs
72	SHAT. SLAB	M	1.00	Slabs
75	CORNER SPALL	M	1.00	Slabs
75	CORNER SPALL	M	1.00	Slabs
75	CORNER SPALL	M	1.00	Slabs

---

**Sample Number:** 015      **Type:** R      **Area:** 20.00 Slabs      **PCI:** 57

**Sample Comments:**

63	LINEAR CR	L	1.00	Slabs
63	LINEAR CR	M	1.00	Slabs
63	LINEAR CR	M	1.00	Slabs
65	JT SEAL DMG	M	20.00	Slabs
66	SMALL PATCH	L	1.00	Slabs
66	SMALL PATCH	L	1.00	Slabs
66	SMALL PATCH	L	1.00	Slabs
74	JOINT SPALL	M	1.00	Slabs
75	CORNER SPALL	L	1.00	Slabs
75	CORNER SPALL	L	1.00	Slabs
75	CORNER SPALL	M	1.00	Slabs





66	SMALL PATCH	L	1.00	Slabs
66	SMALL PATCH	L	1.00	Slabs
66	SMALL PATCH	L	1.00	Slabs
66	SMALL PATCH	M	1.00	Slabs
66	SMALL PATCH	M	1.00	Slabs
70	SCALING	L	1.00	Slabs
74	JOINT SPALL	M	1.00	Slabs
74	JOINT SPALL	M	1.00	Slabs
75	CORNER SPALL	L	1.00	Slabs
75	CORNER SPALL	M	1.00	Slabs
75	CORNER SPALL	M	1.00	Slabs
75	CORNER SPALL	M	1.00	Slabs
75	CORNER SPALL	M	1.00	Slabs

---

**Sample Number:** 025      **Type:** R      **Area:** 20.00 Slabs      **PCI:** 28

**Sample Comments:**

63	LINEAR CR	L	1.00	Slabs
63	LINEAR CR	M	1.00	Slabs
63	LINEAR CR	M	1.00	Slabs
63	LINEAR CR	M	1.00	Slabs
63	LINEAR CR	M	1.00	Slabs
63	LINEAR CR	M	1.00	Slabs
63	LINEAR CR	M	1.00	Slabs
63	LINEAR CR	M	1.00	Slabs
63	LINEAR CR	M	1.00	Slabs
63	LINEAR CR	M	1.00	Slabs
63	LINEAR CR	M	1.00	Slabs
64	DURABIL. CR	M	1.00	Slabs
64	DURABIL. CR	M	1.00	Slabs
64	DURABIL. CR	M	1.00	Slabs
66	SMALL PATCH	L	1.00	Slabs
66	SMALL PATCH	L	1.00	Slabs
66	SMALL PATCH	L	1.00	Slabs
66	SMALL PATCH	L	1.00	Slabs
66	SMALL PATCH	L	1.00	Slabs
66	SMALL PATCH	L	1.00	Slabs
66	SMALL PATCH	M	1.00	Slabs
66	SMALL PATCH	M	1.00	Slabs
74	JOINT SPALL	L	1.00	Slabs
74	JOINT SPALL	M	1.00	Slabs
74	JOINT SPALL	M	1.00	Slabs
75	CORNER SPALL	H	1.00	Slabs

---

**Sample Number:** 026      **Type:** R      **Area:** 20.00 Slabs      **PCI:** 66

**Sample Comments:**

66	SMALL PATCH	L	1.00	Slabs
70	SCALING	L	1.00	Slabs
70	SCALING	H	1.00	Slabs
74	JOINT SPALL	M	1.00	Slabs
74	JOINT SPALL	H	1.00	Slabs
75	CORNER SPALL	H	1.00	Slabs

---

**Sample Number:** 027      **Type:** R      **Area:** 20.00 Slabs      **PCI:** 92

**Sample Comments:**

66	SMALL PATCH	L	1.00	Slabs
74	JOINT SPALL	L	1.00	Slabs
74	JOINT SPALL	L	1.00	Slabs
74	JOINT SPALL	M	1.00	Slabs

---

**Sample Number:** 028      **Type:** R      **Area:** 20.00 Slabs      **PCI:** 80

**Sample Comments:**

66	SMALL PATCH	L	1.00	Slabs
66	SMALL PATCH	M	1.00	Slabs
74	JOINT SPALL	M	1.00	Slabs
74	JOINT SPALL	M	1.00	Slabs
74	JOINT SPALL	M	1.00	Slabs
74	JOINT SPALL	M	1.00	Slabs
75	CORNER SPALL	L	1.00	Slabs

---

**Sample Number:** 030      **Type:** R      **Area:** 20.00 Slabs      **PCI:** 50

**Sample Comments:**

63	LINEAR CR	L	1.00	Slabs
63	LINEAR CR	M	1.00	Slabs
63	LINEAR CR	M	1.00	Slabs
66	SMALL PATCH	L	1.00	Slabs
66	SMALL PATCH	L	1.00	Slabs
66	SMALL PATCH	L	1.00	Slabs
66	SMALL PATCH	L	1.00	Slabs
66	SMALL PATCH	M	1.00	Slabs
66	SMALL PATCH	M	1.00	Slabs
67	LARGE PATCH	L	1.00	Slabs
70	SCALING	L	1.00	Slabs
70	SCALING	L	1.00	Slabs
70	SCALING	L	1.00	Slabs
70	SCALING	L	1.00	Slabs
70	SCALING	L	1.00	Slabs
70	SCALING	M	1.00	Slabs
72	SHAT. SLAB	L	1.00	Slabs
74	JOINT SPALL	L	1.00	Slabs
74	JOINT SPALL	L	1.00	Slabs
74	JOINT SPALL	M	1.00	Slabs

---

**Sample Number:** 031      **Type:** R      **Area:** 20.00 Slabs      **PCI:** 37

**Sample Comments:**

63	LINEAR CR	L	1.00	Slabs
63	LINEAR CR	M	1.00	Slabs
63	LINEAR CR	M	1.00	Slabs
63	LINEAR CR	M	1.00	Slabs
63	LINEAR CR	H	1.00	Slabs
66	SMALL PATCH	L	1.00	Slabs
66	SMALL PATCH	L	1.00	Slabs
66	SMALL PATCH	L	1.00	Slabs
66	SMALL PATCH	L	1.00	Slabs
66	SMALL PATCH	M	1.00	Slabs
66	SMALL PATCH	M	1.00	Slabs
67	LARGE PATCH	L	1.00	Slabs
70	SCALING	M	1.00	Slabs
70	SCALING	H	1.00	Slabs
74	JOINT SPALL	L	1.00	Slabs
74	JOINT SPALL	L	1.00	Slabs
74	JOINT SPALL	L	1.00	Slabs
74	JOINT SPALL	L	1.00	Slabs
74	JOINT SPALL	M	1.00	Slabs
74	JOINT SPALL	M	1.00	Slabs
74	JOINT SPALL	M	1.00	Slabs
74	JOINT SPALL	M	1.00	Slabs

---

**Sample Number:** 033      **Type:** R      **Area:** 20.00 Slabs      **PCI:** 50

**Sample Comments:**

63	LINEAR CR	M	1.00	Slabs
63	LINEAR CR	M	1.00	Slabs
64	DURABIL. CR	L	1.00	Slabs
66	SMALL PATCH	L	1.00	Slabs
66	SMALL PATCH	L	1.00	Slabs
66	SMALL PATCH	L	1.00	Slabs
66	SMALL PATCH	L	1.00	Slabs
66	SMALL PATCH	L	1.00	Slabs
66	SMALL PATCH	L	1.00	Slabs
66	SMALL PATCH	L	1.00	Slabs
66	SMALL PATCH	L	1.00	Slabs
66	SMALL PATCH	L	1.00	Slabs
66	SMALL PATCH	M	1.00	Slabs
66	SMALL PATCH	M	1.00	Slabs
67	LARGE PATCH	L	1.00	Slabs
67	LARGE PATCH	L	1.00	Slabs
67	LARGE PATCH	L	1.00	Slabs
67	LARGE PATCH	L	1.00	Slabs
67	LARGE PATCH	L	1.00	Slabs
70	SCALING	L	1.00	Slabs
74	JOINT SPALL	M	1.00	Slabs
75	CORNER SPALL	L	1.00	Slabs

75	CORNER SPALL	L	1.00	Slabs
75	CORNER SPALL	M	1.00	Slabs
75	CORNER SPALL	M	1.00	Slabs
75	CORNER SPALL	M	1.00	Slabs

---

**Sample Number:** 035      **Type:** R      **Area:** 20.00 Slabs      **PCI:** 85

**Sample Comments:**

66	SMALL PATCH	L	1.00	Slabs
66	SMALL PATCH	L	1.00	Slabs
66	SMALL PATCH	L	1.00	Slabs
66	SMALL PATCH	L	1.00	Slabs
66	SMALL PATCH	L	1.00	Slabs
66	SMALL PATCH	L	1.00	Slabs
66	SMALL PATCH	L	1.00	Slabs
66	SMALL PATCH	L	1.00	Slabs
66	SMALL PATCH	L	1.00	Slabs
66	SMALL PATCH	M	1.00	Slabs
75	CORNER SPALL	M	1.00	Slabs
75	CORNER SPALL	M	1.00	Slabs

---

**Sample Number:** 036      **Type:** R      **Area:** 20.00 Slabs      **PCI:** 98

**Sample Comments:**

74	JOINT SPALL	L	1.00	Slabs
----	-------------	---	------	-------

---

**Sample Number:** 038      **Type:** R      **Area:** 20.00 Slabs      **PCI:** 69

**Sample Comments:**

63	LINEAR CR	M	1.00	Slabs
66	SMALL PATCH	L	1.00	Slabs
66	SMALL PATCH	L	1.00	Slabs
66	SMALL PATCH	L	1.00	Slabs
66	SMALL PATCH	L	1.00	Slabs
66	SMALL PATCH	M	1.00	Slabs
66	SMALL PATCH	M	1.00	Slabs
66	SMALL PATCH	M	1.00	Slabs
66	SMALL PATCH	M	1.00	Slabs
67	LARGE PATCH	L	1.00	Slabs
75	CORNER SPALL	L	1.00	Slabs
75	CORNER SPALL	L	1.00	Slabs
75	CORNER SPALL	H	1.00	Slabs

---

**Sample Number:** 039      **Type:** R      **Area:** 20.00 Slabs      **PCI:** 47

**Sample Comments:**

63	LINEAR CR	M	1.00	Slabs
63	LINEAR CR	M	1.00	Slabs
63	LINEAR CR	M	1.00	Slabs
66	SMALL PATCH	L	1.00	Slabs
66	SMALL PATCH	L	1.00	Slabs
66	SMALL PATCH	L	1.00	Slabs
66	SMALL PATCH	L	1.00	Slabs
66	SMALL PATCH	L	1.00	Slabs
66	SMALL PATCH	L	1.00	Slabs
66	SMALL PATCH	L	1.00	Slabs
66	SMALL PATCH	L	1.00	Slabs
66	SMALL PATCH	L	1.00	Slabs
66	SMALL PATCH	M	1.00	Slabs
66	SMALL PATCH	M	1.00	Slabs
70	SCALING	M	1.00	Slabs
72	SHAT. SLAB	L	1.00	Slabs
74	JOINT SPALL	L	1.00	Slabs
74	JOINT SPALL	L	1.00	Slabs
74	JOINT SPALL	M	1.00	Slabs
75	CORNER SPALL	L	1.00	Slabs

---

**Sample Number:** 042      **Type:** R      **Area:** 16.00 Slabs      **PCI:** 45

**Sample Comments:**

62	CORNER BREAK	L	1.00	Slabs
63	LINEAR CR	L	1.00	Slabs
63	LINEAR CR	L	1.00	Slabs
63	LINEAR CR	L	1.00	Slabs
64	DURABIL. CR	L	1.00	Slabs
64	DURABIL. CR	L	1.00	Slabs

66	SMALL PATCH	L	1.00	Slabs
66	SMALL PATCH	L	1.00	Slabs
72	SHAT. SLAB	H	1.00	Slabs
74	JOINT SPALL	M	1.00	Slabs

---

**Sample Number:** 043      **Type:** R      **Area:** 20.00 Slabs      **PCI:** 39

**Sample Comments:**

63	LINEAR CR	L	1.00	Slabs
63	LINEAR CR	L	1.00	Slabs
63	LINEAR CR	L	1.00	Slabs
63	LINEAR CR	L	1.00	Slabs
63	LINEAR CR	M	1.00	Slabs
63	LINEAR CR	M	1.00	Slabs
63	LINEAR CR	M	1.00	Slabs
64	DURABIL. CR	L	1.00	Slabs
64	DURABIL. CR	M	1.00	Slabs
66	SMALL PATCH	L	1.00	Slabs
66	SMALL PATCH	L	1.00	Slabs
66	SMALL PATCH	M	1.00	Slabs
66	SMALL PATCH	M	1.00	Slabs
66	SMALL PATCH	M	1.00	Slabs
67	LARGE PATCH	L	1.00	Slabs
70	SCALING	M	1.00	Slabs
70	SCALING	H	1.00	Slabs
74	JOINT SPALL	L	1.00	Slabs
74	JOINT SPALL	M	1.00	Slabs
75	CORNER SPALL	L	1.00	Slabs
75	CORNER SPALL	L	1.00	Slabs
75	CORNER SPALL	H	1.00	Slabs

---

**Sample Number:** 044      **Type:** R      **Area:** 20.00 Slabs      **PCI:** 60

**Sample Comments:**

63	LINEAR CR	M	1.00	Slabs
66	SMALL PATCH	L	1.00	Slabs
66	SMALL PATCH	L	1.00	Slabs
66	SMALL PATCH	L	1.00	Slabs
70	SCALING	M	1.00	Slabs
70	SCALING	M	1.00	Slabs
70	SCALING	M	1.00	Slabs
70	SCALING	H	1.00	Slabs
74	JOINT SPALL	L	1.00	Slabs
74	JOINT SPALL	M	1.00	Slabs
75	CORNER SPALL	M	1.00	Slabs

---

**Sample Number:** 045      **Type:** R      **Area:** 20.00 Slabs      **PCI:** 57

**Sample Comments:**

63	LINEAR CR	L	1.00	Slabs
63	LINEAR CR	L	1.00	Slabs
63	LINEAR CR	L	1.00	Slabs
63	LINEAR CR	L	1.00	Slabs
63	LINEAR CR	L	1.00	Slabs
63	LINEAR CR	M	1.00	Slabs
63	LINEAR CR	M	1.00	Slabs
66	SMALL PATCH	L	1.00	Slabs
66	SMALL PATCH	L	1.00	Slabs
66	SMALL PATCH	M	1.00	Slabs
74	JOINT SPALL	M	1.00	Slabs
74	JOINT SPALL	M	1.00	Slabs
75	CORNER SPALL	L	1.00	Slabs
75	CORNER SPALL	H	1.00	Slabs

---

**Sample Number:** 046      **Type:** R      **Area:** 20.00 Slabs      **PCI:** 49

**Sample Comments:**

63	LINEAR CR	L	1.00	Slabs
63	LINEAR CR	M	1.00	Slabs
66	SMALL PATCH	L	1.00	Slabs
66	SMALL PATCH	L	1.00	Slabs
66	SMALL PATCH	L	1.00	Slabs
66	SMALL PATCH	L	1.00	Slabs

66	SMALL PATCH	M	1.00	Slabs
66	SMALL PATCH	M	1.00	Slabs
66	SMALL PATCH	H	1.00	Slabs
66	SMALL PATCH	H	1.00	Slabs
70	SCALING	M	1.00	Slabs
72	SHAT. SLAB	M	1.00	Slabs
74	JOINT SPALL	H	1.00	Slabs

---

**Sample Number:** 047      **Type:** R      **Area:** 18.00 Slabs      **PCI:** 48

**Sample Comments:**

63	LINEAR CR	L	1.00	Slabs
63	LINEAR CR	M	1.00	Slabs
63	LINEAR CR	M	1.00	Slabs
66	SMALL PATCH	L	1.00	Slabs
66	SMALL PATCH	L	1.00	Slabs
66	SMALL PATCH	M	1.00	Slabs
67	LARGE PATCH	M	1.00	Slabs
72	SHAT. SLAB	M	1.00	Slabs
74	JOINT SPALL	L	1.00	Slabs
74	JOINT SPALL	M	1.00	Slabs
75	CORNER SPALL	L	1.00	Slabs

<b>Network:</b>	08K		<b>Name:</b>	HARVARD					
<b>Branch:</b>	HVDR1	<b>Name:</b>	RUNWAY 17/35	<b>Use:</b>	RUNWAY	<b>Area:</b>	222,000 SqFt		
<b>Section:</b>	01	of	1	<b>From:</b>	RW END 17	<b>To:</b>	RW END 35	<b>Last Const.:</b>	7/16/1999
<b>Surface:</b>	APC	<b>Family:</b>	NDA-APC-RUNWAY	<b>Zone:</b>	E	<b>Category:</b>	D	<b>Rank:</b>	P
<b>Area:</b>	222,000 SqFt	<b>Length:</b>	3,700 Ft	<b>Width:</b>	60 Ft				
<b>Slabs:</b>	<b>Slab Length:</b>	Ft	<b>Slab Width:</b>	Ft	<b>Joint Length:</b>	Ft			
<b>Shoulder:</b>	<b>Street Type:</b>	<b>Grade:</b>	0	<b>Lanes:</b>	0				
<b>Section Comments:</b>	45 SUs								
<b>Last Insp. Date:</b>	5/3/2022		<b>TotalSamples:</b>	45		<b>Surveyed:</b>	13		
<b>Conditions:</b>	PCI: 73								
<b>Inspection Comments:</b>									
<b>Sample Number:</b>	001	<b>Type:</b>	R	<b>Area:</b>	4980.00 SqFt	<b>PCI:</b>	76		
<b>Sample Comments:</b>									
47	JT REF. CR	L	775.00	Ft					
48	L & T CR	L	298.00	Ft					
<b>Sample Number:</b>	004	<b>Type:</b>	R	<b>Area:</b>	4980.00 SqFt	<b>PCI:</b>	77		
<b>Sample Comments:</b>									
47	JT REF. CR	L	715.00	Ft					
48	L & T CR	L	315.00	Ft					
<b>Sample Number:</b>	006	<b>Type:</b>	R	<b>Area:</b>	4980.00 SqFt	<b>PCI:</b>	78		
<b>Sample Comments:</b>									
47	JT REF. CR	L	632.00	Ft					
48	L & T CR	L	131.00	Ft					
<b>Sample Number:</b>	010	<b>Type:</b>	R	<b>Area:</b>	5000.00 SqFt	<b>PCI:</b>	67		
<b>Sample Comments:</b>									
43	BLOCK CR	L	800.00	SqFt					
47	JT REF. CR	L	775.00	Ft					
48	L & T CR	L	320.00	Ft					
<b>Sample Number:</b>	013	<b>Type:</b>	R	<b>Area:</b>	5000.00 SqFt	<b>PCI:</b>	66		
<b>Sample Comments:</b>									
43	BLOCK CR	L	1000.00	SqFt					
47	JT REF. CR	L	775.00	Ft					
48	L & T CR	L	225.00	Ft					
50	PATCHING	L	42.00	SqFt					
<b>Sample Number:</b>	016	<b>Type:</b>	R	<b>Area:</b>	4980.00 SqFt	<b>PCI:</b>	69		
<b>Sample Comments:</b>									
43	BLOCK CR	L	900.00	SqFt					
47	JT REF. CR	L	715.00	Ft					
48	L & T CR	L	188.00	Ft					
<b>Sample Number:</b>	019	<b>Type:</b>	R	<b>Area:</b>	4980.00 SqFt	<b>PCI:</b>	76		
<b>Sample Comments:</b>									
47	JT REF. CR	L	775.00	Ft					
48	L & T CR	L	237.00	Ft					
<b>Sample Number:</b>	022	<b>Type:</b>	R	<b>Area:</b>	4980.00 SqFt	<b>PCI:</b>	67		
<b>Sample Comments:</b>									
47	JT REF. CR	L	692.00	Ft					
48	L & T CR	L	489.00	Ft					
50	PATCHING	L	146.00	SqFt					
<b>Sample Number:</b>	026	<b>Type:</b>	R	<b>Area:</b>	4980.00 SqFt	<b>PCI:</b>	76		
<b>Sample Comments:</b>									
47	JT REF. CR	L	632.00	Ft					
48	L & T CR	L	368.00	Ft					

---

<b>Sample Number:</b> 031	<b>Type:</b> R	<b>Area:</b> 4980.00 SqFt	<b>PCI:</b> 76
---------------------------	----------------	---------------------------	----------------

**Sample Comments:**

47	JT REF. CR	L	775.00 Ft
48	L & T CR	L	260.00 Ft

---

<b>Sample Number:</b> 036	<b>Type:</b> R	<b>Area:</b> 5000.00 SqFt	<b>PCI:</b> 73
---------------------------	----------------	---------------------------	----------------

**Sample Comments:**

47	JT REF. CR	L	715.00 Ft
48	L & T CR	L	336.00 Ft
50	PATCHING	L	60.00 SqFt

---

<b>Sample Number:</b> 040	<b>Type:</b> R	<b>Area:</b> 4980.00 SqFt	<b>PCI:</b> 75
---------------------------	----------------	---------------------------	----------------

**Sample Comments:**

47	JT REF. CR	L	632.00 Ft
48	L & T CR	L	376.00 Ft

---

<b>Sample Number:</b> 044	<b>Type:</b> R	<b>Area:</b> 5000.00 SqFt	<b>PCI:</b> 76
---------------------------	----------------	---------------------------	----------------

**Sample Comments:**

47	JT REF. CR	L	775.00 Ft
48	L & T CR	L	150.00 Ft

<b>Network:</b>	08K		<b>Name:</b>	HARVARD					
<b>Branch:</b>	HVDT1	<b>Name:</b>	PARALLEL	<b>Use:</b>	TAXIWAY	<b>Area:</b>	42,000 SqFt		
<b>Section:</b>	01	of	1	<b>From:</b>	APRON1	<b>To:</b>	TW2-01	<b>Last Const.:</b>	7/1/1942
<b>Surface:</b>	PCC	<b>Family:</b>	NDA-PCC-TAXIWAY-C	<b>Zone:</b>	E	<b>Category:</b>	D	<b>Rank:</b>	S
<b>Area:</b>	42,000 SqFt	<b>Length:</b>	1,680 Ft	<b>Width:</b>	25 Ft				
<b>Slabs:</b>	224	<b>Slab Length:</b>	15 Ft	<b>Slab Width:</b>	13 Ft	<b>Joint Length:</b>	4,775 Ft		
<b>Shoulder:</b>		<b>Street Type:</b>		<b>Grade:</b>	0	<b>Lanes:</b>	0		
<b>Section Comments:</b>	11 SUs								
<b>Last Insp. Date:</b>	5/3/2022		<b>TotalSamples:</b>	11		<b>Surveyed:</b>	9		
<b>Conditions:</b>	PCI:	39							
<b>Inspection Comments:</b>									
<b>Sample Number:</b>	001	<b>Type:</b>	R	<b>Area:</b>	20.00 Slabs	<b>PCI:</b>	47		
<b>Sample Comments:</b>									
63	LINEAR CR	L	1.00	Slabs					
63	LINEAR CR	L	1.00	Slabs					
63	LINEAR CR	L	1.00	Slabs					
63	LINEAR CR	L	1.00	Slabs					
63	LINEAR CR	L	1.00	Slabs					
63	LINEAR CR	L	1.00	Slabs					
63	LINEAR CR	L	1.00	Slabs					
63	LINEAR CR	L	1.00	Slabs					
65	JT SEAL DMG	L	20.00	Slabs					
72	SHAT. SLAB	L	1.00	Slabs					
72	SHAT. SLAB	L	1.00	Slabs					
72	SHAT. SLAB	L	1.00	Slabs					
72	SHAT. SLAB	L	1.00	Slabs					
72	SHAT. SLAB	M	1.00	Slabs					
75	CORNER SPALL	H	1.00	Slabs					
<b>Sample Number:</b>	002	<b>Type:</b>	R	<b>Area:</b>	20.00 Slabs	<b>PCI:</b>	57		
<b>Sample Comments:</b>									
63	LINEAR CR	L	1.00	Slabs					
63	LINEAR CR	L	1.00	Slabs					
63	LINEAR CR	L	1.00	Slabs					
63	LINEAR CR	L	1.00	Slabs					
63	LINEAR CR	L	1.00	Slabs					
63	LINEAR CR	L	1.00	Slabs					
63	LINEAR CR	L	1.00	Slabs					
63	LINEAR CR	M	1.00	Slabs					
65	JT SEAL DMG	L	20.00	Slabs					
67	LARGE PATCH	L	1.00	Slabs					
72	SHAT. SLAB	L	1.00	Slabs					
72	SHAT. SLAB	L	1.00	Slabs					
72	SHAT. SLAB	L	1.00	Slabs					
<b>Sample Number:</b>	004	<b>Type:</b>	R	<b>Area:</b>	20.00 Slabs	<b>PCI:</b>	48		
<b>Sample Comments:</b>									
63	LINEAR CR	L	1.00	Slabs					
63	LINEAR CR	L	1.00	Slabs					
63	LINEAR CR	L	1.00	Slabs					
63	LINEAR CR	L	1.00	Slabs					
63	LINEAR CR	L	1.00	Slabs					
63	LINEAR CR	L	1.00	Slabs					
63	LINEAR CR	M	1.00	Slabs					
72	SHAT. SLAB	L	1.00	Slabs					
72	SHAT. SLAB	L	1.00	Slabs					
72	SHAT. SLAB	L	1.00	Slabs					
72	SHAT. SLAB	L	1.00	Slabs					
72	SHAT. SLAB	M	1.00	Slabs					
<b>Sample Number:</b>	005	<b>Type:</b>	R	<b>Area:</b>	20.00 Slabs	<b>PCI:</b>	39		
<b>Sample Comments:</b>									
62	CORNER BREAK	L	1.00	Slabs					
63	LINEAR CR	L	1.00	Slabs					



63	LINEAR CR	L	1.00	Slabs
63	LINEAR CR	L	1.00	Slabs
63	LINEAR CR	L	1.00	Slabs
63	LINEAR CR	L	1.00	Slabs
63	LINEAR CR	L	1.00	Slabs
63	LINEAR CR	L	1.00	Slabs
63	LINEAR CR	L	1.00	Slabs
63	LINEAR CR	L	1.00	Slabs
63	LINEAR CR	L	1.00	Slabs
63	LINEAR CR	L	1.00	Slabs
63	LINEAR CR	L	1.00	Slabs
63	LINEAR CR	M	1.00	Slabs
63	LINEAR CR	M	1.00	Slabs
63	LINEAR CR	M	1.00	Slabs
65	JT SEAL DMG	L	20.00	Slabs
72	SHAT. SLAB	L	1.00	Slabs
72	SHAT. SLAB	L	1.00	Slabs
72	SHAT. SLAB	L	1.00	Slabs
72	SHAT. SLAB	L	1.00	Slabs
72	SHAT. SLAB	L	1.00	Slabs

---

**Sample Number:** 006      **Type:** R      **Area:** 20.00 Slabs      **PCI:** 37

**Sample Comments:**

63	LINEAR CR	L	1.00	Slabs
63	LINEAR CR	L	1.00	Slabs
63	LINEAR CR	L	1.00	Slabs
63	LINEAR CR	L	1.00	Slabs
65	JT SEAL DMG	L	20.00	Slabs
72	SHAT. SLAB	L	1.00	Slabs
72	SHAT. SLAB	L	1.00	Slabs
72	SHAT. SLAB	L	1.00	Slabs
72	SHAT. SLAB	L	1.00	Slabs
72	SHAT. SLAB	L	1.00	Slabs
72	SHAT. SLAB	L	1.00	Slabs
72	SHAT. SLAB	L	1.00	Slabs
72	SHAT. SLAB	L	1.00	Slabs
72	SHAT. SLAB	L	1.00	Slabs
72	SHAT. SLAB	L	1.00	Slabs
72	SHAT. SLAB	L	1.00	Slabs
72	SHAT. SLAB	L	1.00	Slabs
72	SHAT. SLAB	L	1.00	Slabs
72	SHAT. SLAB	L	1.00	Slabs
74	JOINT SPALL	H	1.00	Slabs
75	CORNER SPALL	L	1.00	Slabs

---

**Sample Number:** 008      **Type:** R      **Area:** 20.00 Slabs      **PCI:** 24

**Sample Comments:**

63	LINEAR CR	L	1.00	Slabs
63	LINEAR CR	L	1.00	Slabs
63	LINEAR CR	L	1.00	Slabs
63	LINEAR CR	L	1.00	Slabs
63	LINEAR CR	L	1.00	Slabs
63	LINEAR CR	L	1.00	Slabs
63	LINEAR CR	L	1.00	Slabs
63	LINEAR CR	L	1.00	Slabs
63	LINEAR CR	L	1.00	Slabs
63	LINEAR CR	M	1.00	Slabs
63	LINEAR CR	M	1.00	Slabs
63	LINEAR CR	M	1.00	Slabs
63	LINEAR CR	M	1.00	Slabs
65	JT SEAL DMG	L	20.00	Slabs
66	SMALL PATCH	L	1.00	Slabs
66	SMALL PATCH	L	1.00	Slabs
67	LARGE PATCH	L	1.00	Slabs
72	SHAT. SLAB	L	1.00	Slabs
72	SHAT. SLAB	L	1.00	Slabs
72	SHAT. SLAB	L	1.00	Slabs
72	SHAT. SLAB	L	1.00	Slabs
72	SHAT. SLAB	L	1.00	Slabs
72	SHAT. SLAB	L	1.00	Slabs
74	JOINT SPALL	L	1.00	Slabs

74	JOINT SPALL	M	1.00	Slabs
74	JOINT SPALL	H	1.00	Slabs
74	JOINT SPALL	H	1.00	Slabs
75	CORNER SPALL	M	1.00	Slabs

---

**Sample Number:** 009      **Type:** R      **Area:** 20.00 Slabs      **PCI:** 22

**Sample Comments:**

63	LINEAR CR	L	1.00	Slabs
63	LINEAR CR	L	1.00	Slabs
63	LINEAR CR	L	1.00	Slabs
63	LINEAR CR	L	1.00	Slabs
63	LINEAR CR	L	1.00	Slabs
63	LINEAR CR	M	1.00	Slabs
63	LINEAR CR	M	1.00	Slabs
63	LINEAR CR	M	1.00	Slabs
63	LINEAR CR	M	1.00	Slabs
65	JT SEAL DMG	L	20.00	Slabs
72	SHAT. SLAB	L	1.00	Slabs
72	SHAT. SLAB	L	1.00	Slabs
72	SHAT. SLAB	L	1.00	Slabs
72	SHAT. SLAB	L	1.00	Slabs
72	SHAT. SLAB	L	1.00	Slabs
74	JOINT SPALL	M	1.00	Slabs
74	JOINT SPALL	H	1.00	Slabs
74	JOINT SPALL	H	1.00	Slabs
74	JOINT SPALL	H	1.00	Slabs
75	CORNER SPALL	M	1.00	Slabs
75	CORNER SPALL	H	1.00	Slabs
75	CORNER SPALL	H	1.00	Slabs
75	CORNER SPALL	H	1.00	Slabs

---

**Sample Number:** 010      **Type:** R      **Area:** 20.00 Slabs      **PCI:** 26

**Sample Comments:**

63	LINEAR CR	L	1.00	Slabs
63	LINEAR CR	L	1.00	Slabs
63	LINEAR CR	L	1.00	Slabs
63	LINEAR CR	L	1.00	Slabs
63	LINEAR CR	L	1.00	Slabs
63	LINEAR CR	L	1.00	Slabs
63	LINEAR CR	L	1.00	Slabs
63	LINEAR CR	M	1.00	Slabs
63	LINEAR CR	M	1.00	Slabs
63	LINEAR CR	M	1.00	Slabs
63	LINEAR CR	H	1.00	Slabs
67	LARGE PATCH	L	1.00	Slabs
67	LARGE PATCH	L	1.00	Slabs
72	SHAT. SLAB	L	1.00	Slabs
72	SHAT. SLAB	L	1.00	Slabs
72	SHAT. SLAB	L	1.00	Slabs
72	SHAT. SLAB	M	1.00	Slabs
74	JOINT SPALL	L	1.00	Slabs
74	JOINT SPALL	H	1.00	Slabs
75	CORNER SPALL	L	1.00	Slabs

---

**Sample Number:** 011      **Type:** R      **Area:** 20.00 Slabs      **PCI:** 52

**Sample Comments:**

62	CORNER BREAK	L	1.00	Slabs
63	LINEAR CR	L	1.00	Slabs
63	LINEAR CR	L	1.00	Slabs
63	LINEAR CR	L	1.00	Slabs
63	LINEAR CR	L	1.00	Slabs
63	LINEAR CR	L	1.00	Slabs
63	LINEAR CR	M	1.00	Slabs
63	LINEAR CR	M	1.00	Slabs
65	JT SEAL DMG	L	20.00	Slabs
72	SHAT. SLAB	L	1.00	Slabs
74	JOINT SPALL	H	1.00	Slabs
75	CORNER SPALL	H	1.00	Slabs

---

**Network:** 08K **Name:** HARVARD

---

**Branch:** HVDT2 **Name:** CONNECTING TAXIWAY **Use:** TAXIWAY **Area:** 26,898 SqFt

---

**Section:** 01 of 2 **From:** RW END 17 **To:** TW1 **Last Const.:** 7/16/1999

**Surface:** AAC **Family:** NDA-AC-TAXIWAY **Zone:** E **Category:** D **Rank:** S

**Area:** 12,748 SqFt **Length:** 472 Ft **Width:** 25 Ft

**Slabs:** **Slab Length:** Ft **Slab Width:** Ft **Joint Length:** Ft

**Shoulder:** **Street Type:** **Grade:** 0 **Lanes:** 0

**Section Comments:** 2 SUs

---

**Last Insp. Date:** 5/3/2022 **TotalSamples:** 2 **Surveyed:** 2

**Conditions:** PCI: 59

**Inspection Comments:**

---

**Sample Number:** 001 **Type:** R **Area:** 5018.00 SqFt **PCI:** 57

**Sample Comments:**

48 L & T CR L 110.00 Ft

48 L & T CR M 86.00 Ft

48 L & T CR H 150.00 Ft

57 WEATHERING L 5018.00 SqFt

---

**Sample Number:** 002 **Type:** R **Area:** 5018.00 SqFt **PCI:** 61

**Sample Comments:**

48 L & T CR L 240.00 Ft

48 L & T CR M 60.00 Ft

48 L & T CR H 75.00 Ft

57 WEATHERING L 5018.00 SqFt

---

**Network:** 08K **Name:** HARVARD

---

**Branch:** HVDT2 **Name:** CONNECTING TAXIWAY **Use:** TAXIWAY **Area:** 26,898 SqFt

---

**Section:** 02 of 2 **From:** RW17/53 **To:** APRON1 **Last Const.:** 7/16/1999

**Surface:** AAC **Family:** NDA-AC-TAXIWAY **Zone:** E **Category:** D **Rank:** P

**Area:** 14,150 SqFt **Length:** 472 Ft **Width:** 25 Ft

**Slabs:** **Slab Length:** Ft **Slab Width:** Ft **Joint Length:** Ft

**Shoulder:** **Street Type:** **Grade:** 0 **Lanes:** 0

**Section Comments:** 2 SUs

---

**Last Insp. Date:** 5/3/2022 **TotalSamples:** 2 **Surveyed:** 2

**Conditions:** PCI: 64

**Inspection Comments:**

---

**Sample Number:** 001 **Type:** R **Area:** 5000.00 SqFt **PCI:** 67

**Sample Comments:**

48 L & T CR L 125.00 Ft

48 L & T CR M 125.00 Ft

48 L & T CR H 5.00 Ft

57 WEATHERING L 5000.00 SqFt

---

**Sample Number:** 002 **Type:** R **Area:** 5000.00 SqFt **PCI:** 61

**Sample Comments:**

43 BLOCK CR L 50.00 SqFt

47 JT REF. CR L 130.00 Ft

48 L & T CR L 150.00 Ft

48 L & T CR M 150.00 Ft

57 WEATHERING L 5000.00 SqFt

<b>Network:</b>	08K	<b>Name:</b>	HARVARD						
<b>Branch:</b>	HVDT3	<b>Name:</b>	HANGAR TAXILANES	<b>Use:</b>	TAXIWAY	<b>Area:</b>	26,759 SqFt		
<b>Section:</b>	01	of	1	<b>From:</b>	APRON1	<b>To:</b>	END OF T3-1	<b>Last Const.:</b>	8/6/2021
<b>Surface:</b>	PCC	<b>Family:</b>	DEFAULT	<b>Zone:</b>	E	<b>Category:</b>	D	<b>Rank:</b>	S
<b>Area:</b>	26,759 SqFt	<b>Length:</b>	589 Ft	<b>Width:</b>	45 Ft				
<b>Slabs:</b>	235	<b>Slab Length:</b>	10 Ft	<b>Slab Width:</b>	11 Ft	<b>Joint Length:</b>	4,885 Ft		
<b>Shoulder:</b>		<b>Street Type:</b>		<b>Grade:</b>	0	<b>Lanes:</b>	0		
<b>Section Comments:</b>	13 SU								
<b>Last Insp. Date:</b>	5/3/2022	<b>TotalSamples:</b>	13	<b>Surveyed:</b>	6				
<b>Conditions:</b>	PCI: 98								
<b>Inspection Comments:</b>									
<b>Sample Number:</b>	001	<b>Type:</b>	R	<b>Area:</b>	16.00 Slabs	<b>PCI:</b>	98		
<b>Sample Comments:</b>									
74	JOINT SPALL	L	1.00	Slabs					
<b>Sample Number:</b>	004	<b>Type:</b>	R	<b>Area:</b>	18.00 Slabs	<b>PCI:</b>	100		
<b>Sample Comments:</b>									
<No Distress>									
<b>Sample Number:</b>	006	<b>Type:</b>	R	<b>Area:</b>	18.00 Slabs	<b>PCI:</b>	97		
<b>Sample Comments:</b>									
74	JOINT SPALL	L	1.00	Slabs					
74	JOINT SPALL	L	1.00	Slabs					
<b>Sample Number:</b>	008	<b>Type:</b>	R	<b>Area:</b>	17.00 Slabs	<b>PCI:</b>	100		
<b>Sample Comments:</b>									
<No Distress>									
<b>Sample Number:</b>	011	<b>Type:</b>	R	<b>Area:</b>	18.00 Slabs	<b>PCI:</b>	100		
<b>Sample Comments:</b>									
<No Distress>									
<b>Sample Number:</b>	013	<b>Type:</b>	R	<b>Area:</b>	18.00 Slabs	<b>PCI:</b>	91		
<b>Sample Comments:</b>									
63	LINEAR CR	L	1.00	Slabs					
63	LINEAR CR	L	1.00	Slabs					

08K (Harvard NE) Apron  
 Branch A1 Section 1  
 PCI 1942 – 2022

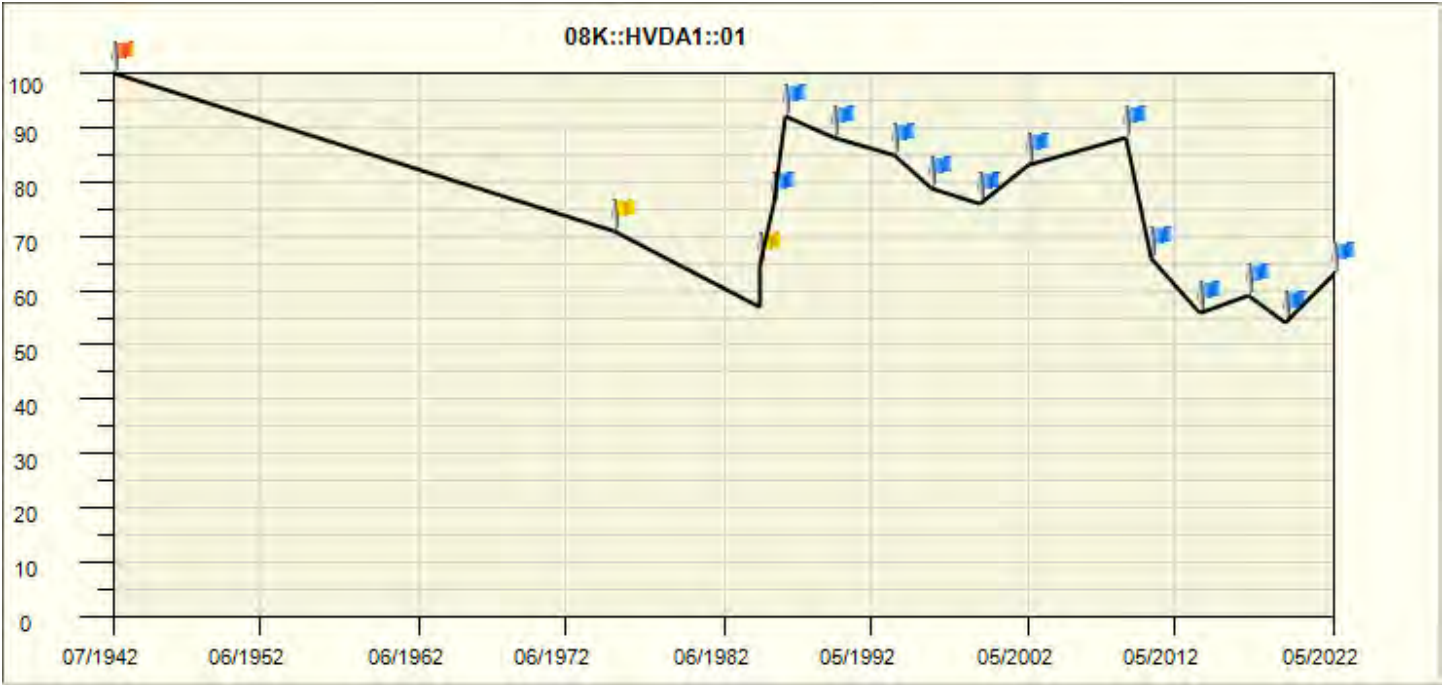

Legend

- Major
- Global
- Localized
- Inspection

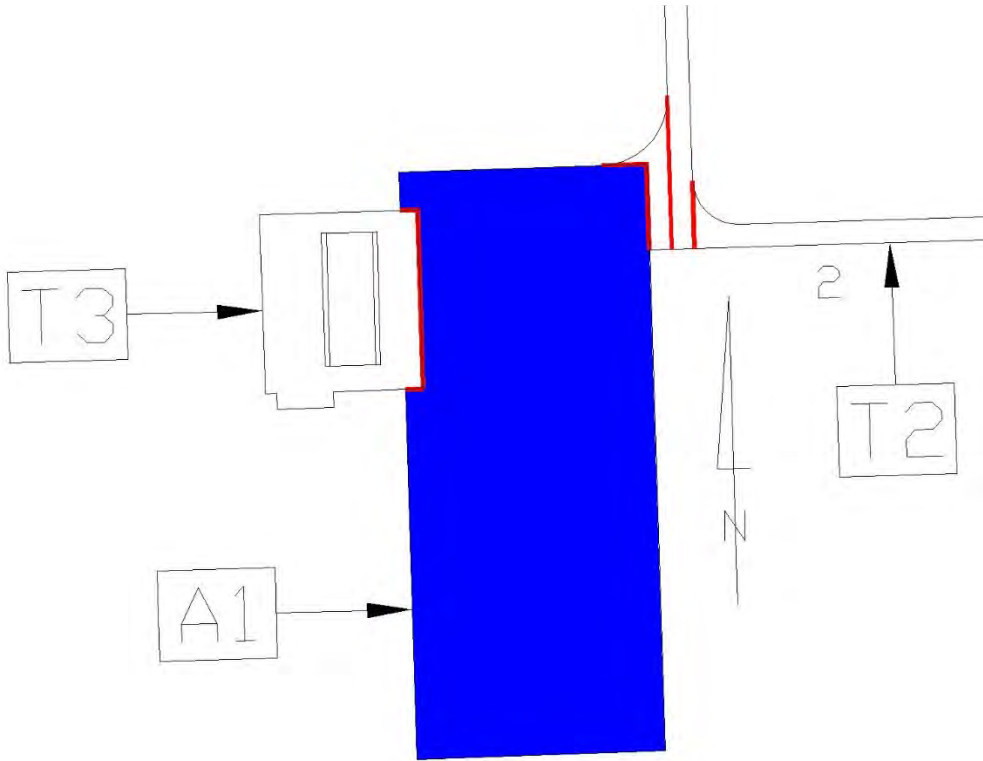

08K (Harvard NE) Runway  
 Branch R1 Section 1  
 PCI 1942 – 2022

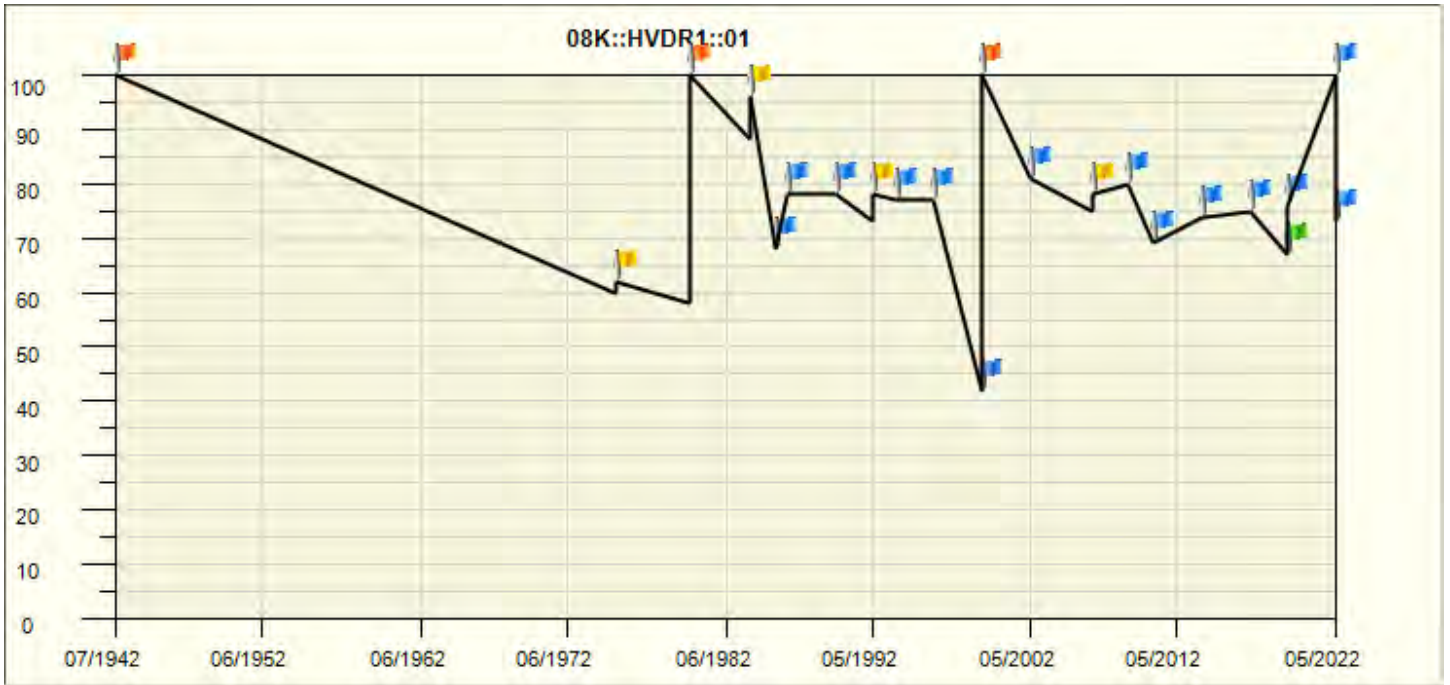

Legend



Major



Global



Localized



Inspection

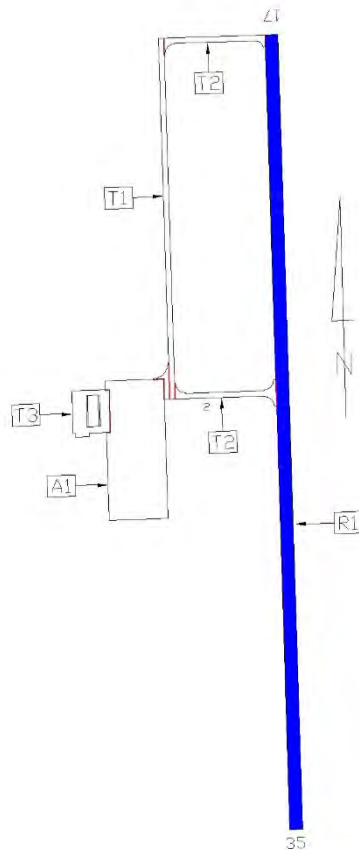

08K (Harvard NE) Taxiway  
 Branch T1 Section 1  
 PCI 1942 – 2022

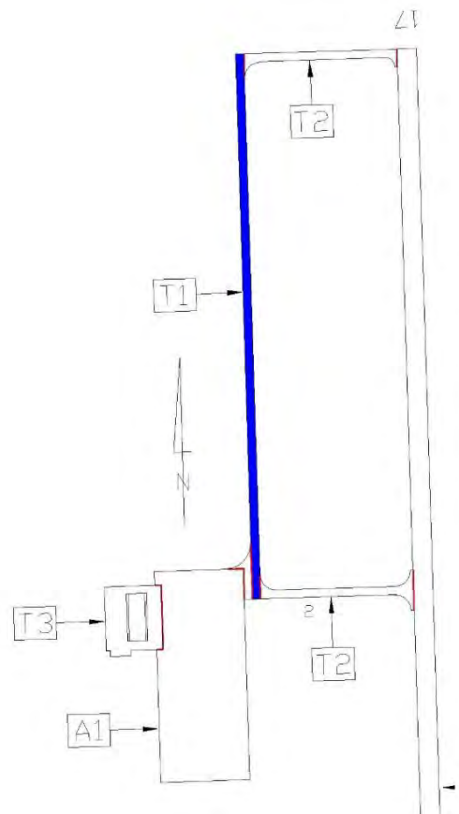
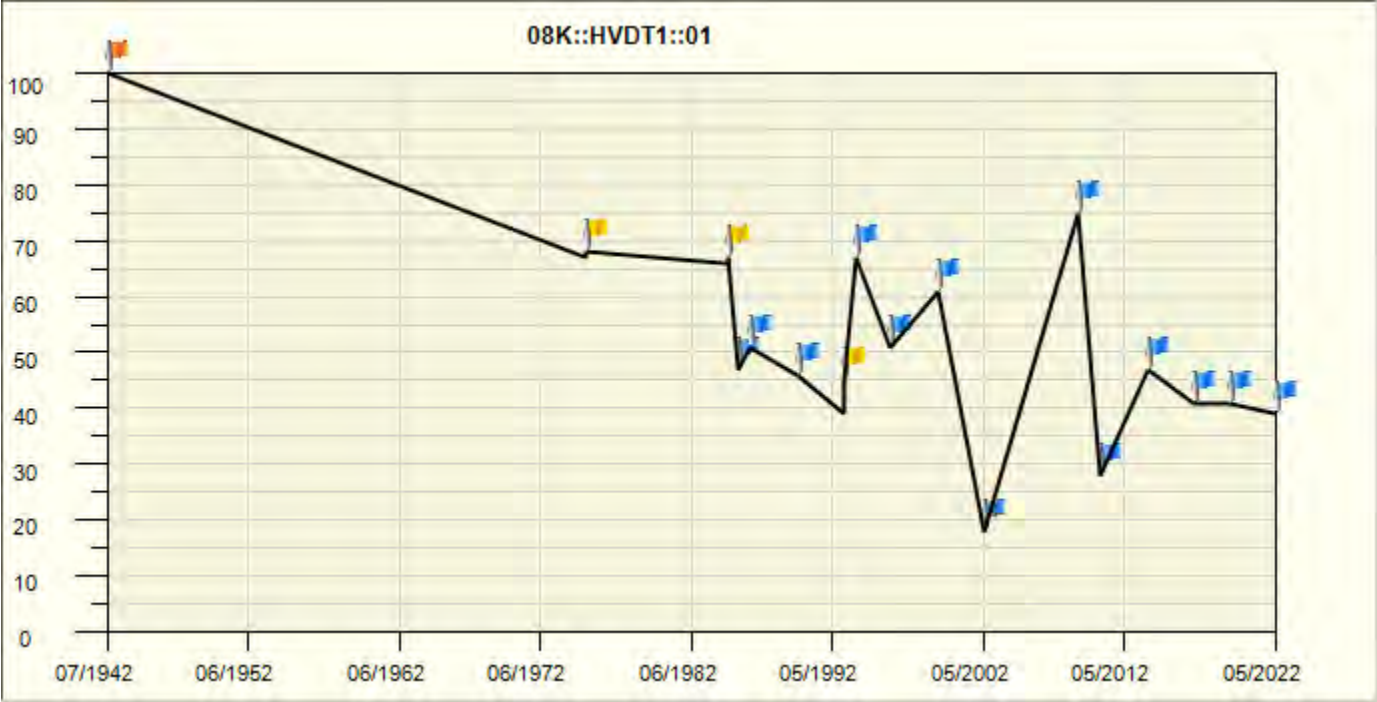



08K (Harvard NE) Taxiway  
 Branch T2 Section 1  
 PCI 1972 – 2022

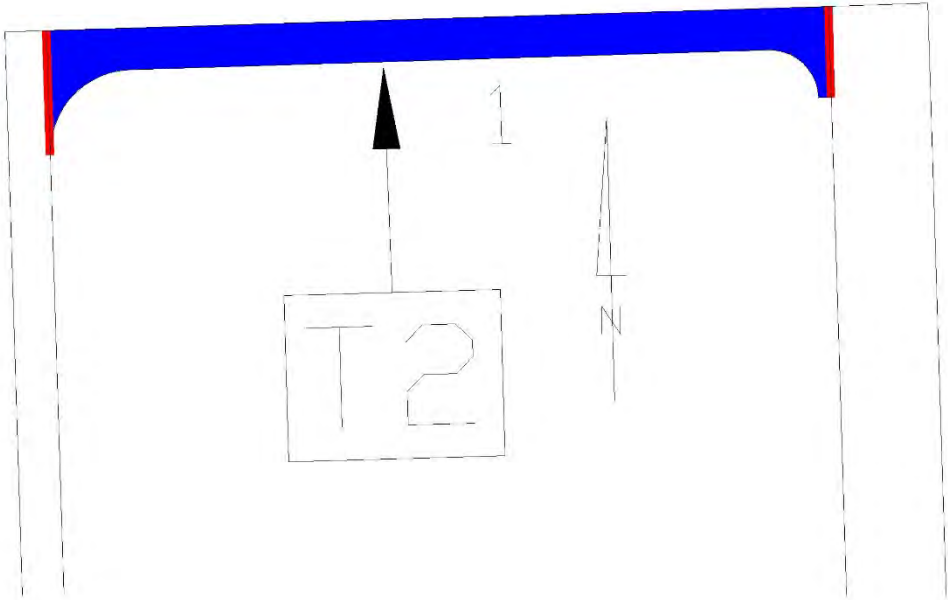
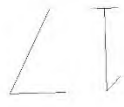
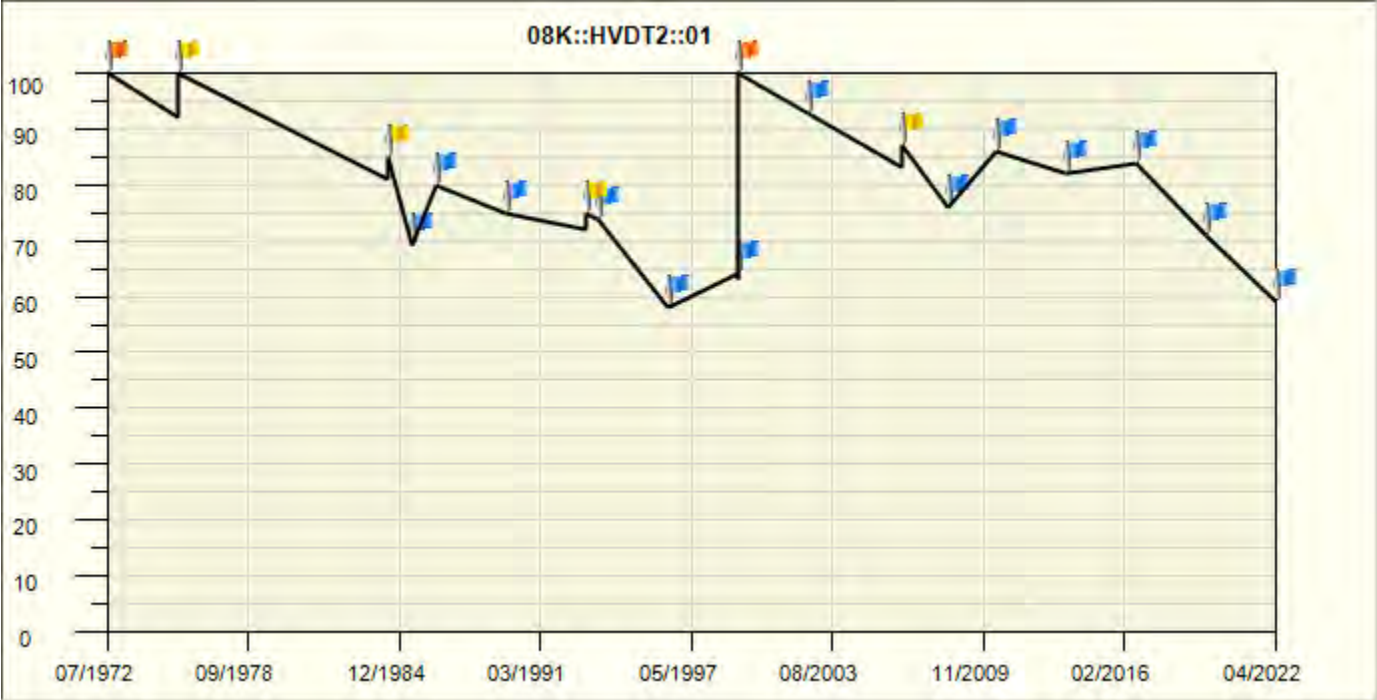

08K (Harvard NE) Taxiway  
 Branch T2 Section 2  
 PCI 1972 – 2022

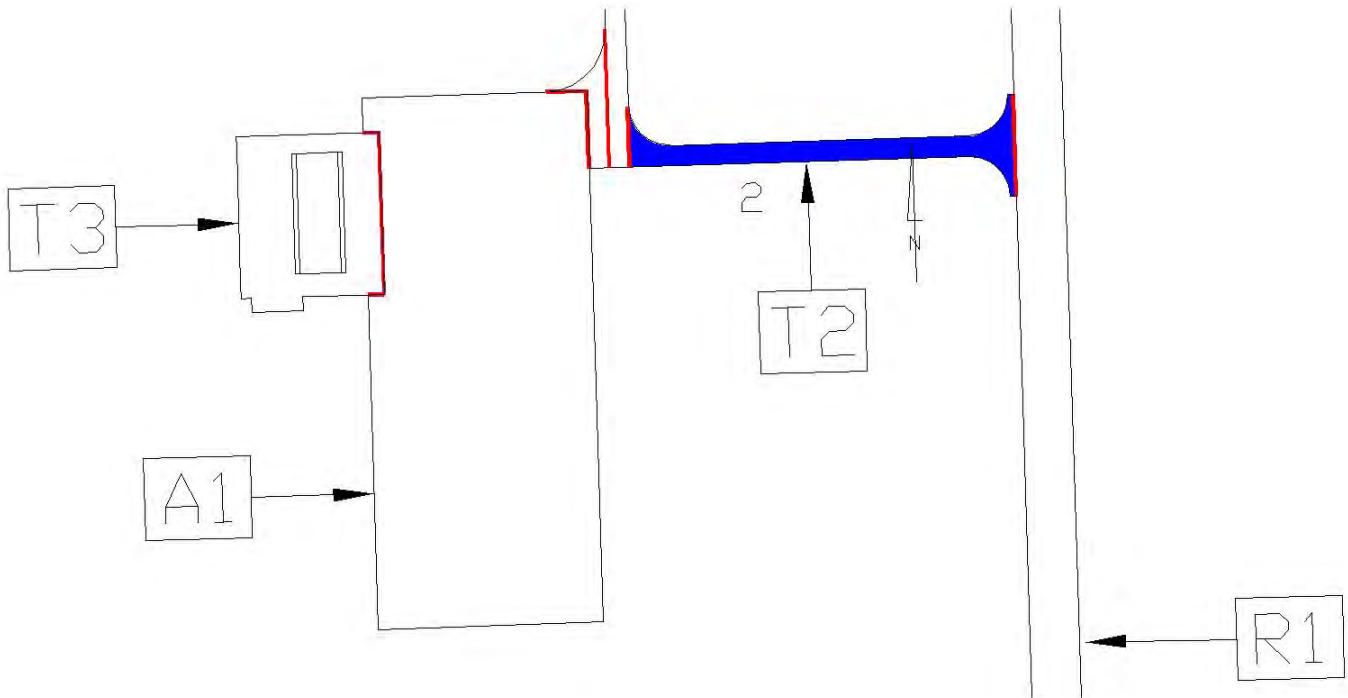
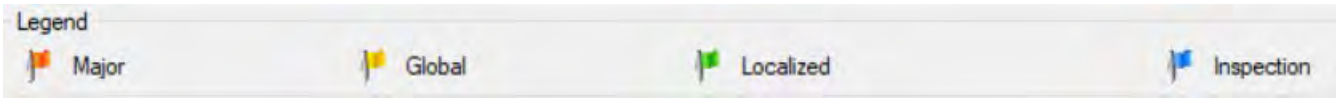
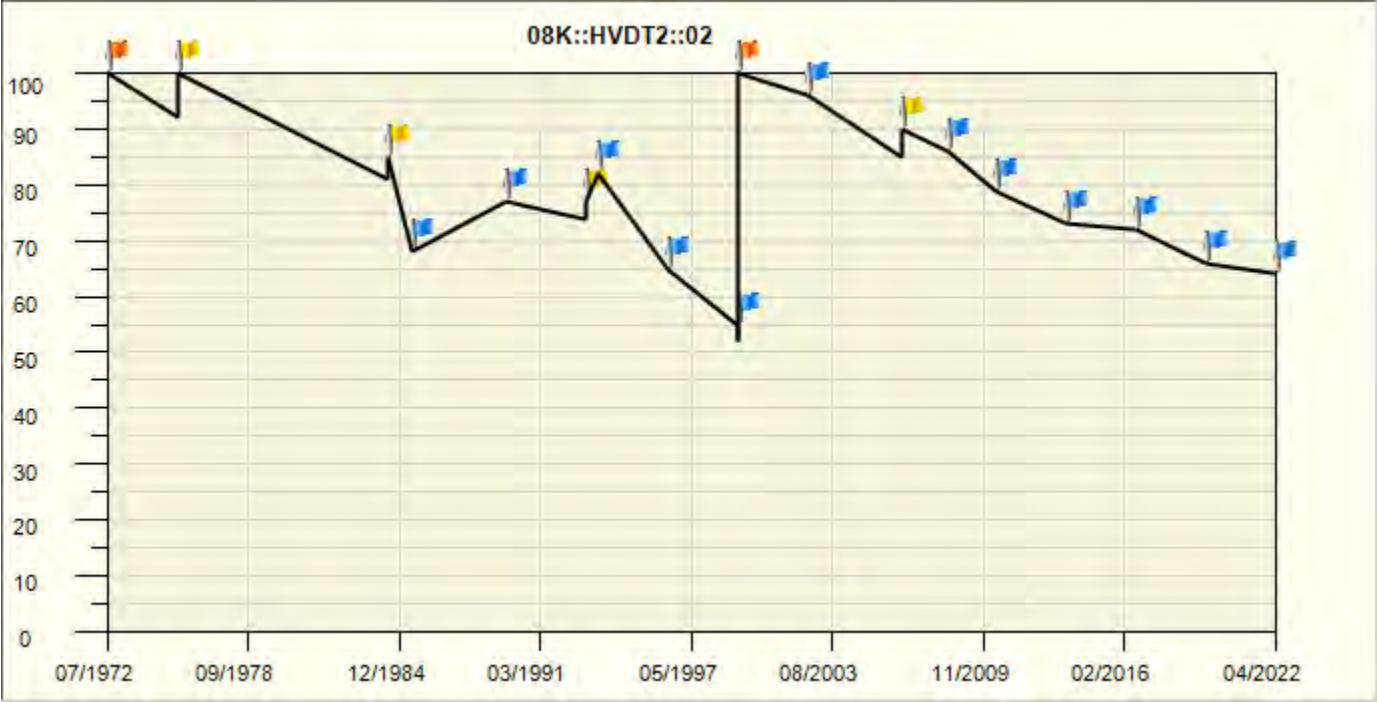

**08K (Harvard NE) Taxiway**  
**Branch T3 Section 1**  
**PCI (1942) – 2022**  
 (T3-1's site was on an abandoned section of  
 the WWII Apron pavement)

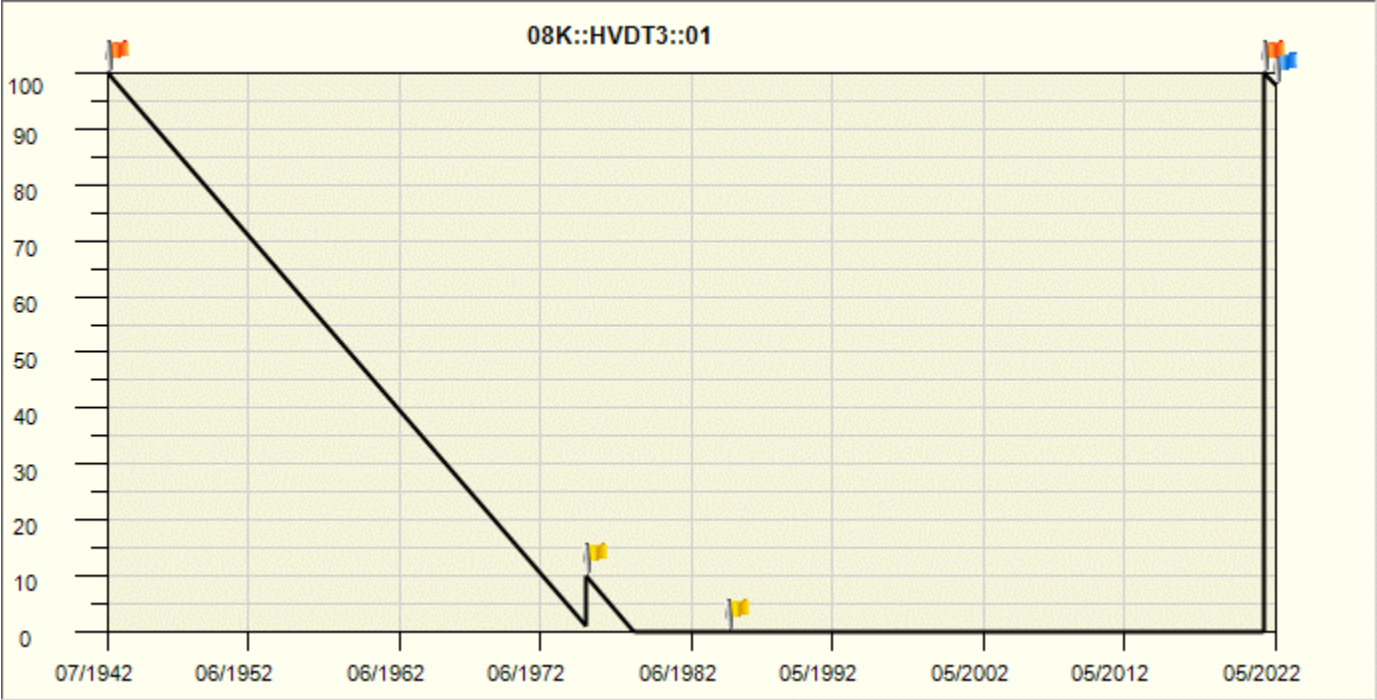

Legend

- Major
- Global
- Localized
- Inspection

