

# HOLDREGE

PHELPS COUNTY  
NEBRASKA  
POPULATION 5636 (2000 CENSUS)  
1983

R 19 W

R 18 W

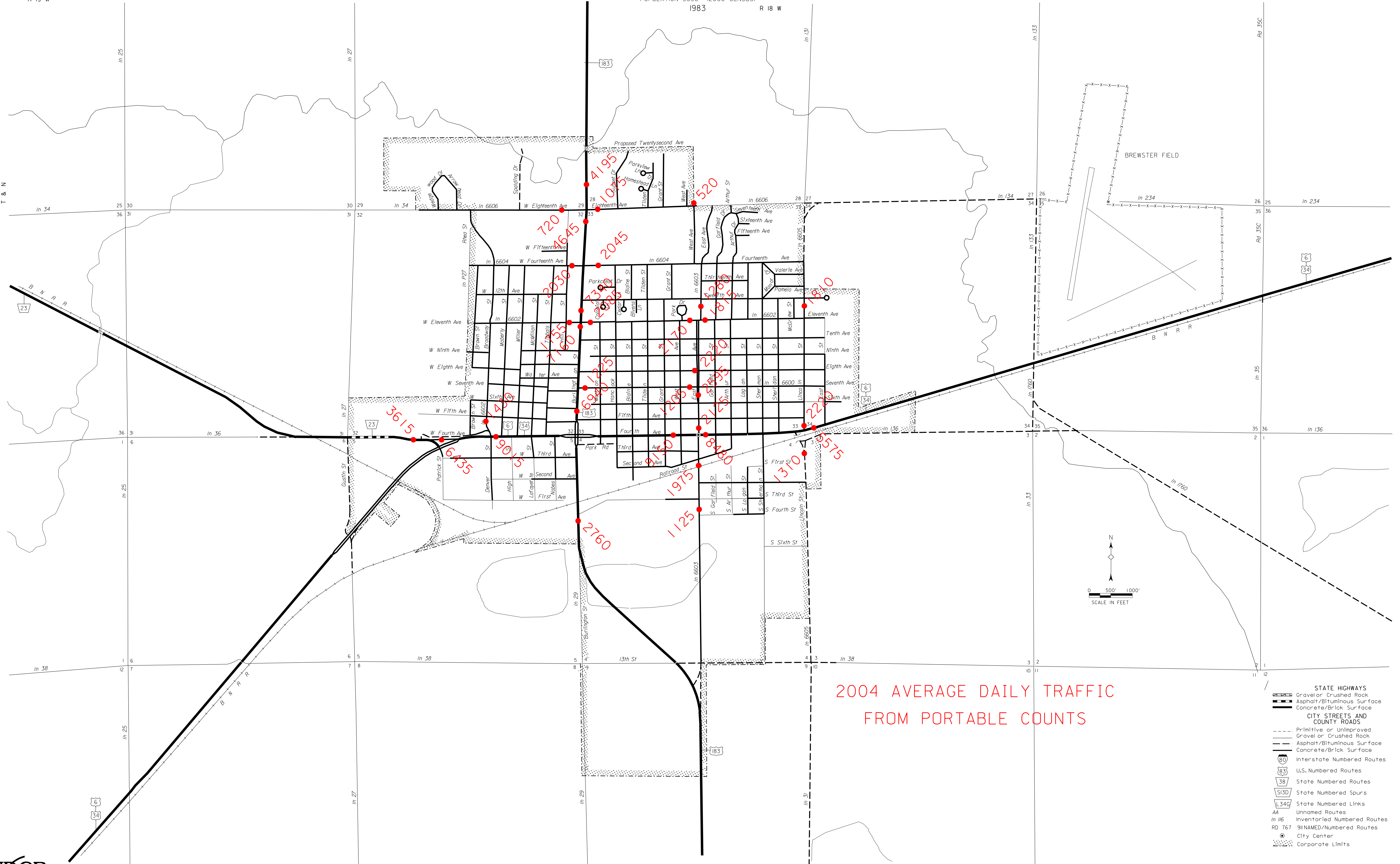

2004 AVERAGE DAILY TRAFFIC  
FROM PORTABLE COUNTS

- STATE HIGHWAYS
  - Gravel or Crushed Rock
  - Asphalt/Bituminous Surface
  - Concrete/Brick Surface
- CITY STREETS AND COUNTY ROADS
  - Primitive or Unimproved
  - Gravel or Crushed Rock
  - Asphalt/Bituminous Surface
  - Concrete/Brick Surface
- Interstate Numbered Routes (80)
- U.S. Numbered Routes (83)
- State Numbered Routes (38)
- State Numbered Spurs (515D)
- State Numbered Links (134G)
- Unnamed Routes (AA)
- Inventoried Numbered Routes (In 116)
- 911 NAMED/Numbered Routes (RD 767)
- City Center (●)
- Corporate Limits (dotted line)

CORPORATE LIMITS AS OF 2001  
STATE HIGHWAYS CORRECTED TO 1999

