

GENERAL HIGHWAY MAP PAWNEE COUNTY NEBRASKA

PREPARED BY THE
DEPARTMENT OF ROADS
GIS/MAPPING SECTION
IN COOPERATION WITH THE
U.S. DEPARTMENT OF TRANSPORTATION
FEDERAL HIGHWAY ADMINISTRATION

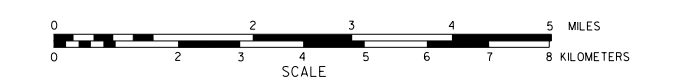

INVENTORY DATE:
2012

DATE	REVISION HISTORY
2008	REVISED SUPERSTREET
SEP 2012	COUNTY
JAN 2013	REVISED BNSFR # OF PAWNEE REPORT
FEB 2013	2008 - 11, 15A, 16, 17, 18, 19, 20, 21, 22, 23, 24, 25, 26, 27, 28, 29, 30, 31, 32, 33, 34, 35, 36, 37, 38, 39, 40, 41, 42, 43, 44, 45, 46, 47, 48, 49, 50, 51, 52, 53, 54, 55, 56, 57, 58, 59, 60, 61, 62, 63, 64, 65, 66, 67, 68, 69, 70, 71, 72, 73, 74, 75, 76, 77, 78, 79, 80, 81, 82, 83, 84, 85, 86, 87, 88, 89, 90, 91, 92, 93, 94, 95, 96, 97, 98, 99, 100

LEGEND

- Primitive Road
- Unimproved Road
- Gravel or Crushed Rock
- Asphalt/Bituminous Surface
- Mulch/Low Undrilled Highway
- Asphalt/Bituminous Surface
- Concrete/Brick Surface
- Mulch/Low Undrilled Highway
- Concrete/Brick Surface
- Distressed Highway
- Interstate Highway with Full Control of Access
- State Roads and Streets
- 911 NAME/Numbered Roads
- Interstate-Numbered Highway
- US-Numbered Highway
- State-Numbered Highway
- State-Numbered Highway Spur
- State-Numbered Highway Link
- Highway Reference Post Number
- Interstate Exit Number
- Wide Stream
- Narrow Stream
- Irrigation Ditch
- Reservoir, Pond or Lake
- Reservoir, With Dam
- Highway Bridge-Any Type
- Small Bridges-Closely Spaced
- General Bridge
- Arch Bridge
- Truss Bridge
- Pedestrian Underpass
- Railroad Overpass
- Railroad Underpass
- Railroad
- Overpass with Road on Tab
- Cornice Guard
- Dwelling
- Row of Dwellings
- Cemetery
- Church or Other Religious Institution
- Church with Cemetery Adjacent
- Healthcare
- Bushead
- Industrial Plant
- Filling Station
- Grain Elevator
- Appropriate PH
- Agricultural Experiment Station
- Educational Institutions
- Public Use Area
- Recreational Facilities
- Rest Area
- Ranger Station
- Fire Station
- Community Hall
- Correctional Institution
- Tourist Court or Motel
- Museum
- Firestation
- Courthouse
- Armory
- Post Office
- Highway Maintenance Yard
- Dump Area
- Sewage Disposal Plant
- Water Supply Stand Pipe
- Road or RV Station
- Weight Station or Port of Entry
- Commercial or Municipal Airport
- Airport with Paved Runways
- State Boundary
- County Boundary
- Township Line
- Section Line
- Corporate Limit Lines
- Parks and Other Reservations
- Boundary Limits of Area Shown in Other Maps
- State Capital
- County Seat
- Other Cities and Villages
- Incorporated City or Village
- Triangulation Station
- Points Between Which Distances are Measured Indicated Thus
- Latitude and Longitude

LEGEND

NATIONAL FUNCTIONAL CLASSIFICATION

- INTERSTATE
- OTHER PRINCIPALS & EXPRESSWAYS
- OTHER PRINCIPAL ARTERIALS
- MINOR ARTERIAL
- MAJOR COLLECTOR
- MINOR COLLECTOR
- URBANIZED BOUNDARY

All Roads Not Otherwise Indicated Are Classified As Local.
FHWA Approval: March 15, 2016.

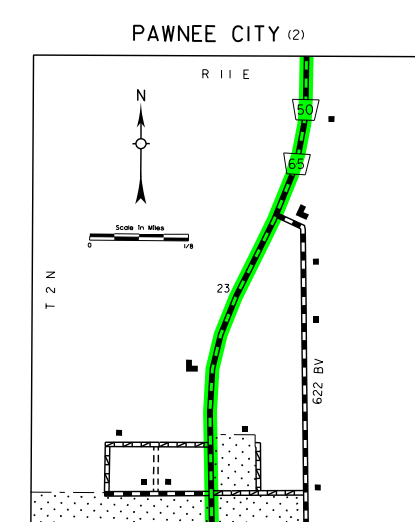
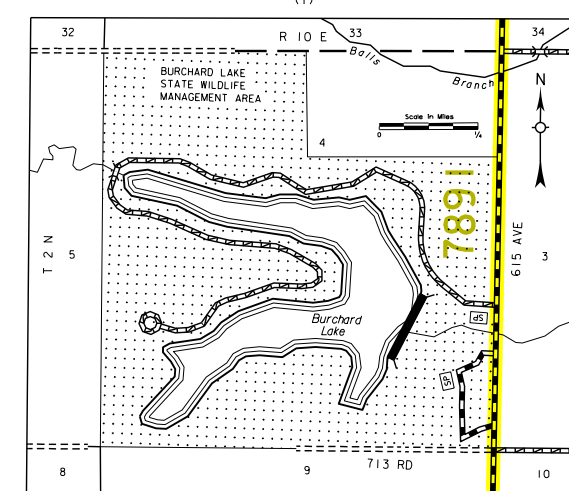
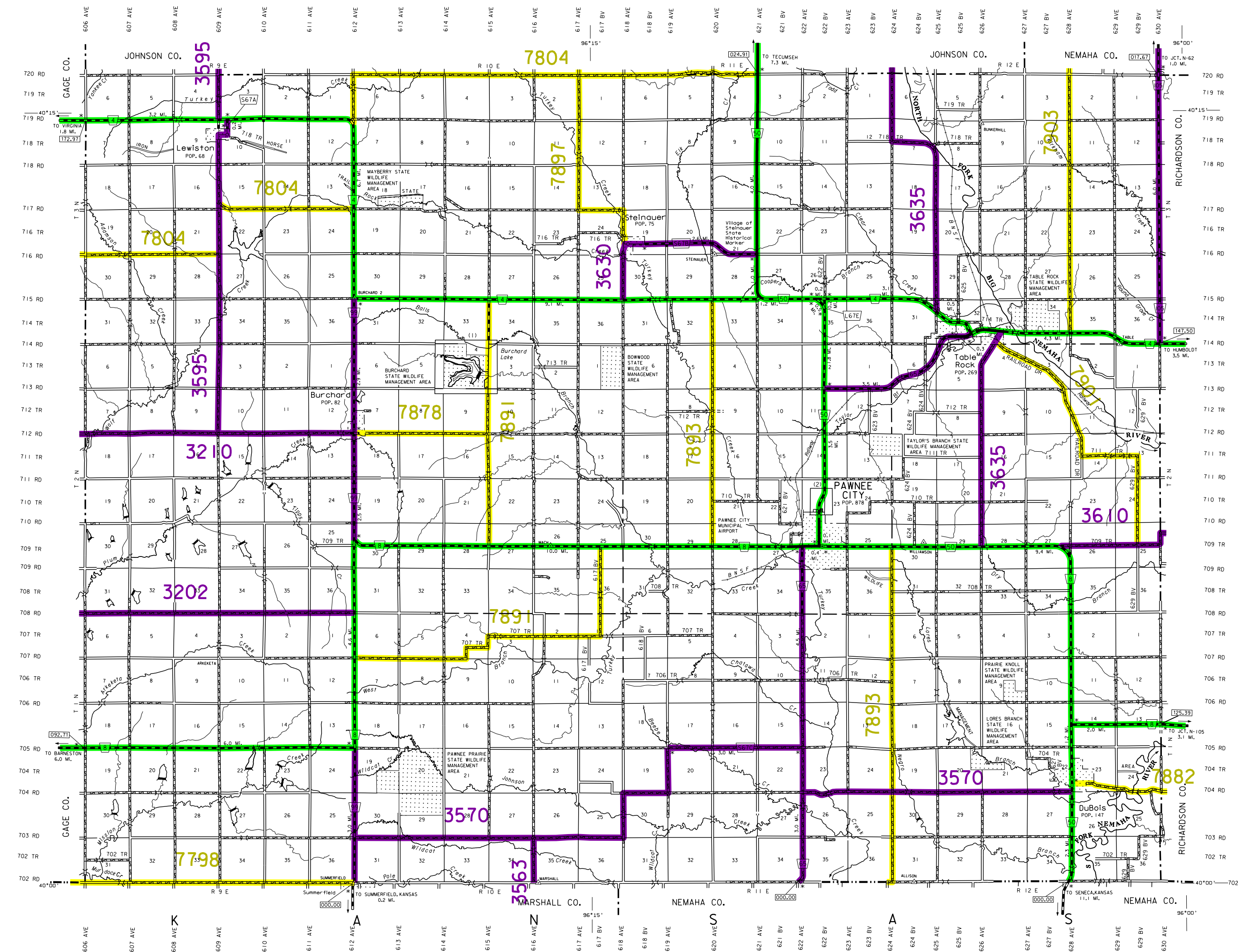

LAMBERT CONFORMAL CONIC PROJECTION
1983 NORTH AMERICAN DATUM
NEBRASKA COORDINATE SYSTEM

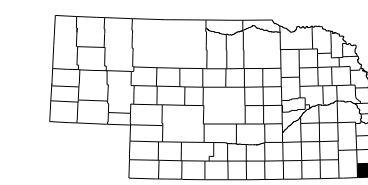

This map is to be used for information only and is not intended to show ownership or to be definitive on which roads are public or private. The Nebraska Department of Roads makes no warranty, representation or assumption of liability for the accuracy of this information and assumes no liability for errors or omissions. Any inconsistencies should be reported to NDOR.

POPULATION AS OF 2010 CENSUS
STATE HIGHWAYS CORRECTED TO 2012
DIGITAL AERIAL PHOTOGRAPHY (DOOD)

GENERAL HIGHWAY MAP

PAWNEE COUNTY