

GENERAL HIGHWAY MAP
HOLT COUNTY
 SOUTH HALF
NEBRASKA
 PREPARED BY THE
 DEPARTMENT OF ROADS
 GIS/MAPPING SECTION
 IN COOPERATION WITH THE
 U.S. DEPARTMENT OF TRANSPORTATION
 FEDERAL HIGHWAY ADMINISTRATION

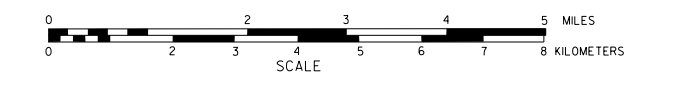

INVENTORY DATE:
2011

DATE	REVISION HISTORY
OCT 2006	CO. HWY. SURF.
MAY 2009	COUNTY
DEC 2011	COUNTY
AUG 2012	RENAMED CORP. LIMITS
JAN 2013	RENAMED 30 OF AVE 483 TO 11 OF RD 811
JAN 2013	RENMAN CORP. LIMITS

LEGEND

- | | |
|--|---|
| Primitive Road | Filing Station |
| Unimproved Road | Grain Elevator |
| Gravel or Crushed Road | Aggregate Pit |
| Asphalt/Bituminous Surface | Agricultural Experimental Station |
| Multiple Lane Undivided Highway | Educational Institutions |
| Asphalt/Bituminous Surface | Public Use Area |
| Concrete/Brick Surface | Recreational Facilities |
| Multiple Lane Divided Highway | Rest Area |
| Concrete/Brick Surface | Ranger Station |
| Gravel Highway | Fish Hatchery |
| Interstate Highway with Full Control of Access | Community Hall |
| Side Roads and Streets | Correctional Institution |
| 911 Dispatch/Numbered Roads | Tourist Court or Motel |
| Interstate-Numbered Highway | US-Numbered Highway |
| US-Numbered Highway | State-Numbered Highway |
| State-Numbered Highway | State-Numbered Highway Spur |
| State-Numbered Highway Spur | Fin-Station |
| Highway Reference Post Number | Museum |
| Interstate Exit Number | County Seat |
| Highway Reference Post Number | Artery |
| Interstate Exit Number | Post Office |
| Highway Reference Post Number | Highway Maintenance Ford |
| Highway Reference Post Number | State Boundary |
| Highway Reference Post Number | County Boundary |
| Highway Reference Post Number | Township Line |
| Highway Reference Post Number | Section Line |
| Highway Reference Post Number | Corporate Limits |
| Highway Reference Post Number | Parks and Other Reservations |
| Highway Reference Post Number | Boundary Lines of Area Shown in Enlargements (see enlargements for details) |
| Highway Reference Post Number | State Capital |
| Highway Reference Post Number | County Seat |
| Highway Reference Post Number | Other Cities and Villages |
| Highway Reference Post Number | Incorporated City or Village |
| Highway Reference Post Number | Triangulation Station |
| Highway Reference Post Number | Church or Other Religious Institution |
| Highway Reference Post Number | Points Between which Distances are Measured (indicated by "M") |
| Highway Reference Post Number | Latitude and Longitude |

LEGEND

- NATIONAL FUNCTIONAL CLASSIFICATION**
- INTERSTATE
 - OTHER FREEWAYS & EXPRESSWAYS
 - OTHER PRINCIPAL ARTERIALS
 - MINOR ARTERIAL
 - MAJOR COLLECTOR
 - MINOR COLLECTOR
 - URBANIZED BOUNDARY

All Roads Not Otherwise Indicated Are Classified As Local.
 FHWA Approval: May 28, 2015.

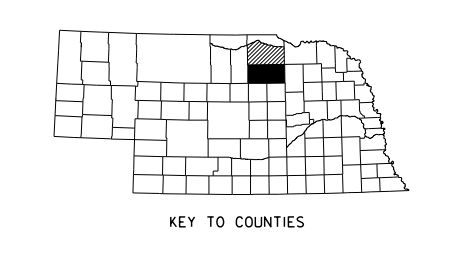

LAMBERT CONFORMAL CONIC PROJECTION
 1983 NORTH AMERICAN DATUM
 NEBRASKA COORDINATE SYSTEM

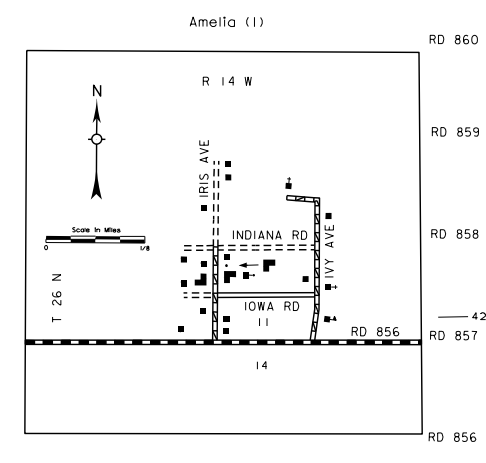
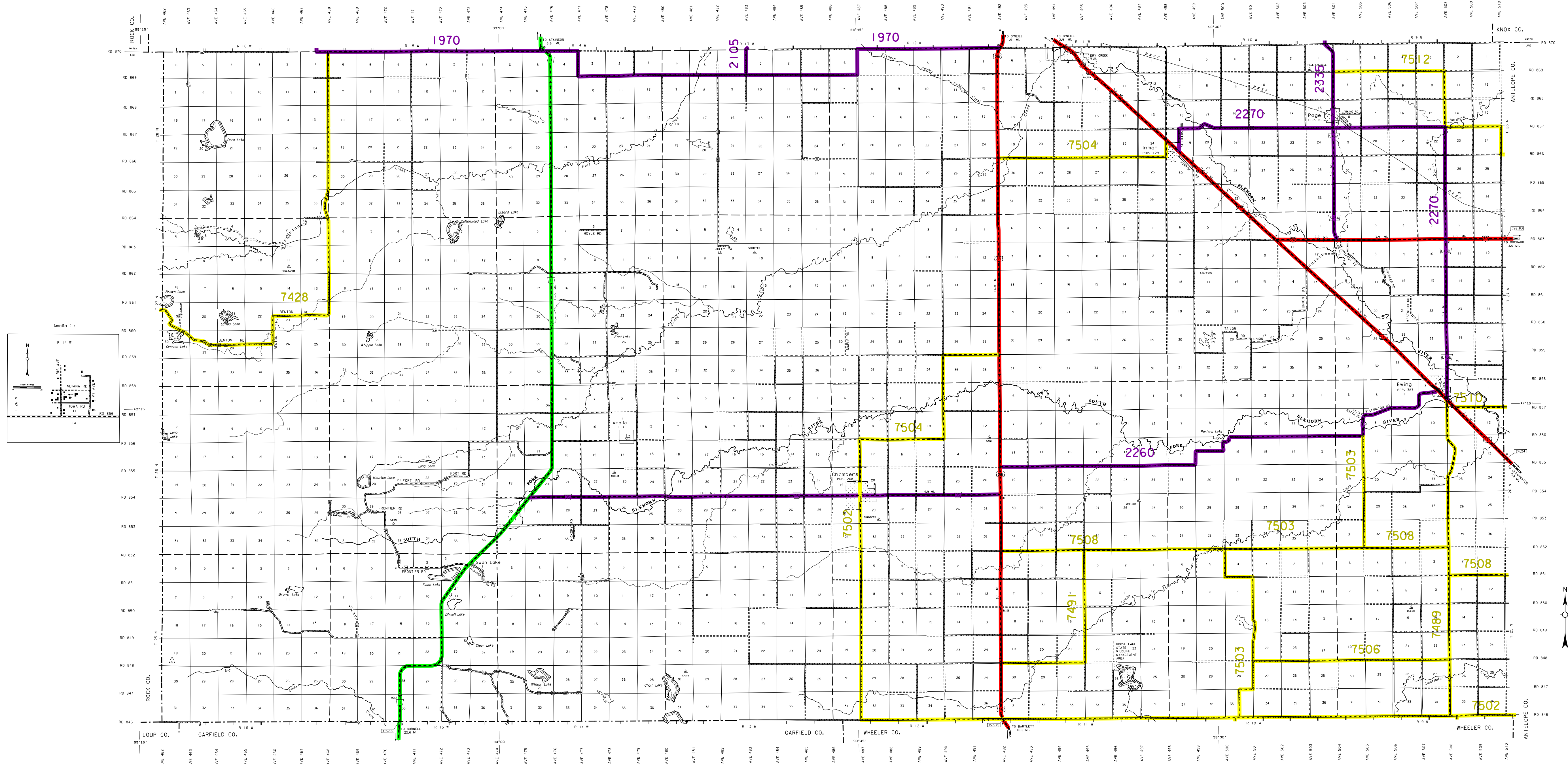

POPULATION AS OF 2010 CENSUS
 STATE BOUNDARIES CORRECTED TO 2011
 DIGITAL AERIAL PHOTOGRAPHY (DAIM) TAKEN IN 2007