

GENERAL HIGHWAY MAP GARDEN COUNTY NORTH HALF NEBRASKA

PREPARED BY THE
DEPARTMENT OF ROADS
GIS/MAPPING SECTION
IN COOPERATION WITH THE
U.S. DEPARTMENT OF TRANSPORTATION
FEDERAL HIGHWAY ADMINISTRATION
2015

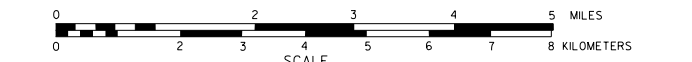

DATE	REVISION
FEBRUARY 2015	COUNTY SPLIT
JULY 2011	911 SYSTEM
OCTOBER 2013	REVISION '16 132 SEC 31/24 N 42 W / T 21 N
-	REVISION '16 138 SEC 14/18 N 42 W / T 23 N
-	REVISION '16 178 SEC 31/24 N 42 W / T 23 N
-	REVISION '16 178 SEC 31/24 N 42 W / T 22 N

LEGEND

- Primitive Road
- Unimproved Road
- Gravel or Crushed Rock
- Asphalt/Bituminous Surface
- Multiple Lane Undivided Highway
- Concrete/Bitum Surface
- Multiple Lane Undivided Highway
- Concrete/Bitum Surface
- Divided Highway
- Interstate Highway with Full Control of Access
- Interstate Highway with Partial Control of Access
- Side Roads and Streets
- State-Numbered Highway
- Interstate-Numbered Highway
- US-Numbered Highway
- State-Numbered Highway Spur
- State-Numbered Highway Link
- Highway Reference Post Number
- Interstate Exit Number
- Wide Stream
- Narrow Stream
- Irrigation Ditch
- Reservoir, Pond or Lake
- Reservoir, With Dam
- Highway Bridge-Any Type
- Small Bridge-Closely Spaced
- Towpath
- General Bridge
- Arch Bridge
- Truss Bridge
- Passerion Underpass
- Pedestrian Overpass
- Railroad Overpass
- Railroad Underpass
- Railroad
- Dam with Road on Top
- Dam
- Cattle Guard
- Dwelling
- Row of Dwellings
- Cemetery
- Church or Other Religious Institution
- Church with Cemetery Adjacent
- Hospital
- Business
- Industrial Plant
- Filling Station
- Grain Elevator
- Aggregate Pit
- Agricultural Experiment Station
- Educational Institutions
- Public Use Area
- State Wildlife Game Preserve
- Recreational Facility
- Rest Area
- Ranger Station
- Fish Hatchery
- Community Hall
- Correctional Institution
- Tourist Court or Motel
- Monument-Small
- Museum
- Firestation
- Courthouse
- Post Office
- Armory
- Highway Maintenance Yard
- Dump Area
- Water Supply Stand Pipe
- Radio or TV Station
- Weight Station or Port of Entry
- Comedor or Municipal Airport
- Airport with Paved Runway
- State Boundary
- County Boundary
- Township Line
- Section Line
- Corporate Limit Lines
- Parks and Other Reservations
- Boundary Limits of Area Shown in Other Documents
- State Capitol
- County Seat
- Other Cities and Villages
- Incorporated City or Village
- Transportation Station
- Points Between Which Distances Are Measured Indicated Thus
- Latitude and Longitude

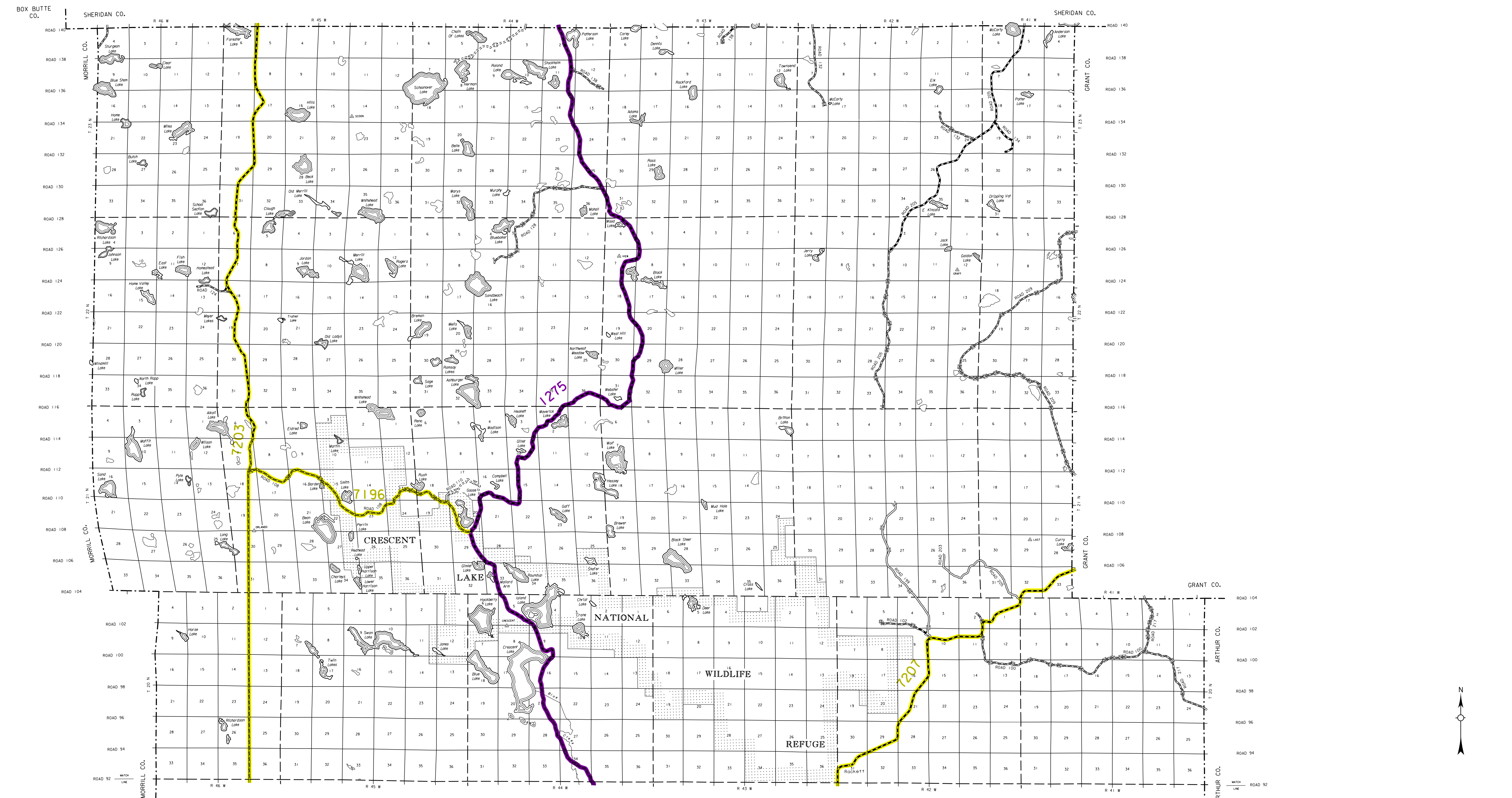

LEGEND

NATIONAL FUNCTIONAL CLASSIFICATION

- INTERSTATE
- OTHER FREEWAYS & EXPRESSWAYS
- OTHER PRINCIPAL ARTERIALS
- MINOR ARTERIAL
- MAJOR COLLECTOR
- MINOR COLLECTOR
- UNBARRICADED BOUNDARY

All Roads Not Otherwise Indicated Are Classified As Local.
FHWA Approval: May 28, 2015.

LAMBERT CONFORMAL CONIC PROJECTION
1983 NORTH AMERICAN DATUM
NEBRASKA COORDINATE SYSTEM

KEY TO COUNTIES

This map is to be used for information only and is not intended to show ownership or to be definitive on which roads are public under Nebraska Law. The Nebraska Department of Roads makes no warranties, quantities or representations for the accuracy of this information and assumes no liability for errors or omissions. Any inconsistencies should be referred to NDR.