

GENERAL HIGHWAY MAP
CHERRY COUNTY
 SOUTHWEST QUARTER
NEBRASKA
 PREPARED BY THE
 DEPARTMENT OF ROADS
 GIS/MAPPING SECTION
 IN COOPERATION WITH THE
 U.S. DEPARTMENT OF TRANSPORTATION
 FEDERAL HIGHWAY ADMINISTRATION
 2016

SCALE
 0 1 2 3 4 5 6 7 8 MILES
 0 1 2 3 4 5 6 7 8 KILOMETERS

REVISION HISTORY	
DATE	REVISION
OCTOBER 2014	NEW SUPERINTENDENT MAP
DECEMBER 2014	CORRECTED
DECEMBER 2015	SUPERINTENDENT REVIEW

LEGEND

- | | | | |
|----------------------------------------|-------|------------------------------------------------------------------------------|-------|
| Primitive Road | | Filling Station | |
| Unimproved Road | | Gran Elevator | |
| Gravel or Crushed Rock | | Aggregate Pit | |
| Asphalt/Bituminous Surface | | Agricultural Experiment Station | |
| Multiple Lane Undeveloped Highway | | Educational Institutions | |
| Asphalt/Bituminous Surface | | Public Use Area | |
| Concrete/Block Surface | | Recreation Areas (Swimming, Fishing, Hunting, etc.) | |
| Multiple Lane Undeveloped Highway | | Recreational Facilities | |
| Concrete/Block Surface | | Rest Area | |
| Divided Highway with Full | | Ranger Station | |
| Shoulder Access | | Plan Hatchery | |
| Side Roads and Streets | | Community Well | |
| State-Numbered Highway | | Correctional Institution | |
| ADAMS ROAD | | Tourist Court or Motel | |
| Interstate-Numbered Highway | | Monument-Small | |
| US-Numbered Highway | | Monument-Large | |
| State-Numbered Highway | | Musical | |
| State-Numbered Highway Spur | | Firestation | |
| State-Numbered Highway Link | | Courthouse | |
| Highway Reference Post Number | | Armory | |
| Interstate Exit Number | | Post Office | |
| Wide Stream | | Highway Maintenance Yard | |
| Narrow Stream | | Bump Area | |
| Irrigation (Open) | | Sewerage Disposal Plant | |
| Reservoir, Pond or Lake | | Water Supply Stand Pipe | |
| Reservoir with Dam | | Radio or TV Station | |
| Highway Bridge-Any Type | | Weight Station or Port of Entry | |
| Span Bridge-Closely Spaced | | Commodore or Municipal Airport | |
| Span Bridge-Widely Spaced | | Airport with Paved Runways | |
| General Bridge (Wood, Steel, Concrete) | | State Boundary | |
| Arch Bridge | | County Boundary | |
| Truss Bridge | | Township Line | |
| Pedestrian Overpass | | Corporate Limit Lines | |
| Pedestrian Overpass | | Parks and Other Reservations | |
| Railroad Overpass | | Boundary Limits of Area Shown in Photographs (See annotations for reference) | |
| Railroad Underpass | | State Capitol | |
| Railroad | | County Seat | |
| Dam with Road on Top | | Other Cities and Villages | |
| Cattle Guard | | Incorporated City or Village | |
| Dwelling | | Trigonulation Station | |
| Row of Dwellings | | Points Between Which Distances are Measured (Indicated True) | |
| Cemetery | | Latitude and Longitude | |
| Church or Other Religious Institution | | | |
| Church with Cemetery Adjacent | | | |
| Bus Stop | | | |
| Industrial Plant | | | |

LEGEND
NATIONAL FUNCTIONAL CLASSIFICATION

- | | |
|------------------------------|-------|
| INTERSTATE | |
| OTHER FREEWAYS & EXPRESSWAYS | |
| OTHER PRINCIPAL ARTERIALS | |
| MINOR ARTERIAL | |
| MAJOR COLLECTOR | |
| MINOR COLLECTOR | |
| URBANIZED BOUNDARY | |

All Roads Not Otherwise Indicated Are Classified As Local.
 FHWA Approval: May 28, 2015.

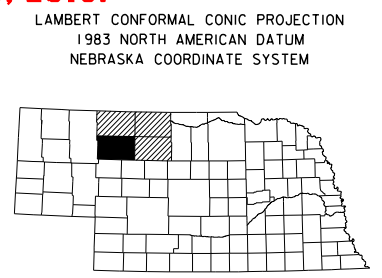

KEY TO COUNTIES
 This map is to be used for information only and is not intended to show boundaries of any kind. It is the responsibility of the user to verify the accuracy of any data, distances or representations for the purpose of this information and to assume the liability for any error or omission. Incorporations should be made as they occur.

GENERAL HIGHWAY MAP
CHERRY COUNTY
 NEBRASKA 16

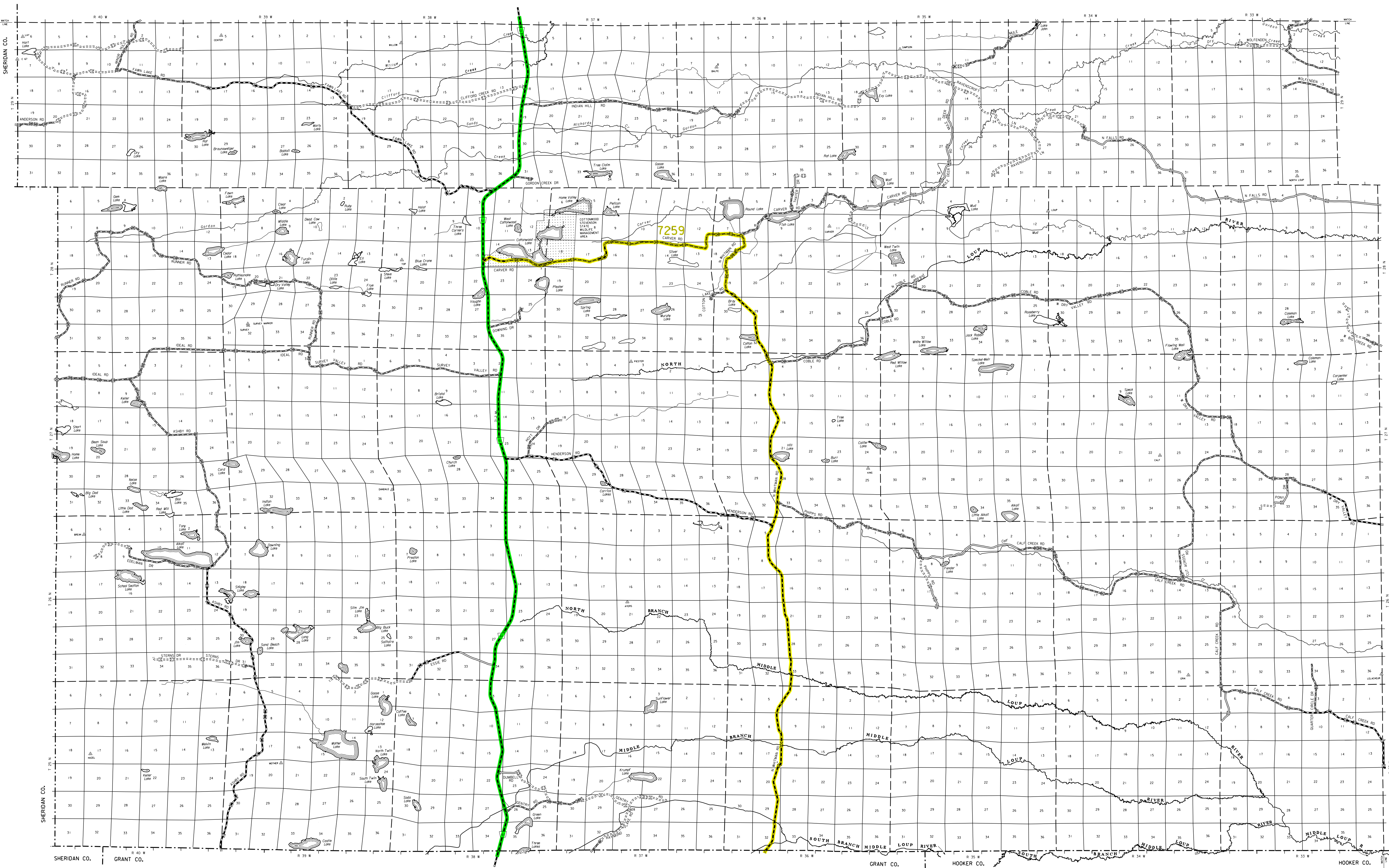

POPULATION AS OF 2010 CENSUS
 STATE HIGHWAYS CORRECTED TO 2014
 DIGITAL AERIAL PHOTOGRAPHY (DAP) TAKEN IN 2012