

GENERAL HIGHWAY MAP HOWARD COUNTY NEBRASKA

PREPARED BY THE
DEPARTMENT OF ROADS
GIS/MAPPING SECTION
IN COOPERATION WITH THE
U.S. DEPARTMENT OF TRANSPORTATION
FEDERAL HIGHWAY ADMINISTRATION
2014

SCALE
0 1 2 3 4 5 6 7 8 9 10
MILES
0 1 2 3 4 5 6 7 8 9 10
KILOMETERS

DATE	REVISION	HISTORY
2014	001	COOPERATIVE
NOV 2013	001	ELBA - CORPORATE LIMIT

LEGEND

Primitive Road	12251	Filling Station	12251
Unimproved Road	12252	Crane Elevator	12252
Gravel or Crushed Rock	12253	Aggregate Pile	12253
Asphalt/Bituminous Surface	12254	Agricultural Experimental Station	12254
Multiple Lane Undivided Highway	12255	Educational Institutions	12255
Asphalt/Bituminous Highway	12256	Public Use Area	12256
Concrete/Brick Surface	12257	Recreational Facilities	12257
Multiple Lane Divided Highway	12258	Road Area	12258
Concrete/Brick Highway	12259	Ranger Station	12259
Divided Highway with Full Control of Access	12260	Fish Hatchery	12260
Side Road and Street	12261	Community Hall	12261
90° KAREED-Numbered Road	12262	Correctional Institution	12262
Interstate-Numbered Highway	12263	Tourist Court or Motel	12263
US-Numbered Highway	12264	Monument-Small	12264
State-Numbered Highway	12265	Monument-Large	12265
State-Numbered Highway Spur	12266	Museum	12266
State-Numbered Highway Link	12267	Firestation	12267
Highway Reference Post Number	12268	Courthouse	12268
Interstate Exit Number	12269	Armory	12269
Wide Stream	12270	Post Office	12270
Narrow Stream	12271	Highway Maintenance Yard	12271
Irrigation Ditch	12272	Dumpy Area	12272
Reservoir, Pond or Lake	12273	Sewage Disposal Plant	12273
Reservoir, With Dam	12274	Water Supply Stand Pipe	12274
Highway Bridge-Any Type	12275	Radio or TV Station	12275
Small Bridges-Closely Spaced	12276	Regist Station or Port of Entry	12276
General Bridge-Closely Spaced	12277	Commercial or Municipal Airport	12277
Truss Bridge	12278	Airport with Paved Runways	12278
Arch Bridge	12279	State Boundary	12279
Railroad Overpass	12280	County Boundary	12280
Railroad Underpass	12281	Township Line	12281
Section Line	12282	Corporate Limit Lines	12282
Section Line	12283	Parks and Other Reservations	12283
Boundary Limits of Area Shown in Subsequent Maps	12284	Boundary Limits of Area Shown in Subsequent Maps	12284
State Capital	12285	State Capital	12285
County Seat	12286	County Seat	12286
Other City and Village	12287	Other City and Village	12287
Incorporated City or Village	12288	Incorporated City or Village	12288
Triangulation Station	12289	Triangulation Station	12289
Public Between Which Distance Are Measured Indicated Thus	12290	Public Between Which Distance Are Measured Indicated Thus	12290
Latitude and Longitude	12291	Latitude and Longitude	12291

LEGEND

STATE FUNCTIONAL CLASSIFICATION

INTERSTATE	Blue line
EXPRESSWAY	Brown line
MAJOR ARTERIAL	Red line
OTHER ARTERIAL	Green line
COLLECTOR	Purple line
REMOTE RESIDENTIAL (Rural Only)	Blue line
MINIMUM MAINTENANCE (Rural Only)	Orange line
SCENIC RECREATION (Rural Only)	Yellow line
URBANIZED BOUNDARY	Black dashed line

All Roads Not Otherwise Indicated Are Classified As Local
Updated June 30, 2017.

LAMBERT CONFORMAL CONIC PROJECTION
1983 NORTH AMERICAN DATUM
NEBRASKA COORDINATE SYSTEM

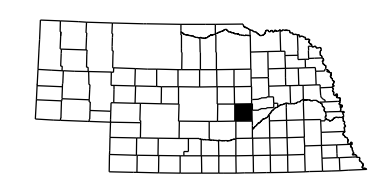

KEY TO COUNTIES

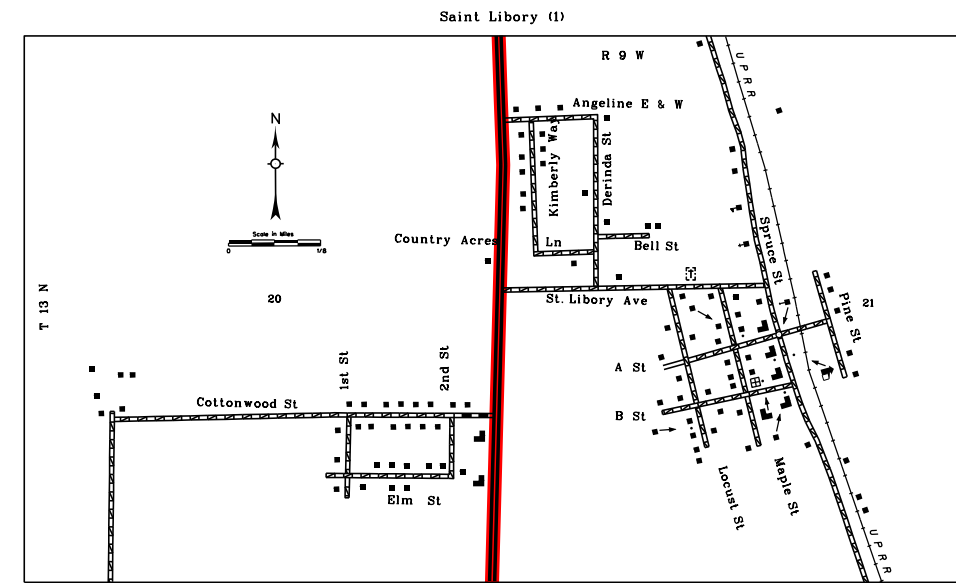
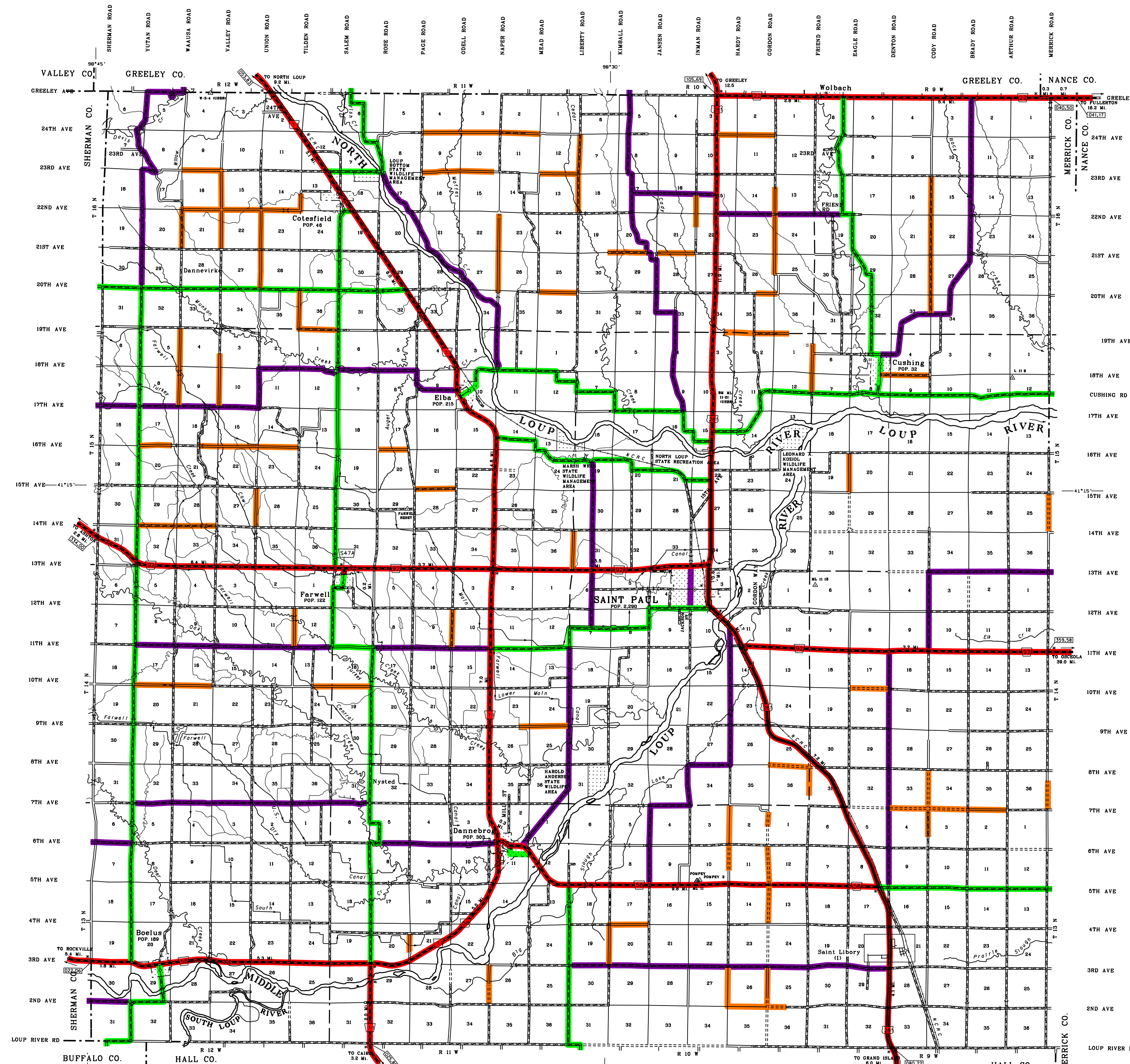

This map is to be used for information only and is not intended to show ownership or to be definitive on which roads are public or private. The Nebraska Department of Roads makes no warranties, guarantees or representations for the accuracy of this information and assumes no liability for errors or omissions. Any inaccuracies should be reported to NDOR.

POPULATION AS OF 2010 CENSUS
STATE HIGHWAYS CONNECTED TO 2014
DIGITAL AERIAL PHOTOGRAPHY 10000-TAKEN IN 2012