

GENERAL HIGHWAY MAP HARLAN COUNTY NEBRASKA

PREPARED BY THE
DEPARTMENT OF ROADS
GIS/MAPPING SECTION
IN COOPERATION WITH THE
U.S. DEPARTMENT OF TRANSPORTATION
FEDERAL HIGHWAY ADMINISTRATION

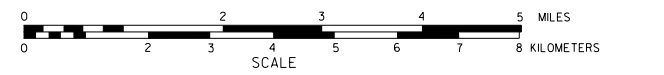

INVENTORY DATE:
2012

DATE	REVISION
MAY 2011	COUNTY SURVEY
DEC 2012	S. OF SOUTH ST. ALMA

LEGEND

Primitive Road	Filing Station
Unimproved Road	Grain Elevator
Gravel or Grumped Road	Aggregate Pit
Asphalt/Bituminous Surface	Agricultural Experimental Station
Multiple Lane Undivided Highway	Educational Institutions
Asphalt/Bituminous Surface	Public Use Area
Concrete/Gravel Surface	Recreational Facilities
Multiple Lane Divided Highway	State-Numbered Highway Spur
Interstate Highway with Full Control of Access	State-Numbered Highway Link
State Roads and Streets	Highway Reference Post Number
911 Numbered Roads	Interstate Exit Number
Interstate-Numbered Highway	Road Stream
US-Numbered Highway	Narrow Stream
State-Numbered Highway	Irrigation Ditch
State-Numbered Highway Spur	Reservoir, Pond or Lake
Freight Station	Reservoir with Dam
Courthouse	Highway Bridge-Any Type
Armory	Over 30 Feet
Post Office	Small Bridges: Closely Spaced
Highway Maintenance Yard	Medium Spaced
Bump Area	General Bridges: Widely Spaced
Sewage Disposal Plant	Arch Bridge
Water Supply Sand Pipe	Trauss Bridge
Road or Tr. Station	Pedestrian Overpass
Weight Station or Point of Entry	Pedestrian Overpass
Commercial or Municipal Airport	Railroad Overpass
Airport with Faxed Runways	Railroad Overpass
State Boundary	Railroad
County Boundary	Dam with Road on Top
Township Line	Cattle Guard
Section Line	Dwelling
Corporate Limit Lines	Row of Dwellings
Parks and Other Reservations	Cemetery
Boundary Lines of Area Shown in Enlargements	Church or Other Religious Institution
State Capital	Church with Cemetery Adjacent
County Seat	Hospital
Other Cities and Villages	Industrial Plant
Incorporated City or Village	Latitude and Longitude
Triangulation Station		
Points between which Distances are Measured		

LEGEND STATE FUNCTIONAL CLASSIFICATION

INTERSTATE
EXPRESSWAY
MAJOR ARTERIAL
OTHER ARTERIAL
COLLECTOR
REMOTE RESIDENTIAL (Rural Only)
MINIMUM MAINTENANCE (Rural Only)
SCENIC RECREATION (Rural Only)
URBANIZED BOUNDARY

All Roads Not Otherwise Indicated Are Classified As Local
Revised September 24, 2015

LAMBERT CONFORMAL CONIC PROJECTION
1983 NORTH AMERICAN DATUM
NEBRASKA COORDINATE SYSTEM

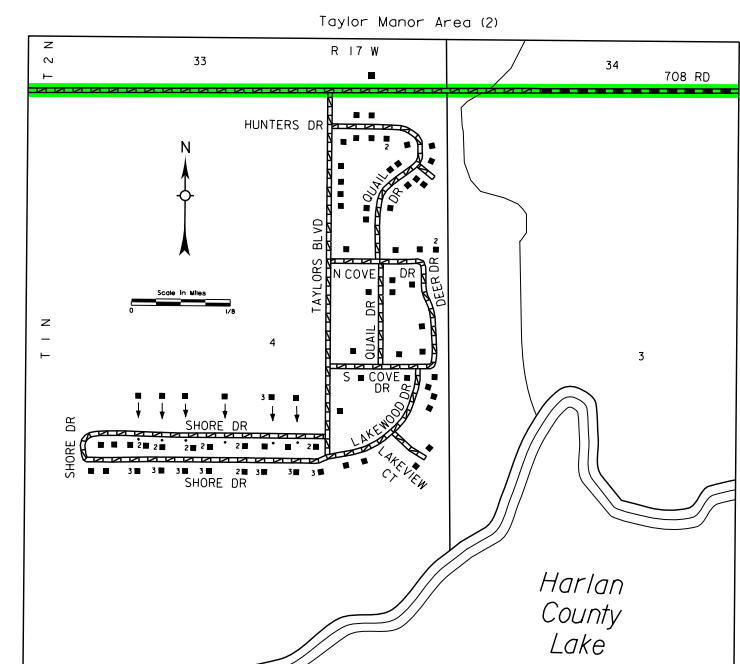
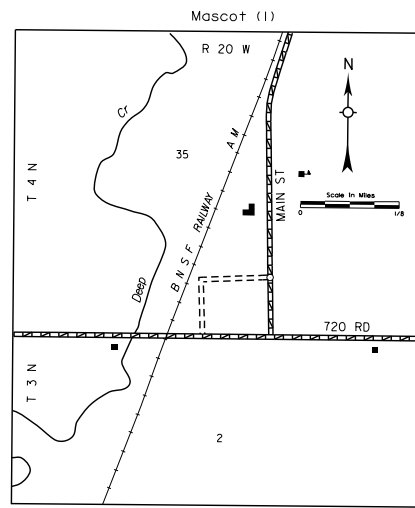
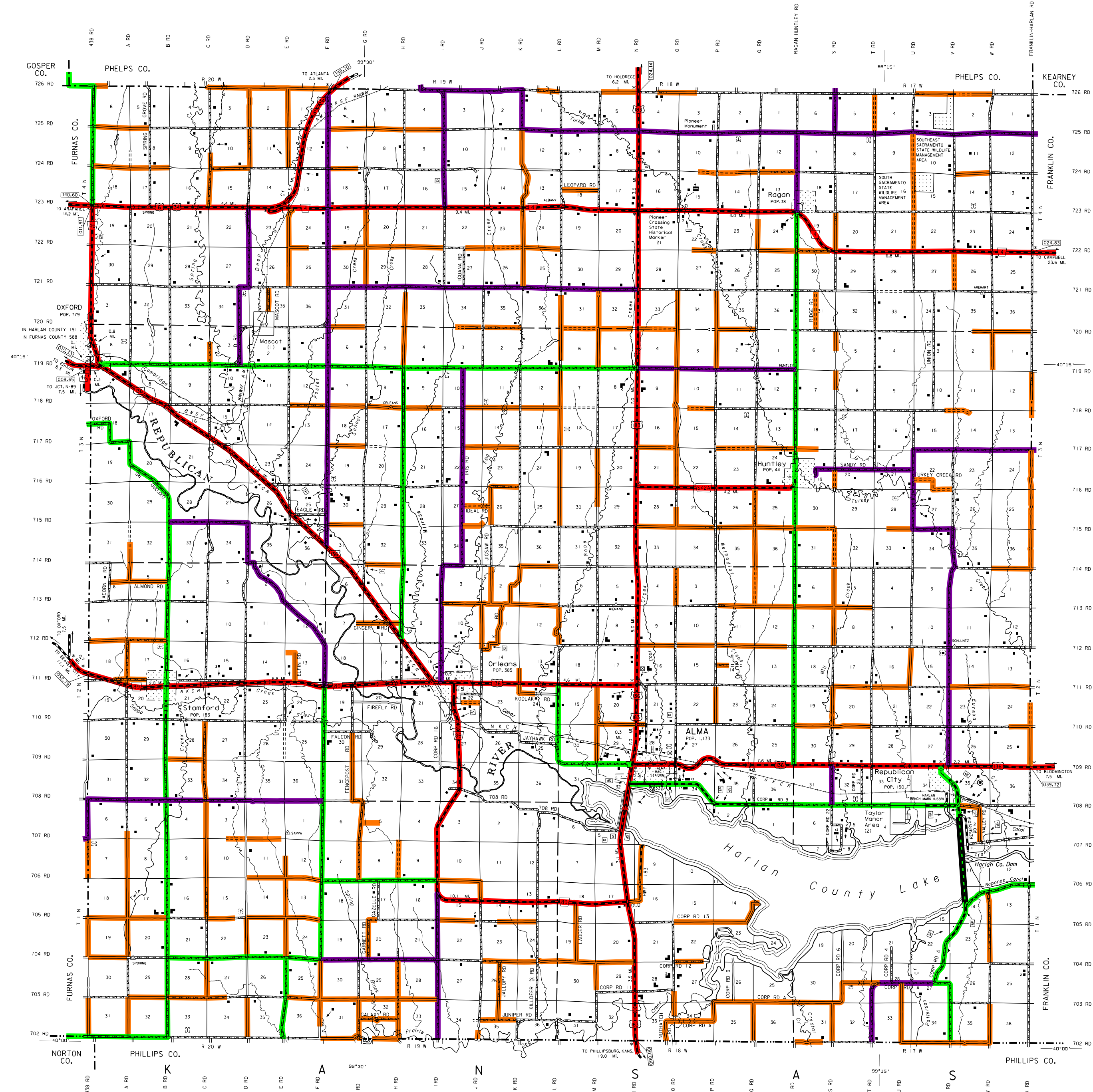
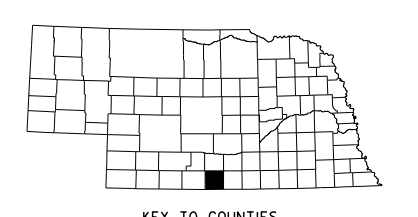

www.transportation.nebraska.gov

POPULATION AS OF 2010 CENSUS
STATE HIGHWAYS CORRECTED TO 2012
DIGITAL AERIAL PHOTOGRAPHY (DOAD) TAKEN IN 2010

This map is to be used for information only and is not intended to give bearings or to be definitive on which roads are public under Nebraska law. The Nebraska Department of Roads makes no warranty, guarantee or representation for the accuracy of this information and disclaims all liability for errors or omissions. Any inconsistencies should be reported to NDOR.

GENERAL HIGHWAY MAP

HARLAN COUNTY

NEBRASKA 42