

GENERAL HIGHWAY MAP GOSPER COUNTY NEBRASKA

PREPARED BY THE
DEPARTMENT OF ROADS
GIS/MAPPING SECTION
IN COOPERATION WITH THE
U.S. DEPARTMENT OF TRANSPORTATION
FEDERAL HIGHWAY ADMINISTRATION
2011

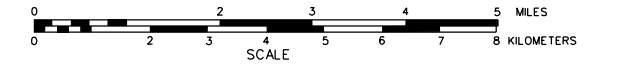

REVISION HISTORY	
DATE	REVISION
NOV. 2011	NET SUPERINTENDENT MAP
	COUNTY

LEGEND

Primitive Road	10001	Filling Station	10001
Unimproved Road	10002	Grain Elevator	10002
Gravel or Crushed Rock	10003	Aggregate Pit	10003
Asphalt/Bituminous Surface	10004	Agricultural Experimental Station	10004
Multiple Lane Undivided Highway	10005	Educational Institutions	10005
Asphalt/Bituminous Surface	10006	Public Use Area	10006
Concrete/Brick Surface	10007	Recreational Facility	10007
Multiple Lane Undivided Highway	10008	Rest Area	10008
Divided Highway	10009	Ranger Station	10009
Interstate Highway with Full Control of Access	10010	Fish Hatchery	10010
Side Roads and Streets	10011	Community Hall	10011
RD NUMBERED ROAD	10012	Correctional Institution	10012
Interstate-Numbered Highway	10013	Tourist Court or Motel	10013
State-Numbered Highway	10014	Monument (Small)	10014
State-Numbered Highway Spur	10015	Museum	10015
Highway Reference Point Number	10016	Fire Station	10016
Interstate Exit Number	10017	Courthouse	10017
Wide Stream	10018	Post Office	10018
Narrow Stream	10019	Highway Maintenance Yard	10019
Irrigation Ditch	10020	Dump Area	10020
Reservoir, Pond or Lake	10021	Storage Shovel Plant	10021
Reservoir With Dam	10022	Water Supply Stand Pipe	10022
Highway Bridge Any Type	10023	Radio or TV Station	10023
Small Bridge Closely Spaced	10024	Weight Station or Part of Entry	10024
Medium Bridge Closely Spaced	10025	Commercial or Municipal Airport	10025
General Bridge Closely Spaced	10026	Airport with Paved Runway	10026
Arch Bridge	10027	State Boundary	10027
Trauss Bridge	10028	County Boundary	10028
Pedestrian Overpass	10029	Township Line	10029
Railroad Overpass	10030	Section Line	10030
Railroad Underpass	10031	Corporate Limit Lines	10031
Dam with Road on Top	10032	Parks and Other Reservations	10032
Cattle Guard	10033	Boundary Limits of Area Shown in Different Colors on map	10033
Dwelling	10034	State Capital	10034
Row of Dwellings	10035	County Seat	10035
Church or Other Religious Institution	10036	Other Cities and Villages	10036
Church with Cemetery Adjacent	10037	Incorporated City or Village	10037
Cemetery	10038	Triangulation Station	10038
Hospital	10039	Points Between Which Distances Are Measured Indicated Thus	10039
Business	10040	Latitude and Longitude	10040
Industrial Plant	10041			

LEGEND

STATE FUNCTIONAL CLASSIFICATION	
INTERSTATE
EXPRESSWAY
MAJOR ARTERIAL
OTHER ARTERIAL
COLLECTOR
REMOTE RESIDENTIAL (Rural Only)
MINIMUM MAINTENANCE (Rural Only)
SCENIC RECREATION (Rural Only)
URBANIZED BOUNDARY

All Roads Not Otherwise Indicated Are Classified As Local
Revised December 7, 2017.

LANBERT CONFORMAL CONIC PROJECTION
1983 NORTH AMERICAN DATUM
NEBRASKA COORDINATE SYSTEM

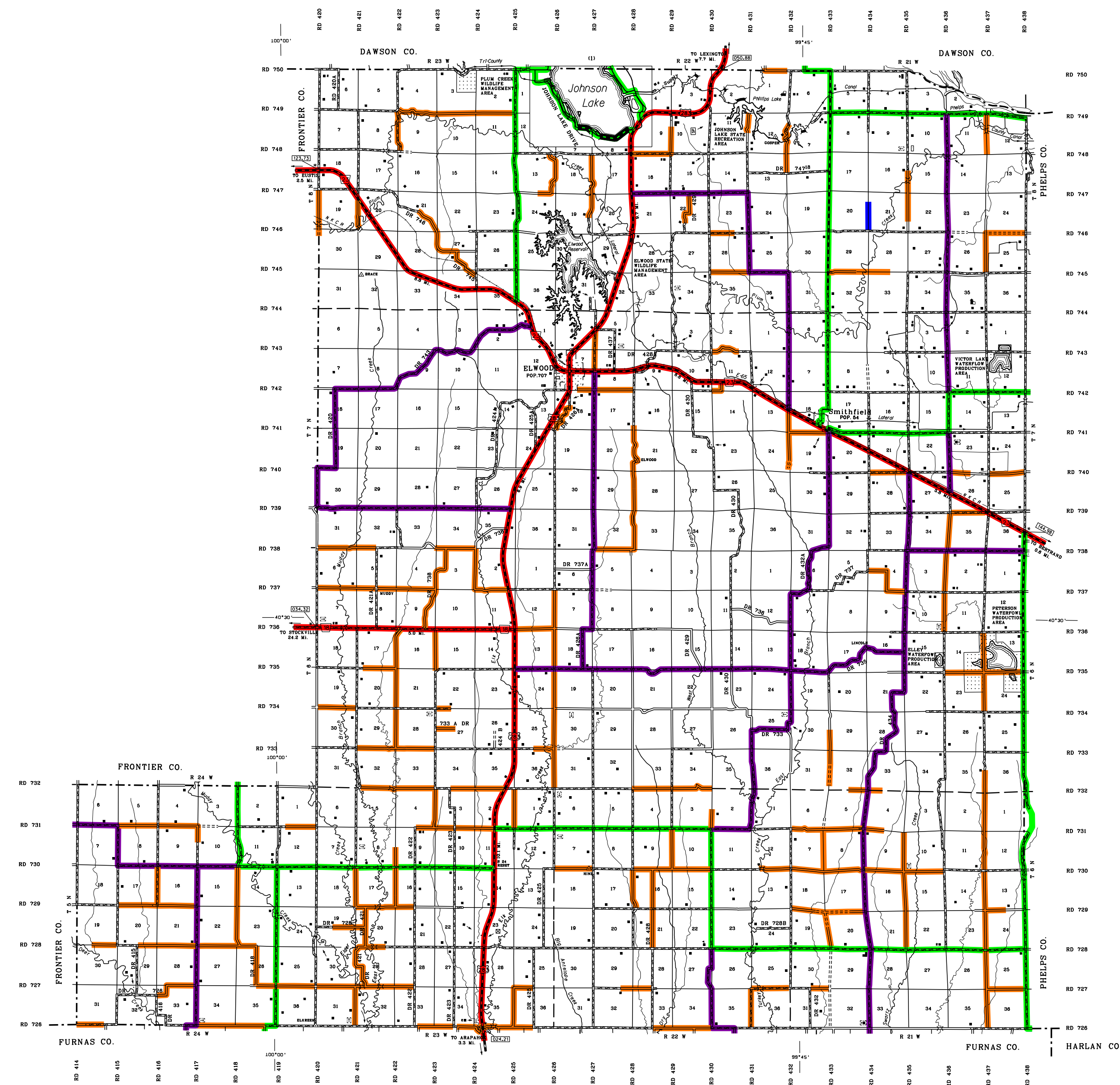
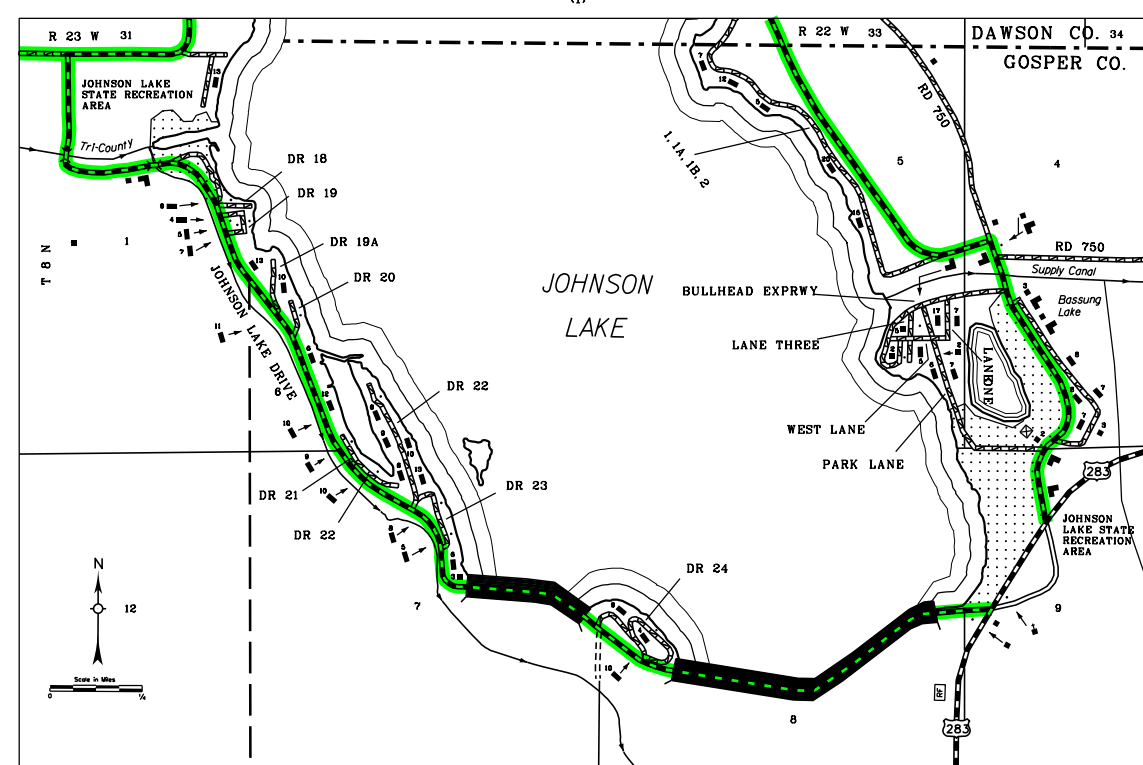
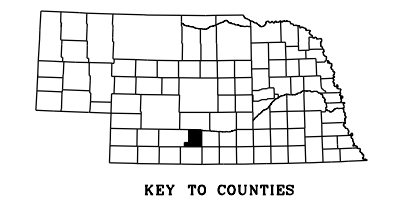

POPULATION AS OF 2010 CENSUS
STATE HIGHWAYS CONNECTED TO 2011
DIGITAL AERIAL PHOTOGRAPHY (DOADP)

This map is to be used for information only and is not intended to show ownership of the property on which roads are shown. The Nebraska Department of Roads makes no warranties, guarantees or representations for the accuracy of this information and assumes no liability for errors or omissions. Any inconsistencies should be reported to NDOR.