

GENERAL HIGHWAY MAP FILLMORE COUNTY NEBRASKA

PREPARED BY THE
DEPARTMENT OF ROADS
GIS/MAPPING SECTION
IN COOPERATION WITH THE
U.S. DEPARTMENT OF TRANSPORTATION
FEDERAL HIGHWAY ADMINISTRATION

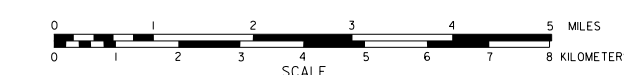

INVENTORY DATE:
2003

NAME	DATE	REVISION
L. COLSMITH	OCT 2000	111 SYSTEM
ELMER WILSON	SEP 2003	CO. RY SUPERINTENDENT (GM)
GLENN WILLIAMS	AUG 2004	COUNTY
AL GILGOSCHKE	DEC 2005	911 SYSTEM
M. MOORE	AUG 2009	REALIGNMENT OF RD #2355
R. BRADY	DEC 2009	FAHRENHEIT TO AUTOMATED UPDATE
	JAN 2013	EDIT CLUTTER & RD 17 & HWY 8

LEGEND

- Primitive Road
- Unimproved Road
- Gravel or Crushed Rock
- Asphalt/Bituminous Surface
- Mudstone, Unimproved Highway
- Asphalt/Bituminous Surface
- Concrete/Brick Surface
- Multilane Low speed highway
- Concrete/Brick Surface
- Gravel Highway
- Interstate Highway with Full Control of Access
- Side Roads and Streets
- 911 Numbered Roads
- Interstate-Numbered Highway
- US-Numbered Highway
- State-Numbered Highway
- State-Numbered Highway Spur
- State-Numbered Highway Link
- Highway Reference Post Number
- Interstate Exit Number
- Wide Street
- Narrow Stream
- Irrigation Ditch
- Reservoir, Pond or Lake
- Reservoir with Dam
- Highway Bridge Any Type
- Small Bridges Closely Spaced
- General Bridge
- Arch Bridge
- Truss Bridge
- Pedestrian Overpass
- Railroad Overpass
- Railroad
- Cattle Guard
- Dwelling
- Row of Dwellings
- Cemetery
- Church or Other Religious Institution
- Church with Cemetery Adjacent
- Hospital
- Business
- Industrial Plant
- Filling Station
- Grain Elevator
- Aggregate Pit
- Agricultural Experiment Station
- Education Institution
- Public Use Area
- Recreational Facilities
- Rest Area
- Ranger Station
- Fire Station
- Community Hall
- Correctional Institution
- Tourist Court or Motel
- Museum
- Firestation
- Courthouse
- Armory
- Post Office
- Highway Maintenance Yard
- Bump Area
- Sewage Disposal Plant
- Water Supply Stand Pipe
- Road or TV Station
- Weight Station or Port of Entry
- Commercial or Municipal Airport
- Airport with Paved Runways
- State Boundary
- County Boundary
- Township Line
- Section Line
- Corporate Limit Lines
- Parks and Other Reservations
- Boundary Limits of Area Shown in Enlargement
- State Capitol
- County Seat
- Other Cities and Villages
- Incorporated City or Village
- Triangulation Station
- Points Between Which Distances Are Measured Indicated Thus
- Latitude and Longitude

LEGEND

- ### STATE FUNCTIONAL CLASSIFICATION
- INTERSTATE
 - EXPRESSWAY
 - MAJOR ARTERIAL
 - OTHER ARTERIAL
 - COLLECTOR
 - REMOTE RESIDENTIAL (Rural Only)
 - MINIMUM MAINTENANCE (Rural Only)
 - SCENIC RECREATION (Rural Only)
 - URBANIZED BOUNDARY

All Roads Not Otherwise Classified Are Classified As Local
Revised June 30, 2014

LAMBERT CONFORMAL CONIC PROJECTION
805 NORTH AMERICAN DATUM
NEBRASKA COORDINATE SYSTEM

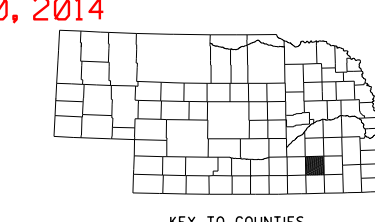

GENERAL HIGHWAY MAP

FILLMORE COUNTY NEBRASKA 30

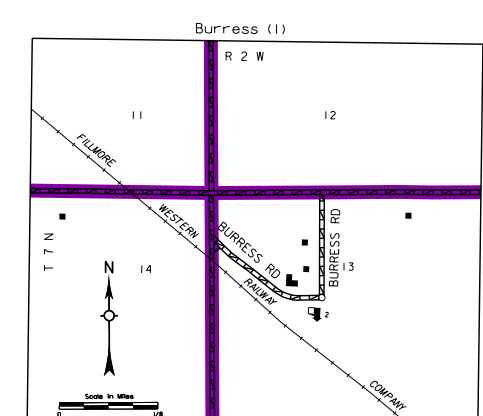
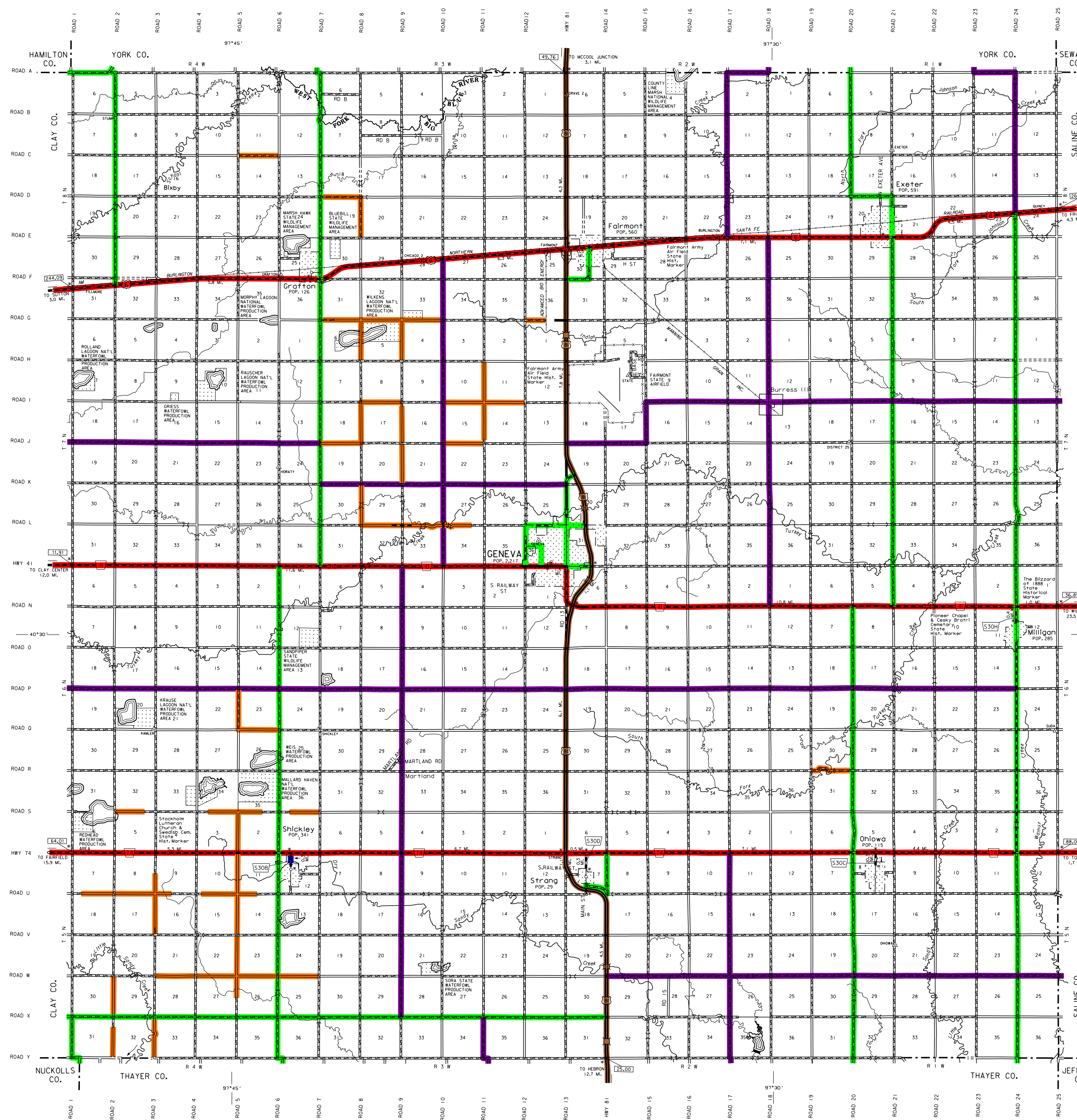

www.transportation.nebraska.gov

POPULATION AS OF 2010 CENSUS
STATE HIGHWAYS CORRECTED TO 2005
DIGITAL AERIAL PHOTOGRAPHY ©2005 TAKEN IN 1999

This map is to be used for information only and is not intended to be a substitute for a professional survey. The user assumes all liability for errors or omissions. Any inaccuracies should be reported to NDOR.