

# GENERAL HIGHWAY MAP CUSTER COUNTY NORTH HALF NEBRASKA

PREPARED BY THE  
DEPARTMENT OF ROADS  
GIS/MAPPING SECTION  
IN COOPERATION WITH THE  
U.S. DEPARTMENT OF TRANSPORTATION  
FEDERAL HIGHWAY ADMINISTRATION  
2005



NAME	DATE	REVISION
Arnold	7-22-05	111 SYSTEM
Broken Bow	7-22-05	111 SYSTEM
Westerville	7-22-05	111 SYSTEM
Assemo	7-22-05	111 SYSTEM

### LEGEND

- Primitive Road
- Unimproved Road
- Gravel or Crushed Rock
- Asphalt Bituminous Surface
- Multiple Lane undivided highway
- Asphalt Bituminous Surface
- Concrete/Asph. Surface
- Multiple Lane Divided Highway
- Interstate Highway with Full Control of Access
- State Road and Streets
- 911 NAMED/NUMBERED ROADS
- Interstate-Numbered Highway
- US-Numbered Highway
- State-Numbered Highway
- State-Numbered Highway Spur
- State-Numbered Highway Link
- Highway Reference Post Number
- Interstate Exit Number
- Wide Stream
- Narrow Stream
- Irrigation Ditch
- Reservoir, Pond or Lake
- Reservoir, With Dam
- Highway Bridge-Any Type
- Small Bridges-Closely Spaced
- General Bridge
- Arch Bridge
- Truss Bridge
- Pedestrian Overpass
- Railroad Overpass
- Railroad Underpass
- Railroad
- Dam with Road on Top
- Gate or Guard
- Dwelling
- Box of Dwellings
- Cemetery
- Church or Other Religious Institution
- Church with Cemetery Adjacent
- Healthier
- Business
- Industrial Plant
- Filling Station
- Grain Elevator
- Aggregate Pit
- Agricultural Experiment Station
- Educational Institutions
- Public Use Area
- Recreational Facilities
- Rest Area
- Plan Highway
- Ranger Station
- Community Hall
- Correctional Institution
- Tourist Court or Motel
- Monument-Shell
- Museum
- Firestation
- Garage
- Armory
- Post Office
- Highway Maintenance Yard
- Sewage Disposal Plant
- Water Supply Stand Pipe
- Railroad or TV Station
- Commercial or Municipal Airport
- Airport with Paved Runways
- State Boundary
- County Boundary
- Township Line
- Section Line
- Corporate Limit Lines
- Parks and Other Reservations
- Boundary Limits of Area Shown in Other Editions of this System for Other
- State Capital
- County Seat
- Other Cities and Villages
- Incorporated City or Village
- Triangulation Station
- Points Between Which Distances Are Measured Indicated This
- Latitude and Longitude

### LEGEND STATE FUNCTIONAL CLASSIFICATION

- INTERSTATE
- EXPRESSWAY
- MAJOR ARTERIAL
- OTHER ARTERIAL
- COLLECTOR
- REMOTE RESIDENTIAL (Rural Only)
- MINIMUM MAINTENANCE (Rural Only)
- URBAN RECREATION (Rural Only)
- SCENIC BOUNDARY

All Roads Not Otherwise Indicated Are Classified As Local  
Revised May 17, 2016

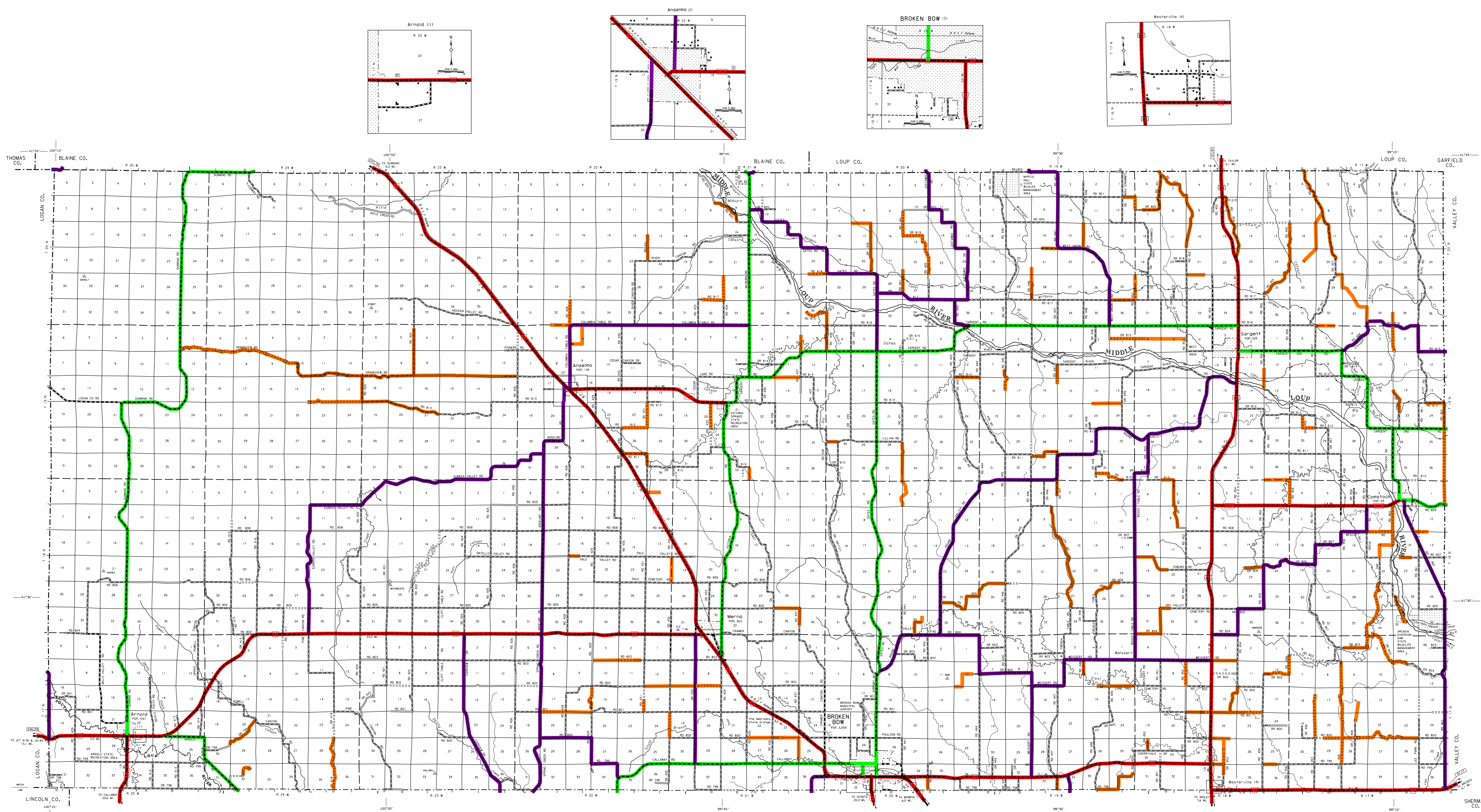
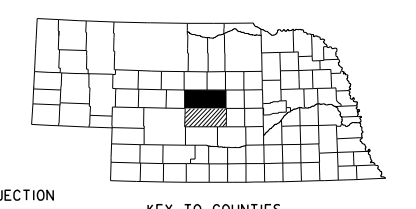

POPULATION AS OF 2010 CENSUS  
STATE HIGHWAYS CORRECTED TO 2007  
DIGITAL AERIAL PHOTOGRAPHY (DOOD)

This map is to be used for information only and is not intended to show ownership, nor to be used for any other purpose. It is not a warranty, representation, or endorsement for the accuracy of any information, and does not constitute an offer of insurance. Any inaccuracies should be reported to NDOR.

LAMBERT CONFORMAL CONIC PROJECTION  
1983 NORTH AMERICAN DATUM  
NEBRASKA COORDINATE SYSTEM

GENERAL HIGHWAY MAP

NORTH HALF  
CUSTER COUNTY  
NEBRASKA 21