

GENERAL HIGHWAY MAP SHERMAN COUNTY NEBRASKA

PREPARED BY THE
DEPARTMENT OF ROADS
GIS/MAPPING SECTION
IN COOPERATION WITH THE
U.S. DEPARTMENT OF TRANSPORTATION
FEDERAL HIGHWAY ADMINISTRATION
2005

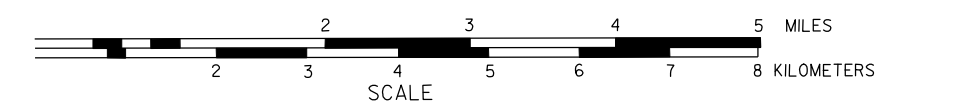

REVISION HISTORY			
NAME	DATE	REVISION	
S. FREDRICK	JAN. 2004	CO. HWY. SUFF.	
D. NELSON	NOV. 2005	COUNTY	
L. GOLDMITH	DEC. 2007	911 SYSTEM	

LEGEND

- Primitive Road.....
- Unimproved Road.....
- Gravel or Crushed Rock.....
- Asphalt/Bituminous Surface.....
- Multiple Lane Undivided Highway.....
- Asphalt/Bituminous Surface.....
- Concrete/Brick Surface.....
- Multiple Lane Undivided Highway.....
- Concrete/Brick Surface.....
- Divided Highway.....
- Interstate Highway with Full Control of Access.....
- Side Roads and Streets.....
- 911 Numbered Roads.....
- Interstate-Numbered Highway.....
- US-Numbered Highway.....
- State-Numbered Highway.....
- State-Numbered Highway Spur.....
- State-Numbered Highway Link.....
- Highway Reference Post Number.....
- Interstate Exit Number.....
- Wide Stream.....
- Narrow Stream.....
- Irrigation Ditch.....
- Reservoir, Pond or Lake.....
- Reservoir, With Dam.....
- Highway Bridge-Any Type (over 20 spans).....
- Small Bridges-Closely Spaced (spanners indicate the spans and bridges or groups).....
- General Bridge (wood, steel, concrete).....
- Arch Bridge.....
- Truss Bridge.....
- Pedestrian Underpass.....
- Pedestrian Overpass.....
- Railroad Underpass.....
- Railroad Overpass.....
- Dam with Road on Top.....
- Cattle Guard.....
- Dwelling.....
- Row of Dwellings.....
- Cemetery.....
- Church or Other Religious Institution.....
- Church with Cemetery Adjacent.....
- Hospital.....
- Business.....
- Industrial Plant.....
- Filling Station.....
- Grain Elevator.....
- Aggregate Pile.....
- Agricultural Experiment Station.....
- Educational Institutions.....
- Public Use Area.....
- Recreational Facilities.....
- Rest Area.....
- Ranger Station.....
- Community Hall.....
- Correctional Institution.....
- Tourist Court or Motel.....
- Monument-Small.....
- Museum.....
- Firestation.....
- Courthouse.....
- Armory.....
- Post Office.....
- Highway Maintenance Yard.....
- Dump Area.....
- Sewage Disposal Plant.....
- Water Supply Stand Pipe.....
- Radio or TV Station.....
- Weight Station or Port of Entry.....
- Commercial or Municipal Airport.....
- Airport with Paved Runways.....
- State Boundary.....
- County Boundary.....
- Township Line.....
- Section Line.....
- Corporate Limit Lines.....
- Parks and Other Reservations.....
- Boundary Limits of Area Shown in Enlargements (see enlargements for details).....
- State Capital.....
- County Seat.....
- Other Cities and Villages.....
- Incorporated City or Village.....
- Triangulation Station.....
- Points Between Which Distances Are Measured Indicated Thus.....
- Latitude and Longitude.....

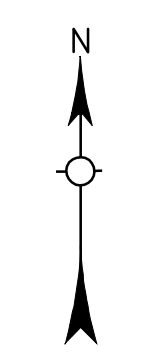
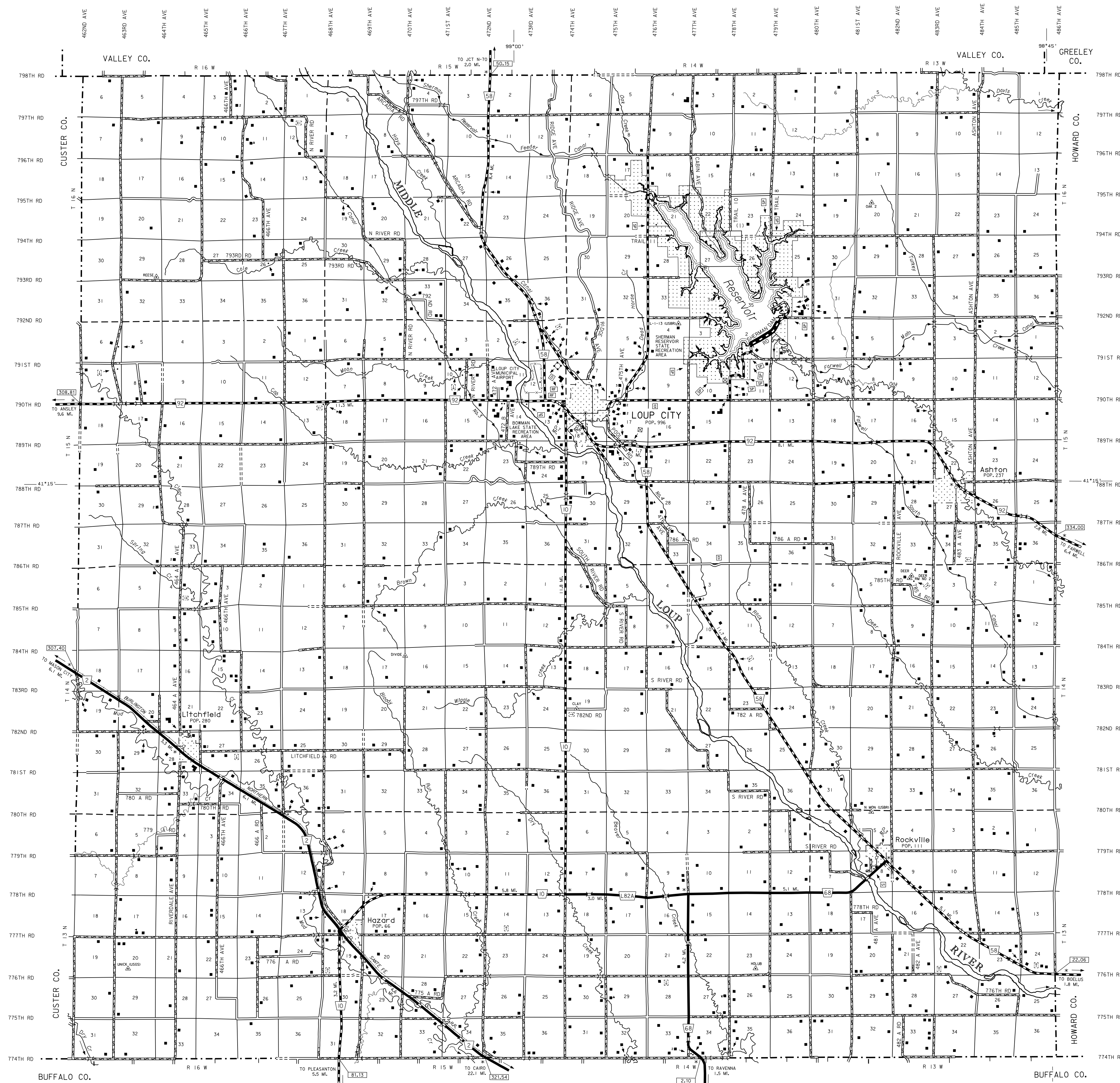
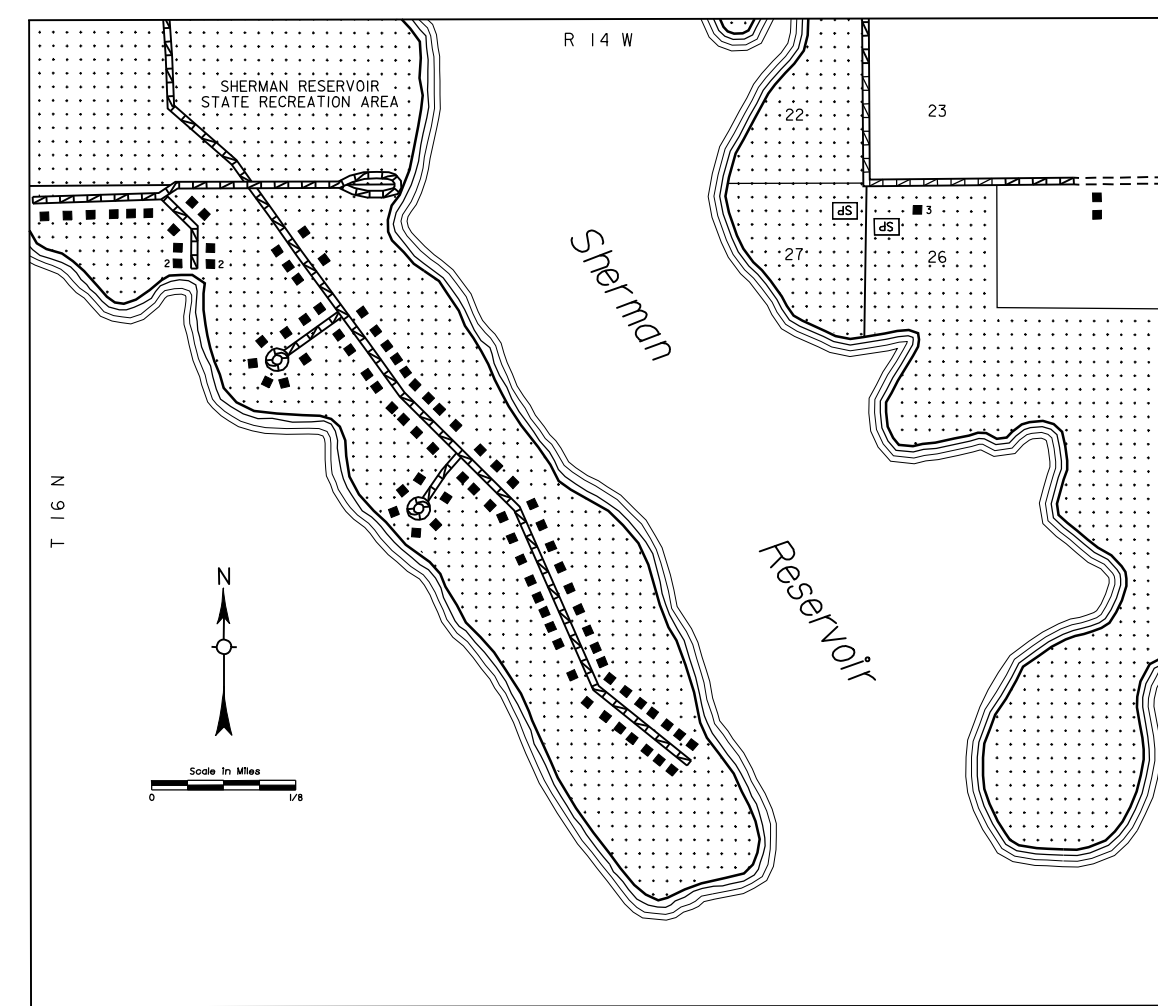

LAMBERT CONFORMAL CONIC PROJECTION
1983 NORTH AMERICAN DATUM
NEBRASKA COORDINATE SYSTEM

