

HOLDREGE

PHELPS COUNTY
NEBRASKA
POPULATION 5,495 (2010 CENSUS)
2013

R 18 W

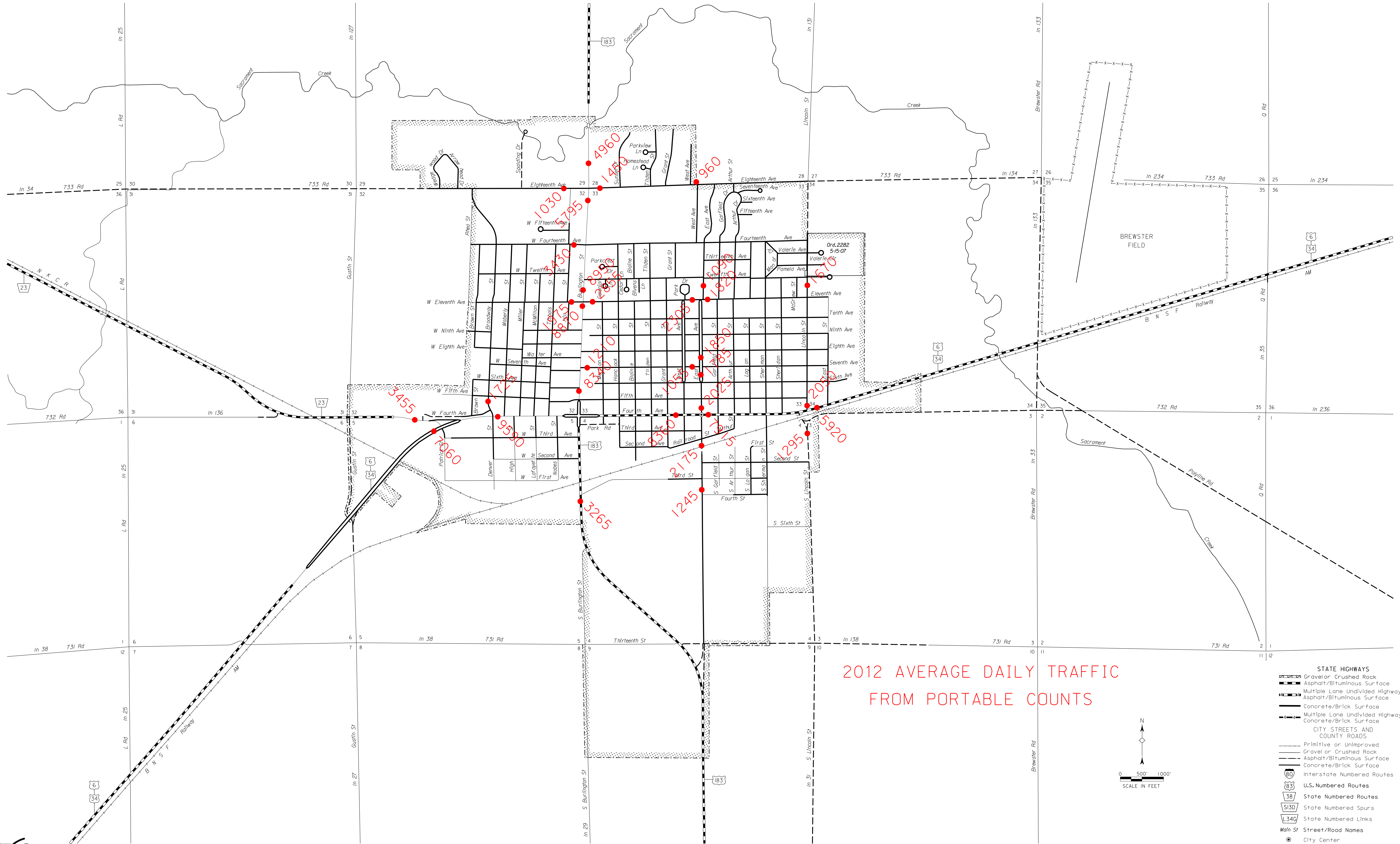

2012 AVERAGE DAILY TRAFFIC
FROM PORTABLE COUNTS

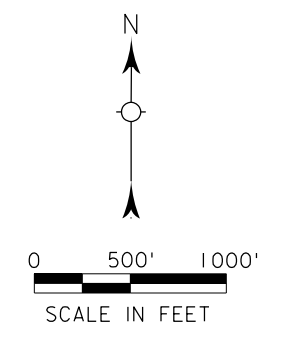

- STATE HIGHWAYS**
 - Gravel or Crushed Rock
 - Asphalt/Bituminous Surface
 - Multiple Lane Undivided Highway
 - Asphalt/Bituminous Surface
 - Concrete/Brick Surface
 - Multiple Lane Undivided Highway
 - Concrete/Brick Surface
- CITY STREETS AND COUNTY ROADS**
 - Primitive or Unimproved
 - Gravel or Crushed Rock
 - Asphalt/Bituminous Surface
 - Concrete/Brick Surface
- Interstate Numbered Routes** (80)
- U.S. Numbered Routes** (183)
- State Numbered Routes** (38)
- State Numbered Spurs** (S130)
- State Numbered Links** (L34C)
- Street/Road Names**
- City Center**
- Corporate Limits**

CORPORATE LIMITS AS OF 2013
STATE HIGHWAYS CORRECTED TO 2010

This map is to be used for information only and is not intended to show ownership or to be definitive on which road intended under Nebraska Law. The Nebraska Department of Roads and its employees, agents or representatives for the accuracy of this information and assume no liability for errors or omissions. Any inconsistencies should be reported to NDRR.

