

SEWARD

SEWARD COUNTY
NEBRASKA
POPULATION 6,964 (2010 CENSUS)
2012
R 3 E

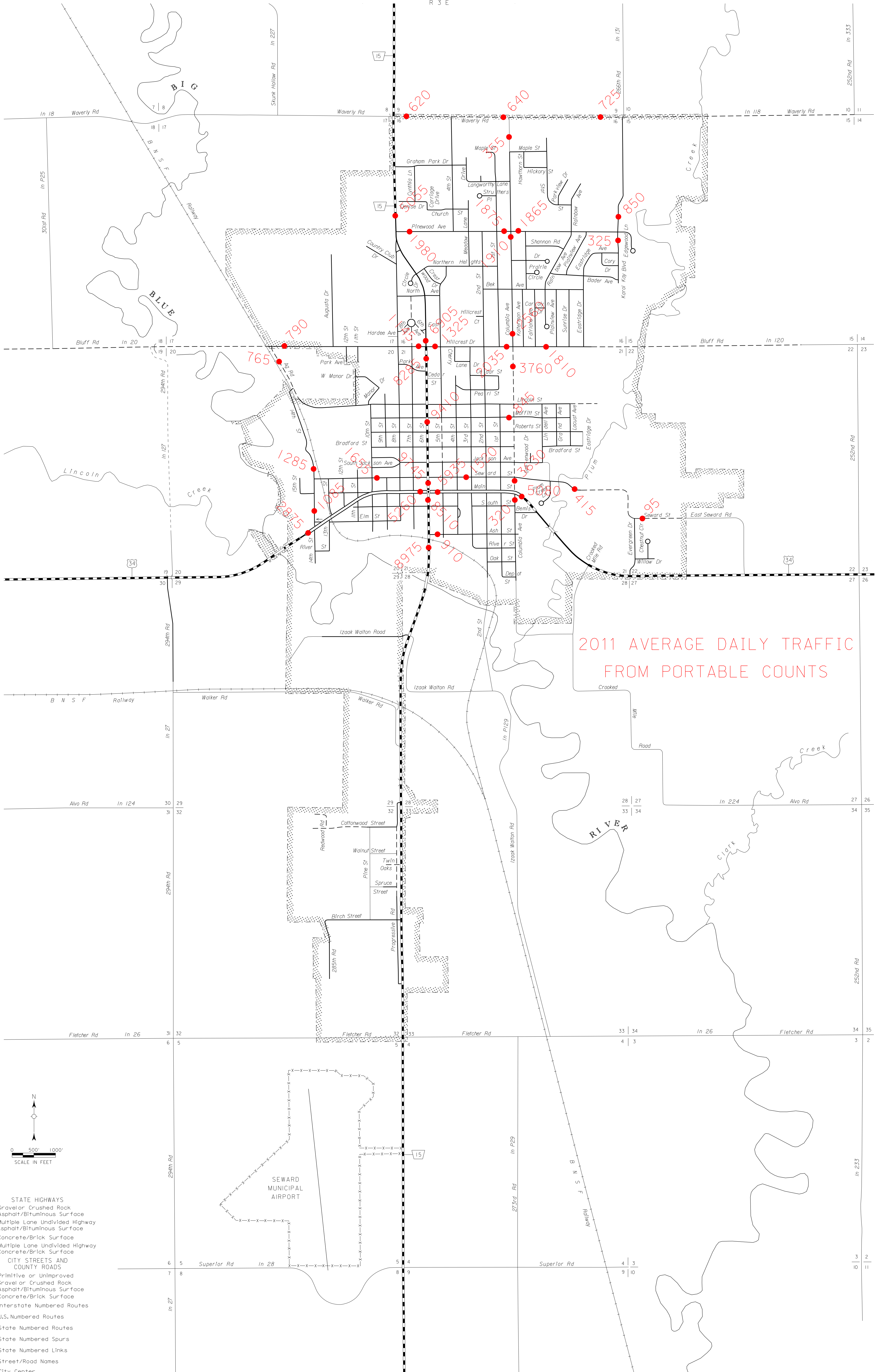

2011 AVERAGE DAILY TRAFFIC
FROM PORTABLE COUNTS

- STATE HIGHWAYS
 - Gravel or Crushed Rock
 - Asphalt/Bituminous Surface
 - Multiple Lane Undivided Highway
 - Asphalt/Bituminous Surface
 - Concrete/Brick Surface
 - Multiple Lane Undivided Highway
 - Concrete/Brick Surface
- CITY STREETS AND COUNTY ROADS
 - Primitive or Unimproved
 - Gravel or Crushed Rock
 - Asphalt/Bituminous Surface
 - Concrete/Brick Surface
- Interstate Numbered Routes (80)
- U.S. Numbered Routes (63)
- State Numbered Routes (38)
- State Numbered Spurs (S30)
- State Numbered Links (L340)
- Street/Road Names (Main St)
- City Center (●)
- Corporate Limits (dotted line)

CORPORATE LIMITS AS OF 2012
STATE HIGHWAYS CORRECTED TO 2011