

NEBRASKA

Good Life. Great Journey.

DEPARTMENT OF TRANSPORTATION

District 6 Headquarters
1321 North Jeffers St
PO Box 1108
North Platte, NE 69103-1108
Phone (308) 535-8031 Fax (308) 535-8034
dot.nebraska.gov



Pete Ricketts, Governor

FOR IMMEDIATE RELEASE

Temporary Closure on Eastbound I-80 Exit 102 near Big Springs

October 18, 2019 (North Platte, Neb.) — Weather permitting, the I-80 eastbound Exit 102 will close October 21, according to the Nebraska Department of Transportation.

Interstate Highway Construction Inc., of Englewood, Colorado is performing the work on the \$44,560,793 project. The work includes reconstructing I-80 and I-76, including the I-80/I-76 junction.

A marked detour will take eastbound motorists needing to exit westbound to I-80 Exit 107, the Big Springs interchange. The temporary detour is anticipated to last until mid-November. The eastbound Exit 102 closure and detour is part of the on-going road construction project, Big Springs West.

Motorists are reminded to drive cautiously in and near construction zones, selected detours, and to expect delays.

#NDOT#

Contact:

Josh R. Willard, North Platte, (308) 535-8031

Attachment:

Detour Map

NR10-zl- 61566



I-80 WB DETOUR PLAN

EXIT 102: I-76/I-80 INTERCHANGE

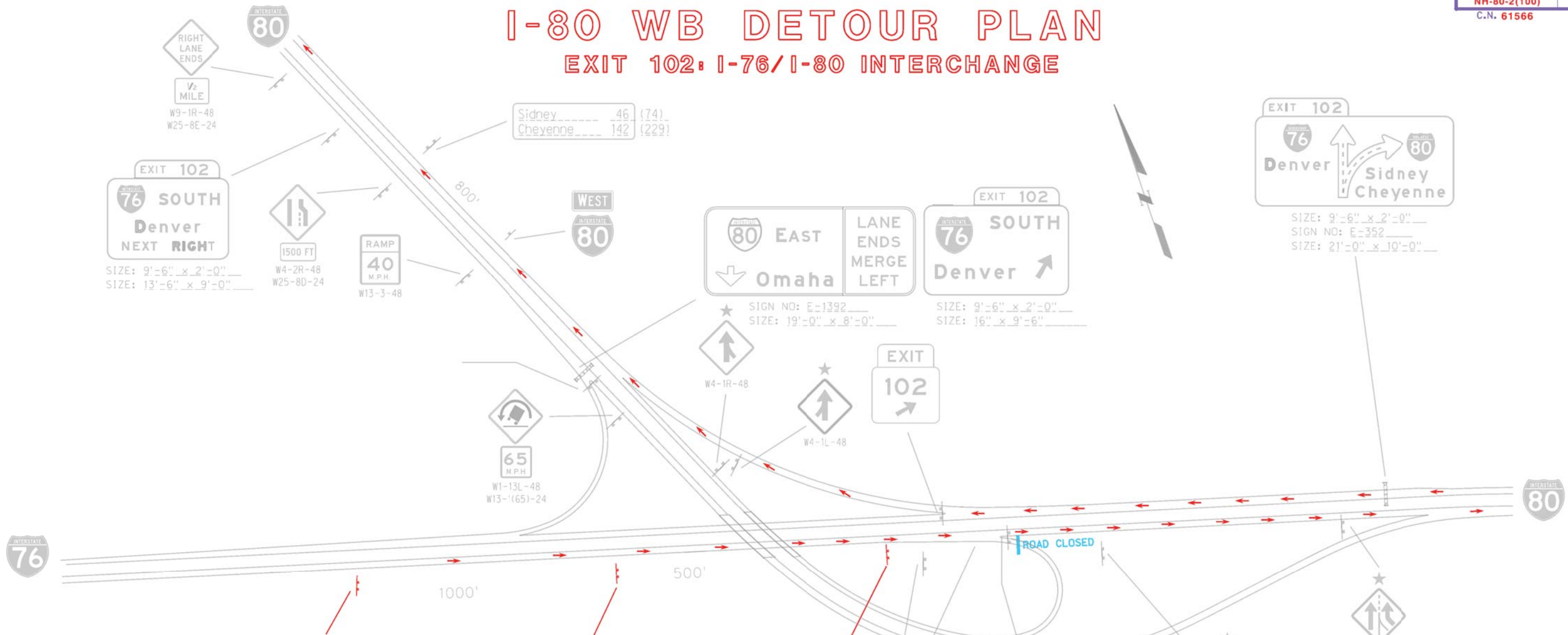

WEST

ON-RAMP

CLOSED

USE MARKED DETOUR

TS-988

- LEGEND**
- FLASHING ARROW PANEL
 - TYPE III BARRICADE
 - REFLECTORIZED PLASTIC DRUM
 - 42" REFLECTORIZED CONE OR REFLECTORIZED PLASTIC DRUM
 - PORTABLE DYNAMIC MESSAGE SIGN
 - SIGN
 - DOUBLE POSTED SIGN
 - REMOVE EXISTING PAVEMENT MARKINGS
 - DETOUR DIRECTION OF TRAVEL

NOTES:

- FOR PLACARD SIGN DETAILS SEE PAGE 3

SIGN SPACINGS ARE APPROXIMATE AND MAY BE ADJUSTED TO MATCH FIELD CONDITIONS

EXIT 102

80 EAST

Omaha

80 WEST

Sidney

RAMP 30 MPH

ENDS

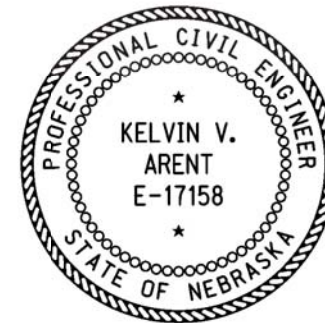

SIGNING PLAN		
JUNCTION <u>I-80 & I-76, EXIT 102</u>		
4 MILES WEST OF BIG SPRINGS		
SIGN PROJECT NO(S)	CONSTRUCTION NO(S)	INTERSECTION NO./REFERENCE POST
	NH-80-2(100) CN 61566	INT: 25064 I-80: 102±59 I-76: 3±15
DATE DRAWN	DATE PRINTED	DGNSPEC

DATE OF PRINTING: 08/14/2018
SCALE: 1/8"=1'-0"
NAME: KVA

I-80 WB DETOUR PLAN

EXIT 107: BIG SPRINGS EXIT

DETAIL A

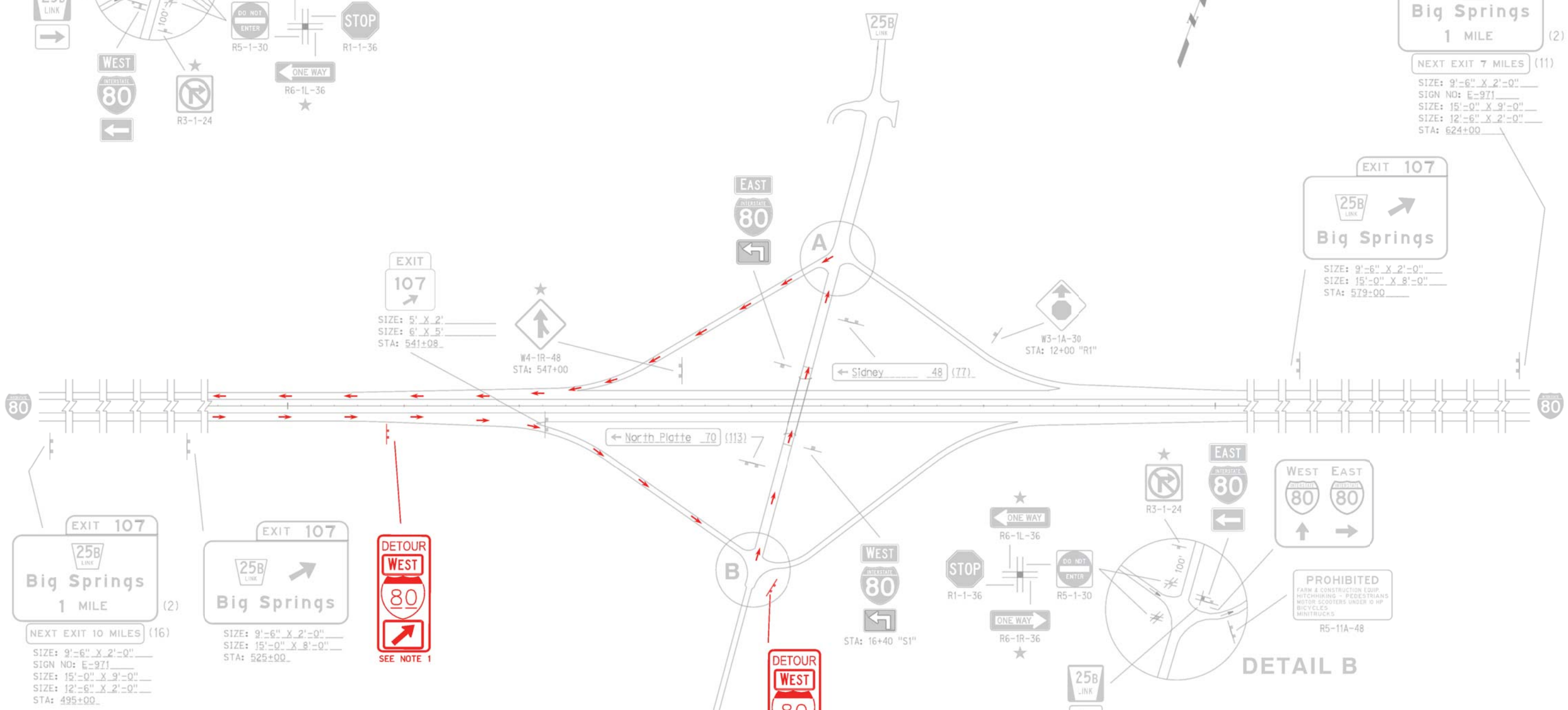
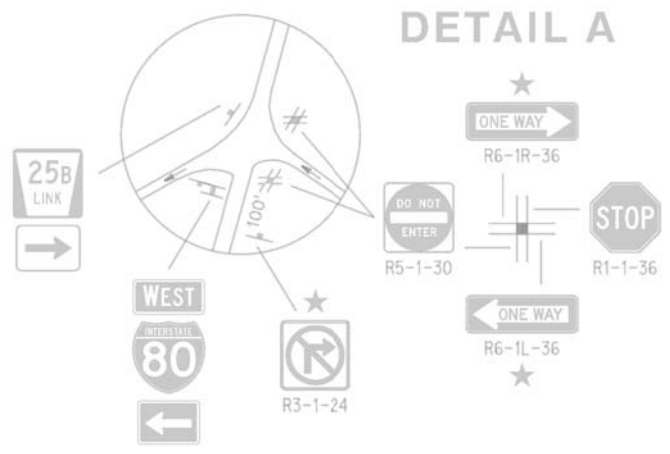

DETAIL B

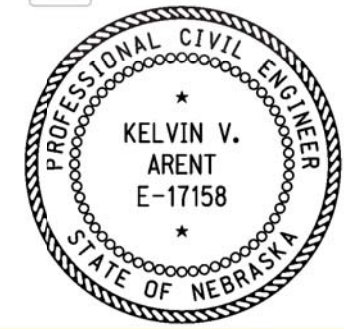

SIGNING PLAN		
JUNCTION I-80 & L-25B		
EXIT 107 (BIG SPRINGS)		
SIGN PROJECT NO(S)	CONSTRUCTION NO(S)	INTERSECTION NO./REFERENCE POST
		I-80:107+36
		INT:25065 L-25B:00+16
DATE DRAWN	DATE PRINTED DATE:*****	DGNSPEC*****

DATE OF PRINTING DATE:*****
SCALE:*****
NAME:*****

- LEGEND**
- FLASHING ARROW PANEL
 - TYPE III BARRICADE
 - REFLECTORIZED PLASTIC DRUM
 - 42" REFLECTORIZED CONE OR REFLECTORIZED PLASTIC DRUM
 - PORTABLE DYNAMIC MESSAGE SIGN
 - SIGN
 - DOUBLE POSTED SIGN
 - REMOVE EXISTING PAVEMENT MARKINGS
 - DETOUR DIRECTION OF TRAVEL

NOTES:

- FOR PLACARD SIGN DETAILS SEE PAGE 3

SIGN SPACINGS ARE APPROXIMATE AND MAY BE ADJUSTED TO MATCH FIELD CONDITIONS

COUNTY ROAD