

NEBRASKA

Good Life. Great Journey.

DEPARTMENT OF TRANSPORTATION

District 5 Headquarters
140375 Rundell Road
PO Box 220
Gering, NE 69341-0220
Phone (308) 436-6587 Fax (308) 633-6614
dot.nebraska.gov



Pete Ricketts, Governor

FOR IMMEDIATE RELEASE

Intersection Closures on US-26, Scottsbluff to Minatare

September 20, 2019 (Gering, Neb.) — Weather permitting, road closures will be in place beginning September 24 on US-26, between Scottsbluff and Minatare, according to the Nebraska Department of Transportation.

Simon Contractors Inc., of Cheyenne, Wyoming, has the \$3.6 million contract. Work will include waterproofing the pavement and asphalt overlay. Anticipated completion is late fall 2019.

The first closure will take place at L-79E, and access to US-26 will be restricted, but access to Kelley Bean Company from the south on L-79E will be maintained. The designated detour route is N-71 and N-92.

The second closure will take place on N-71 at US-26 and access to US-26 will be restricted. Beet harvest traffic will be coordinated by Western Sugar. Access to US-26 from S. Beltline Highway will be restricted during these closures. The designated detour route is N-92 and L-79E near Minatare and Melbeta.

Each closure phase is expected to last two days. Closures will take place on different days.

Motorists are asked to drive cautiously in and near construction zones, selected detour routes and to expect delays.

#NDOT#

Contact:

Maryanne Jacobs, Gering, (308) 436-6587

NR9-zm-51507

Attachment:

Detour maps



SCOTTS BLUFF / MINATARE

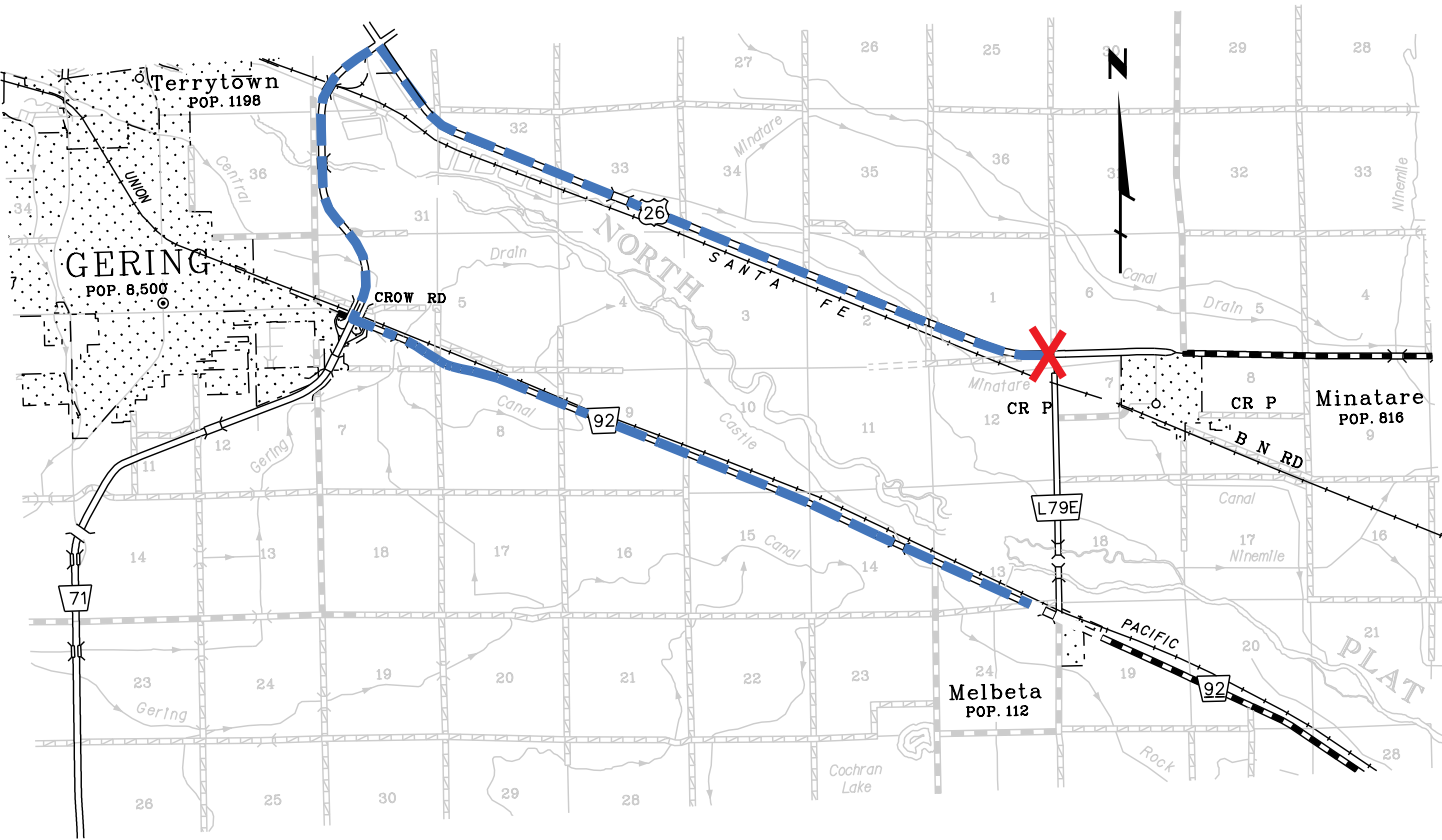

ROAD CLOSURE **X**

DETOUR **---**

26-1(167)

C.N. 51507

EXHIBIT "A"

SCOTTS BLUFF / MINATARE

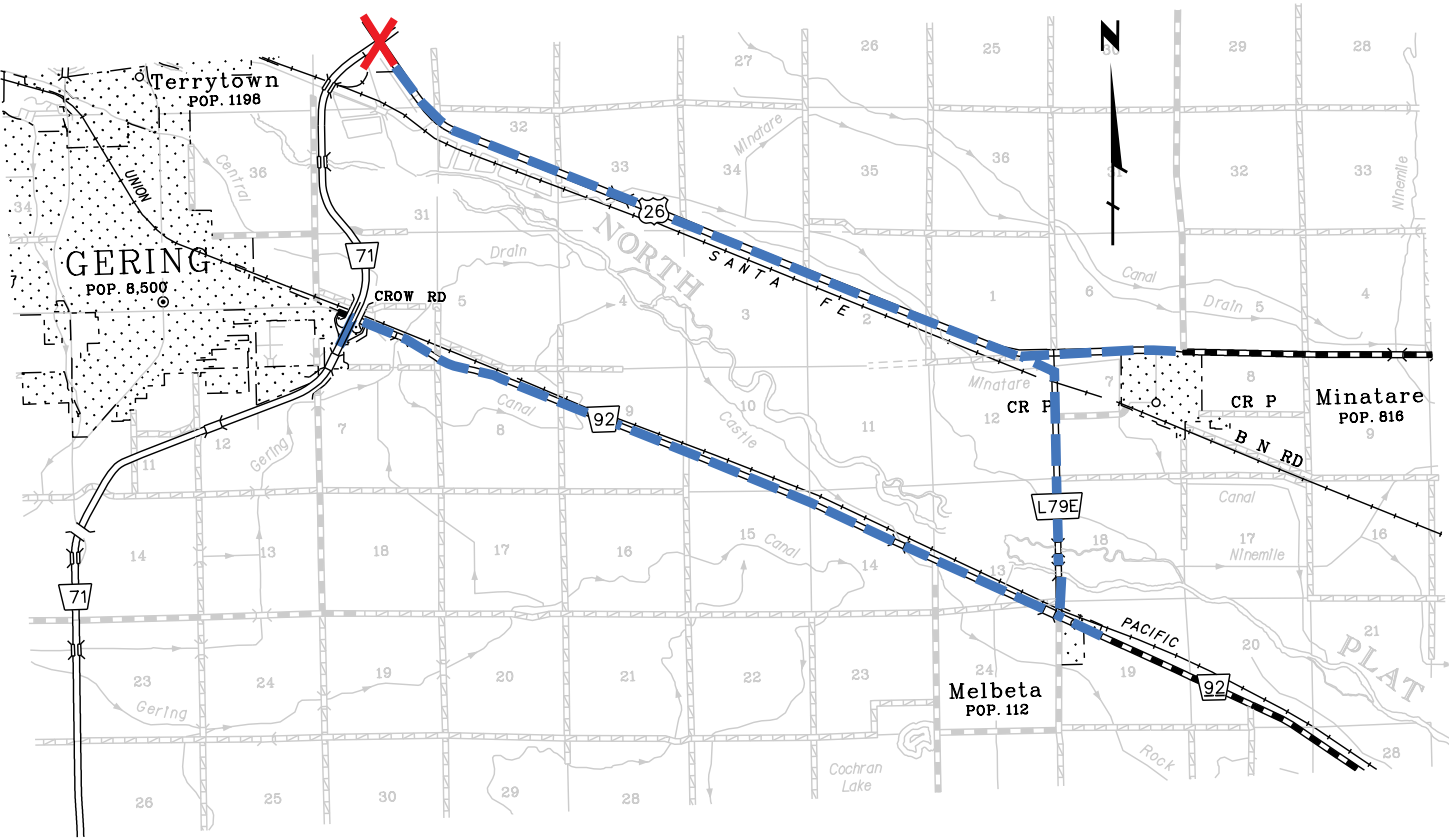

ROAD CLOSURE **X**

DETOUR **---**

26-1(167)

C.N. 51507

EXHIBIT "B"