

# NEBRASKA

Good Life. Great Journey.

**DEPARTMENT OF TRANSPORTATION**

District 1 Headquarters  
302 Superior Street  
Lincoln, NE 68521-2481  
Phone (402) 471-0850  
Fax (402) 471-3401  
dot.nebraska.gov



Jim Pillen, Governor

**FOR IMMEDIATE RELEASE**

## **Work Will Begin on N-50/N-8, From Pawnee City to the Kansas State Line**

January 17, 2023 (Lincoln, Neb.) — Weather permitting, work will begin January 23 on N-50/N-8, according to the Nebraska Department of Transportation.

Hawkins Construction Co. of Omaha, NE is the prime contractor for this project. Work includes bridges, culverts, grading, seeding, and guardrail. The project begins on the east edge of Pawnee City and continues through Dubois, Nebraska to the Kansas State Line.

Traffic will be maintained with normal two-lane/two-way traffic until March 20, 2023, when the roadway will be closed from the N-8 junction north of Dubois, south to the Kansas State Line to facilitate bridge and culvert work. The designated detour route will be from the N-8 junction north of Dubois, to the US-77 interchange, US-77 to Kansas US-36. N-50 will remain open to local traffic from the Kansas State Line to the N-8 junction during the bridge and culvert construction operations to allow access to the designated detour. A local detour will be in place in this area, on county roads to allow for local property owners access to their properties. Temporary traffic signals will be used at the bridge construction site, three miles north of the N-8 junction north of Dubois, Nebraska.. Flaggers and pilot cars will be used at various locations on the project. Anticipated is the end of 2023 construction season. Please see attached detour maps.

Motorists are reminded to drive cautiously in and near work zones, to buckle up, and to put phones down.

#NDOT#

**Contact:**

Mike Habegger, (402) 335-4131

20230117-D1



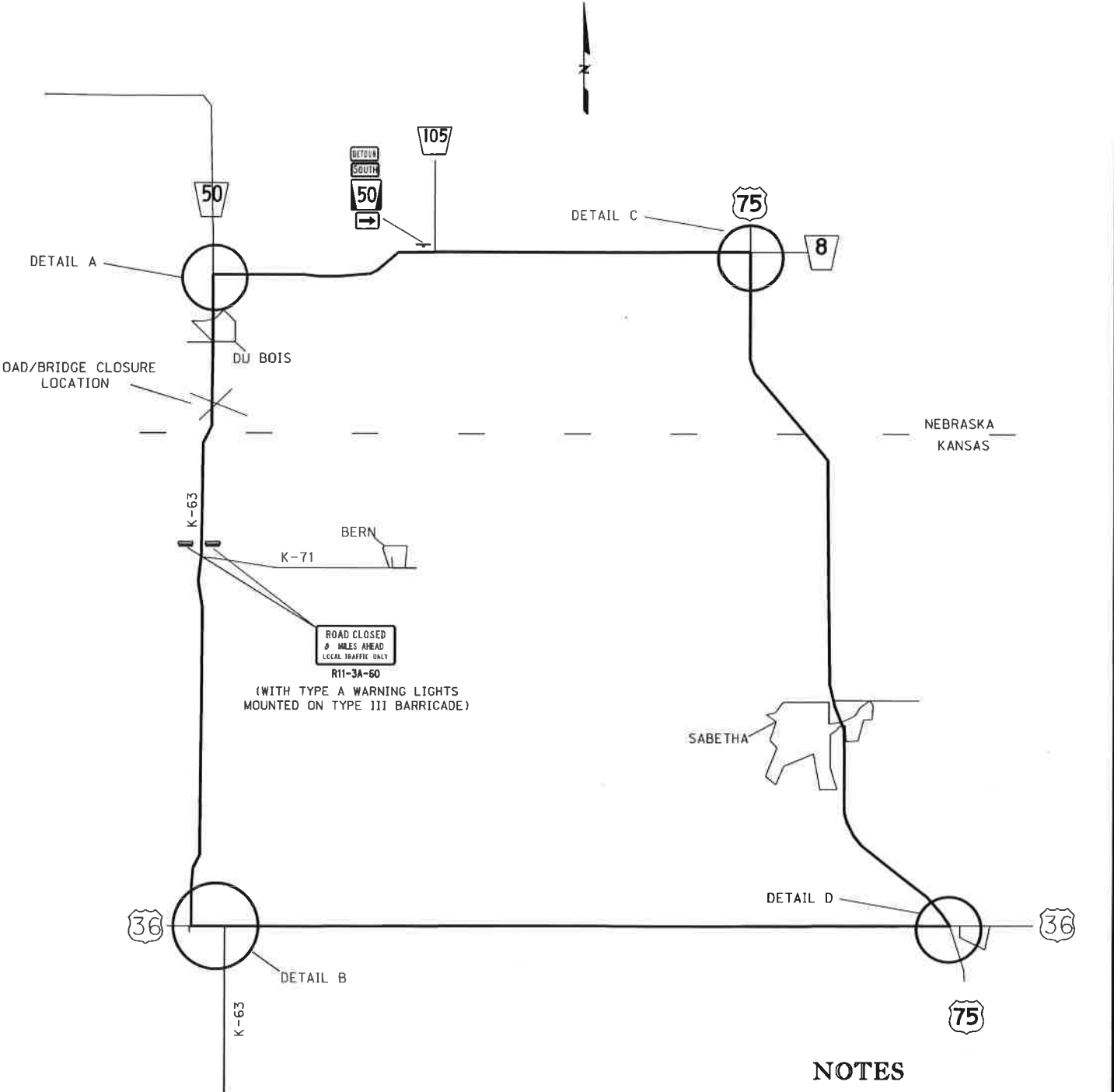

**NOTES**

SEE STANDARD PLAN 923 "TRAFFIC CONTROL CLOSURE" FOR DETAILS NOT SHOWN

NEBRASKA DEPARTMENT OF TRANSPORTATION TRAFFIC ENGINEERING DIVISION			
DETOUR PLAN			
DESIGNED	LCD	PAWNEE CITY SOUTHEAST	
REVIEWED			
APPROVED	DATE DRAWN	TRAFFIC ENGINEER	DATE
	12/22		

# PAWNEE CITY SOUTHEAST BRIDGES

PAWNEE COUNTY  
NEBRASKA

R 11 E

R 12 E

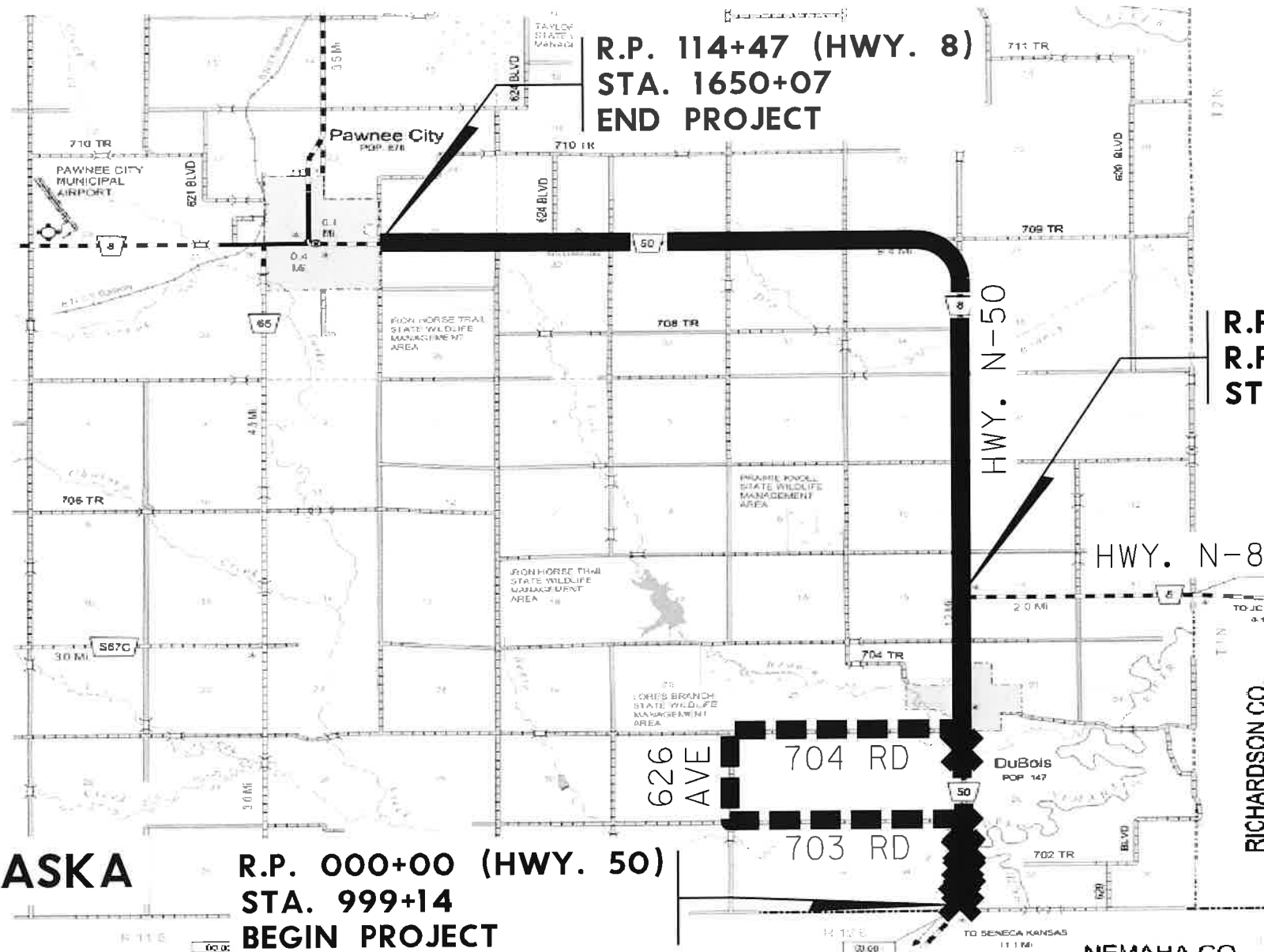

R.P. 114+47 (HWY. 8)  
STA. 1650+07  
END PROJECT

R.P. 123+39 (HWY. 8)  
R.P. 3+52 (HWY. 50)  
STA. 1184+66

NEBRASKA

R.P. 000+00 (HWY. 50)  
STA. 999+14  
BEGIN PROJECT

KANSAS

NEBRASKA

Good Life. Great Journey.  
DEPARTMENT OF TRANSPORTATION

50-1(117)  
C.N. 11895B

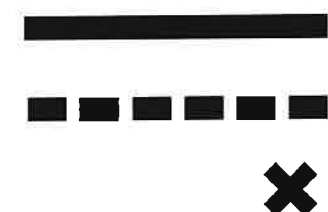

PROJECT  
LOCAL DETOUR  
CLOSED HIGHWAY LOCATIONS

# EXHIBIT "A"