

Automated Flagger Assistance Devices (AFADs)

The Nebraska Department of Transportation uses Automated Flagger Assistance Devices (AFADs) in work zones on two lane roadways. They improve work zone safety by keeping flaggers at a distance from the roadway to control traffic in a short-term closure.

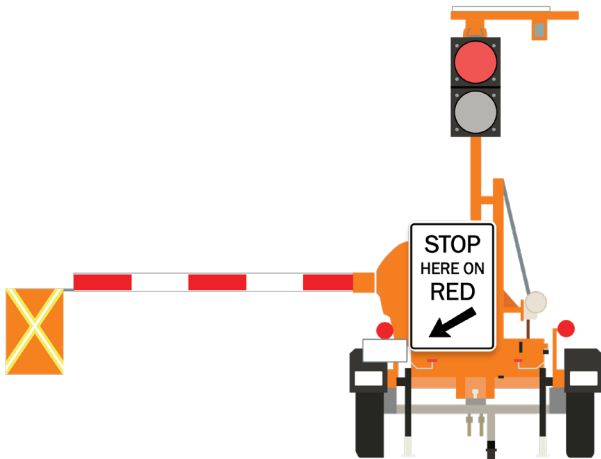

STOP

- Stop when the light is red and the arm is down.

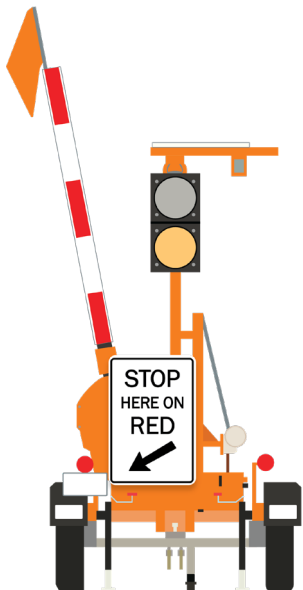

PROCEED

- Proceed with caution when the light is yellow and the arm has lifted.
- Follow a pilot car (if used) when yellow.

Don't go around the AFAD. You may put workers and other drivers at risk.